

CODE: W2-6  
 PAGE 1 OF 2  
 SIZE: 24" x 24"  
 MINIMUM

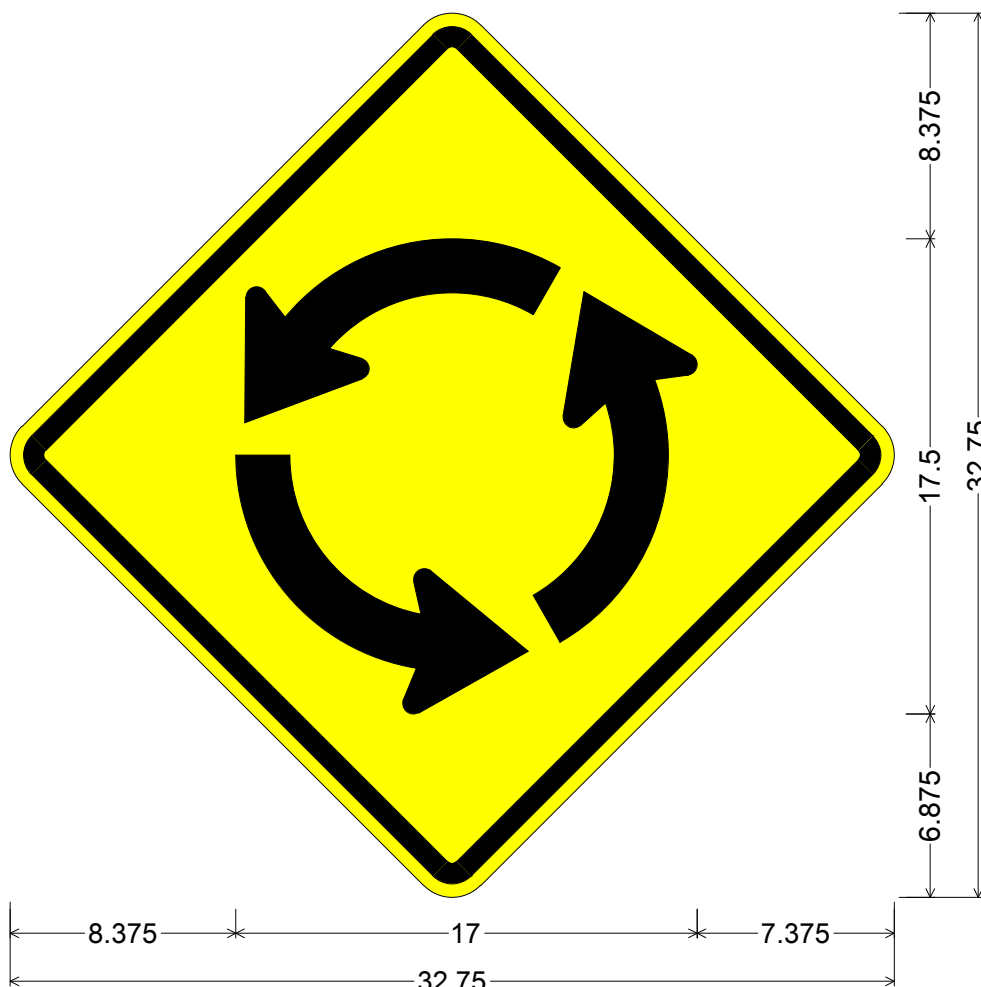

W02-06(24x24-MIN)YEL;  
 24.000" across sides 1.500" Radius, 0.750" Border, 0.500" Indent, Black on Yellow;  
 Circular Arrow Graphics - 2" Stroke;

ALL DIMENSIONS ARE IN INCHES



**COLORS:**  
 CIRCULAR ARROW GRAPHICS &  
 BORDER - BLACK (NON-REFL)  
 BACKGROUND - YELLOW (REFL)

ARIZONA DEPARTMENT OF TRANSPORTATION  
 TRAFFIC ENGINEERING GROUP

DRAWN: L. LOPEZ	DATE: MARCH / 2013
--------------------	-----------------------

APPROVED:  
 SIGNATURE ON FILE

CODE: W2-6  
 PAGE 1 OF 2  
 SIZE: 30" x 30"  
 STANDARD

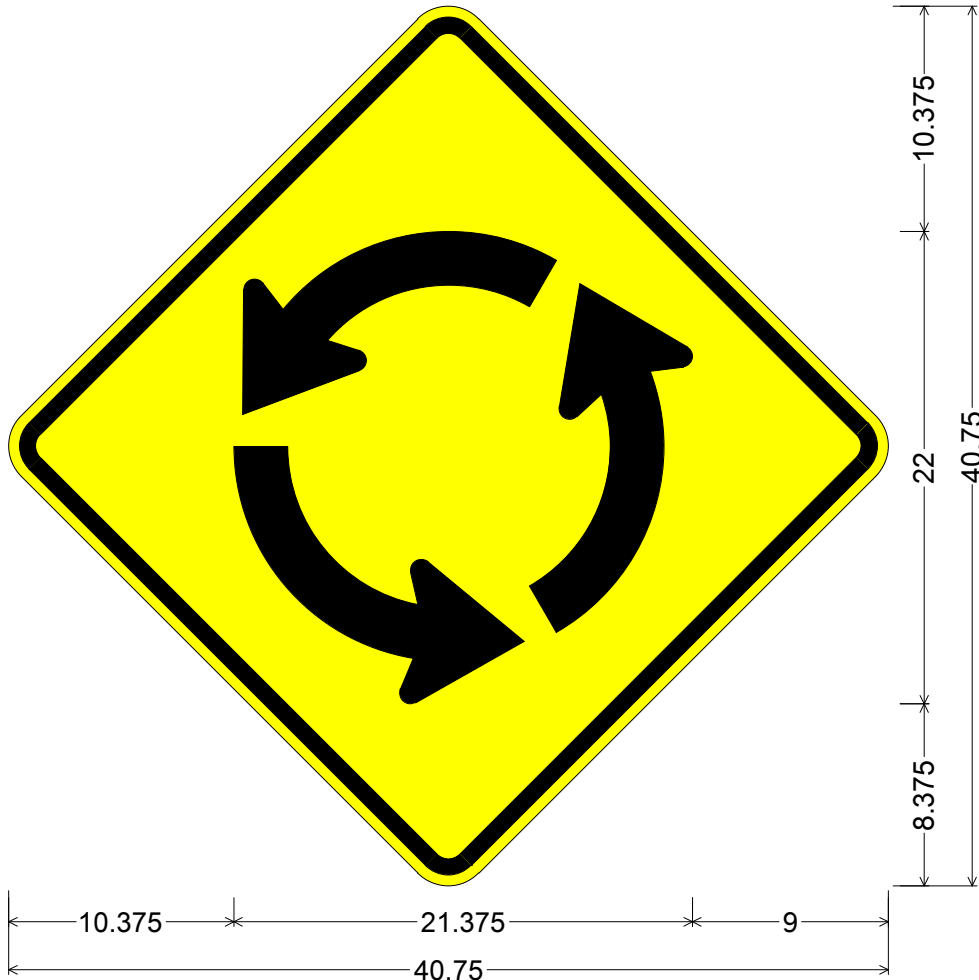

W02-06(30x30-STD)YEL;  
 30.000" across sides 2.000" Radius, 0.750" Border, 0.500" Indent, Black on Yellow;  
 Circular Arrow Graphics - 2.5" Stroke;

ALL DIMENSIONS ARE IN INCHES



**COLORS:**  
 CIRCULAR ARROW GRAPHICS &  
 BORDER - BLACK (NON-REFL)  
 BACKGROUND - YELLOW (REFL)

ARIZONA DEPARTMENT OF TRANSPORTATION  
 TRAFFIC ENGINEERING GROUP

DRAWN:  
 L. LOPEZ

DATE:  
 MARCH / 2013

APPROVED:  
 SIGNATURE ON FILE

CODE: W2-6  
 PAGE 1 OF 2  
 SIZE: 36" x 36"  
 EXPRESSWAY

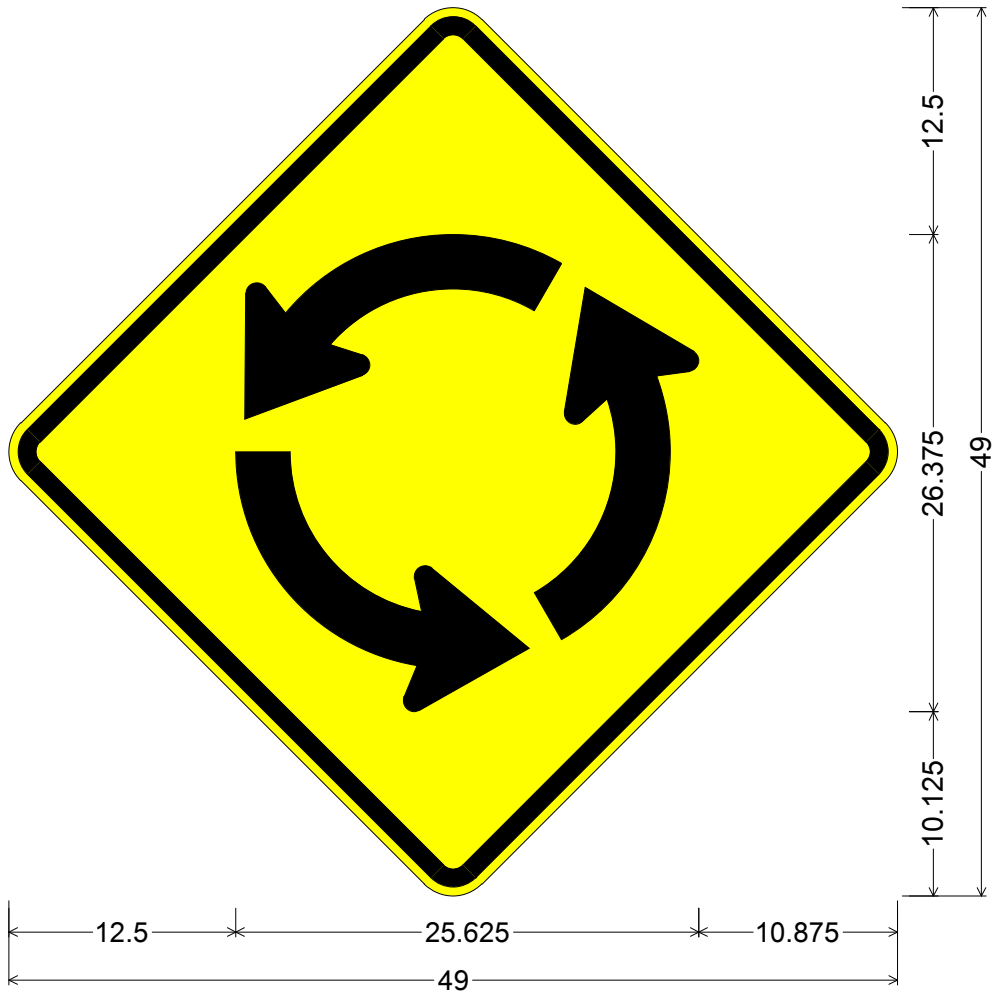

W02-06(36x36-EXPWY)YEL;  
 36.000" across sides 2.250" Radius, 1.000" Border, 0.500" Indent, Black on Yellow;  
 Circular Arrow Graphics - 3" Stroke;

ALL DIMENSIONS ARE IN INCHES



**COLORS:**  
 CIRCULAR ARROW GRAPHICS &  
 BORDER - BLACK (NON-REFL)  
 BACKGROUND - YELLOW (REFL)

ARIZONA DEPARTMENT OF TRANSPORTATION  
 TRAFFIC ENGINEERING GROUP

DRAWN:  
 L. LOPEZ

DATE:  
 MARCH / 2013

APPROVED:  
 SIGNATURE ON FILE

CODE: W2-6  
 PAGE 1 OF 2  
 SIZE: 48" x 48"  
 SPECIAL

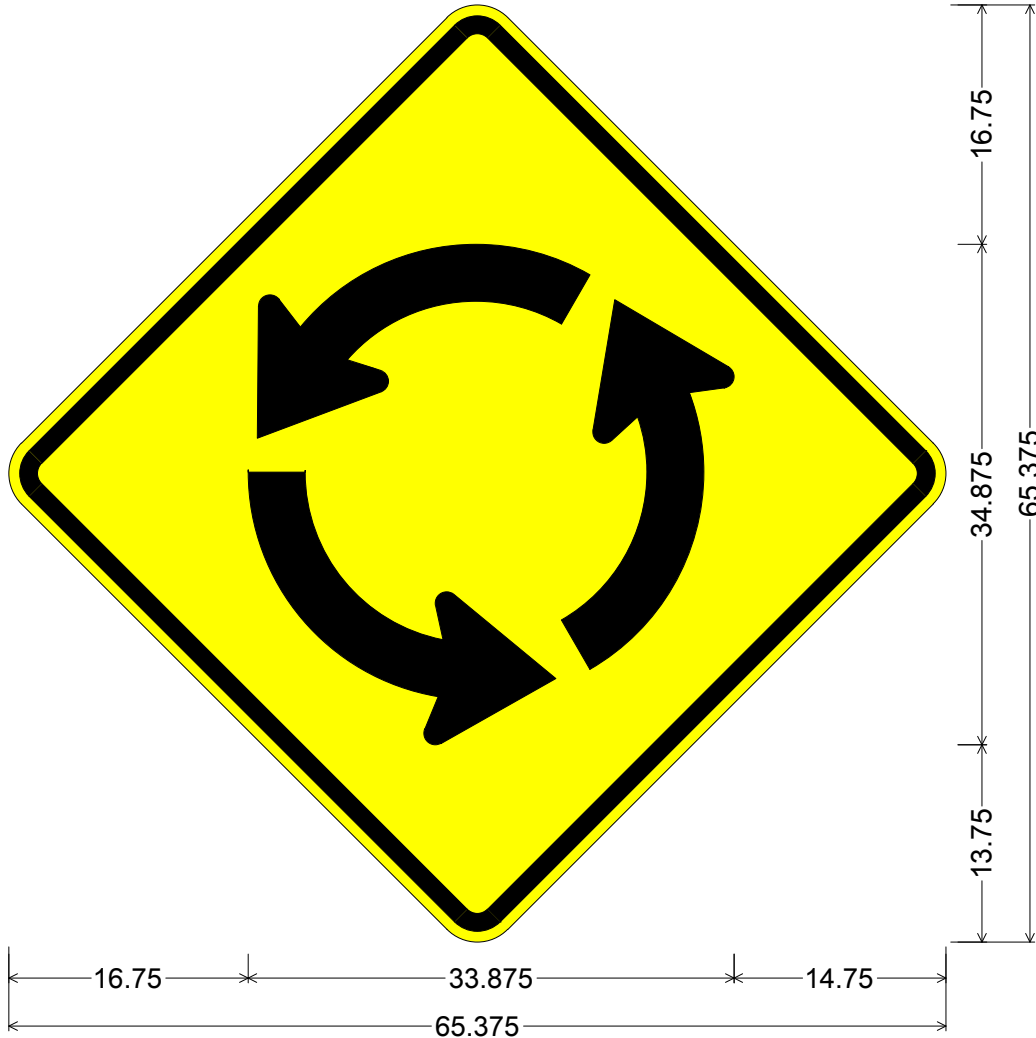

W02-06(48x48-FWY)YEL;  
 48.000" across sides 3.000" Radius, 1.250" Border, 0.750" Indent, Black on Yellow;  
 Circular Arrow Graphics - 4" Stroke;

ALL DIMENSIONS ARE IN INCHES



**COLORS:**

CIRCULAR ARROW GRAPHICS &  
 BORDER - BLACK (NON-REFL)  
 BACKGROUND - YELLOW (REFL)

ARIZONA DEPARTMENT OF TRANSPORTATION  
 TRAFFIC ENGINEERING GROUP

DRAWN:

L. LOPEZ

DATE:

MARCH / 2013

APPROVED:

SIGNATURE ON FILE

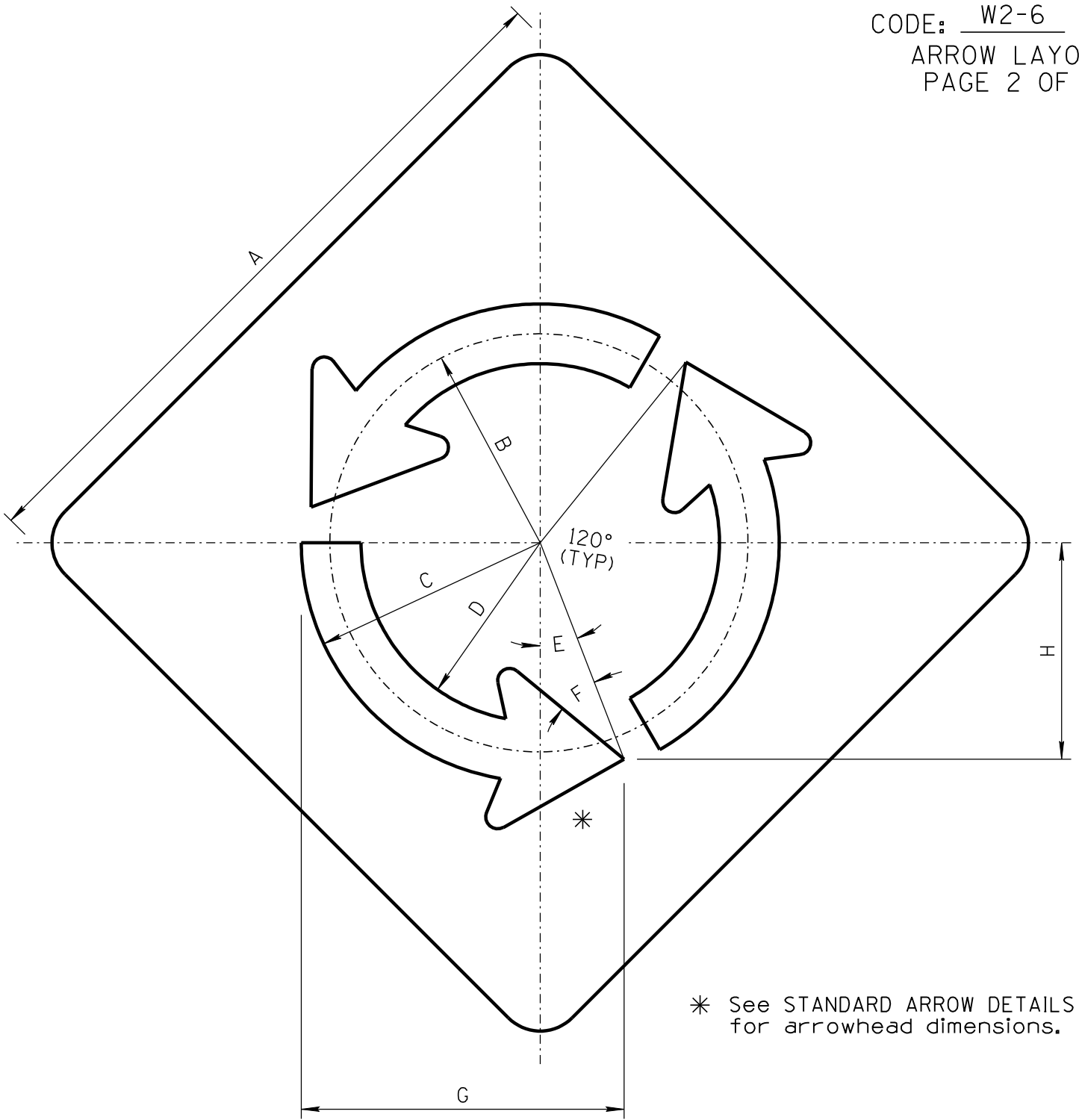

\* See STANDARD ARROW DETAILS for arrowhead dimensions.

W2-6  
 ARROW LAYOUT  
 BORDER AND INDENT  
 NOT SHOWN

A	B	C	D	E	F	G	H
24"	7"R	8"R	6"R	21.17°	29.31°	10.81"	7.25"
30"	8.75"R	10"R	7.5"R	21.24°	29.25°	13.47"	9.05"
36"	10.5"R	12"R	9"R	21.14°	29.35°	16.19"	10.85"
48"	14"R	16"R	12"R	20.96°	29.53°	21.48"	14.31"

ARIZONA DEPARTMENT OF TRANSPORTATION TRAFFIC ENGINEERING GROUP	
DRAWN: L. LOPEZ	DATE: MARCH/2013

# STANDARD ARROW DETAILS

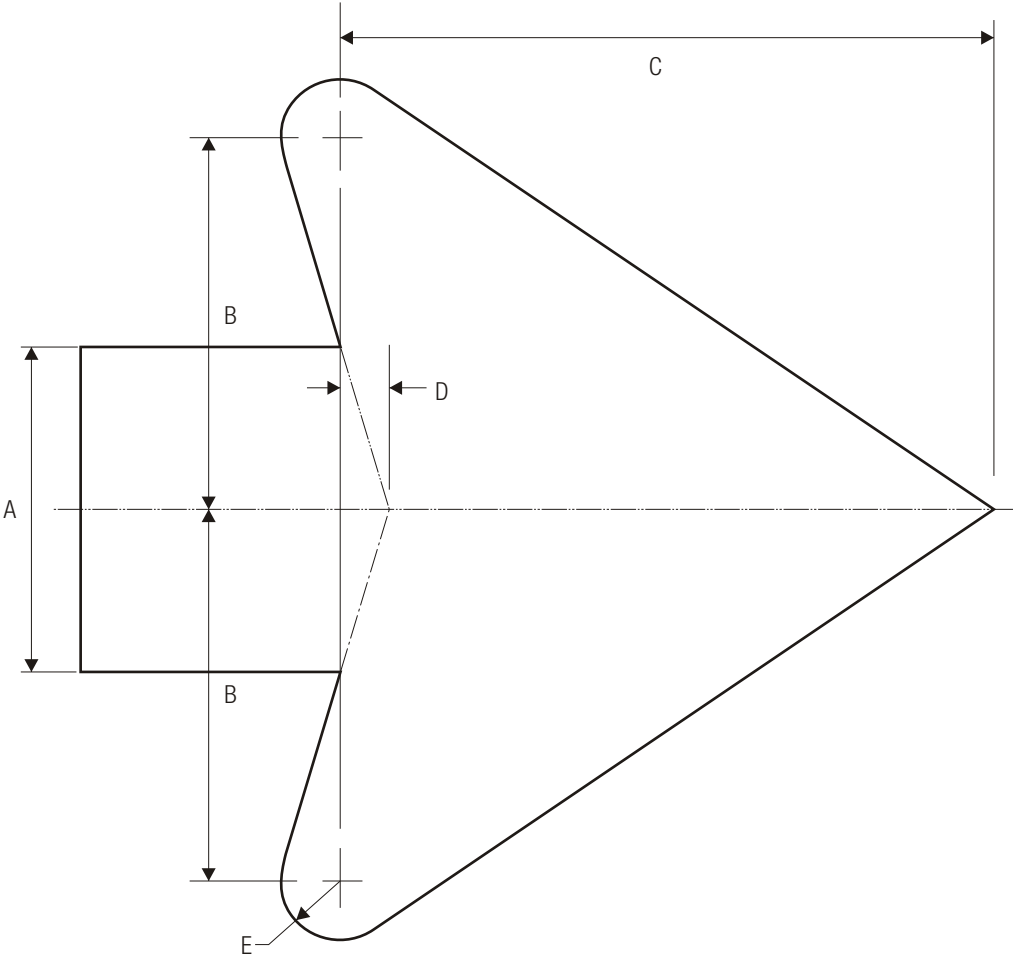

A	B	C	D	E
2	2.313	4.063	.313	.375
2.25	2.625	4.5	.375	.438
2.5	2.875	5.063	.375	.5
2.625	3	5.25	.375	.5
2.75	3	5.563	.438	.563
3	3.5	6.125	.438	.563
3.125	3.625	6.375	.5	.625
3.25	3.75	6.625	.5	.625
3.313	3.813	6.688	.5	.688
3.5	4	7.125	.563	.688
3.75	4.313	7.625	.563	.75
4	4.625	8.125	.625	.813
4.063	4.75	8.25	.625	.813
4.25	4.875	8.625	.625	.813
4.375	5	8.875	.688	.875
4.5	5.188	9.125	.688	.875

A	B	C	D	E
4.75	5.438	9.625	.75	1
4.875	5.625	9.875	.75	1
5	5.75	10.125	.75	1
5.25	6	10.625	.813	1.063
5.5	6.375	11.125	.875	1.125
5.75	6.625	11.688	.875	1.125
6	6.875	12.188	.938	1.188
6.5	7.5	13.188	1	1.625
7	8	14.188	1.063	1.375
7.5	8.625	15.188	1.125	1.5
8	9.188	16.25	1.25	1.625