



R6-2R
ONE WAY

*Series 2000 Standard Alphabets.
**See page 6-2 for arrow design.

C

A	B	C	D	E	F	G	H	J	K	L	M
12	16	.375	.375	2	3 D	1.5	3	3.5	3.722	3.664	3.717
18	24	.375	.625	2.5	5 D	1.5	4.5	5.5	6.244	6.124	6.044
24	30	.375	.625	3	6 D	1.875	6.063	7.063	7.485	7.285	7.325
36	48	.625	.875	4.75	10 D	3.25	9.5	10.5	12.369	12.249	12
48	60	.75	1.25	6	12 D	4	12	14	15	14.571	14.811

N	P	Q	R	S
3.943	3.75	4	1.5	1.5
6.805	6	6.805	2.25	1.5
8.286	8.286	8.926	3	1.5
13.530	13.250	14.290	5	2.25
16.252	16.572	17.853	6	3

COLORS: LEGEND — BLACK
BACKGROUND — WHITE (RETROREFLECTIVE)

CODE: R6-2R
 SIZE: 30" x 36"
 MULTI-LANE

R6-2L: arrow faces to left

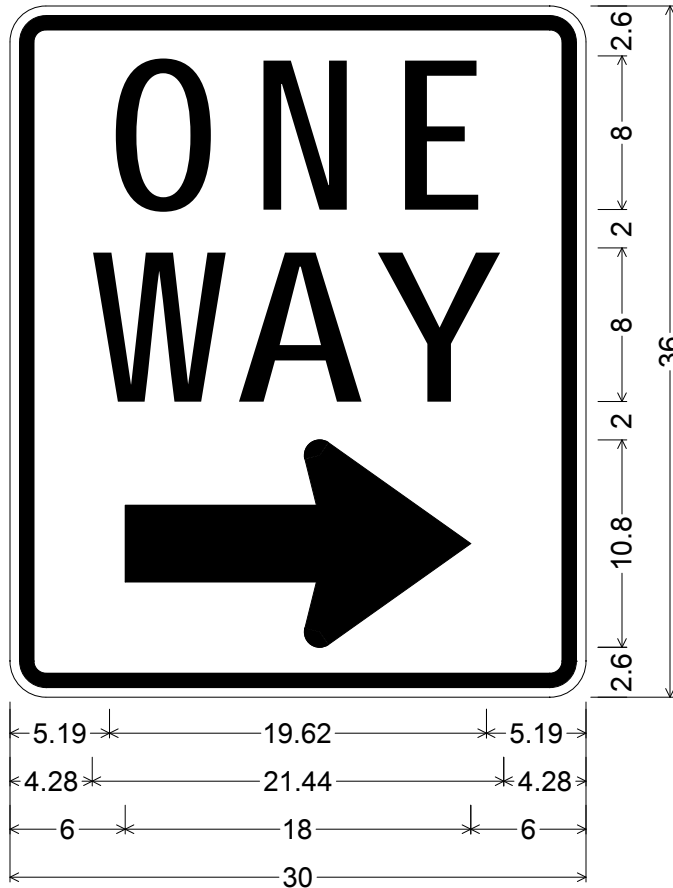

R6-002R(30x36-MUL)WHT;
 1.88" Radius, 0.75" Border, 0.50" Indent, Black on White;
 "ONE" D; "WAY" D;
 Standard Arrow Custom 18.00" X 10.80" 0°;

ALL DIMENSIONS ARE IN INCHES



COLORS:
 LEGEND & BORDER - BLACK (NON-REFL)
 BACKGROUND - WHITE (REFL)

ARIZONA DEPARTMENT OF TRANSPORTATION
 TRAFFIC ENGINEERING GROUP

DRAWN: R. C. MOEUR	DATE: APRIL / 2014
-----------------------	-----------------------

APPROVED:
SIGNATURE ON FILE

STANDARD ARROW DETAILS

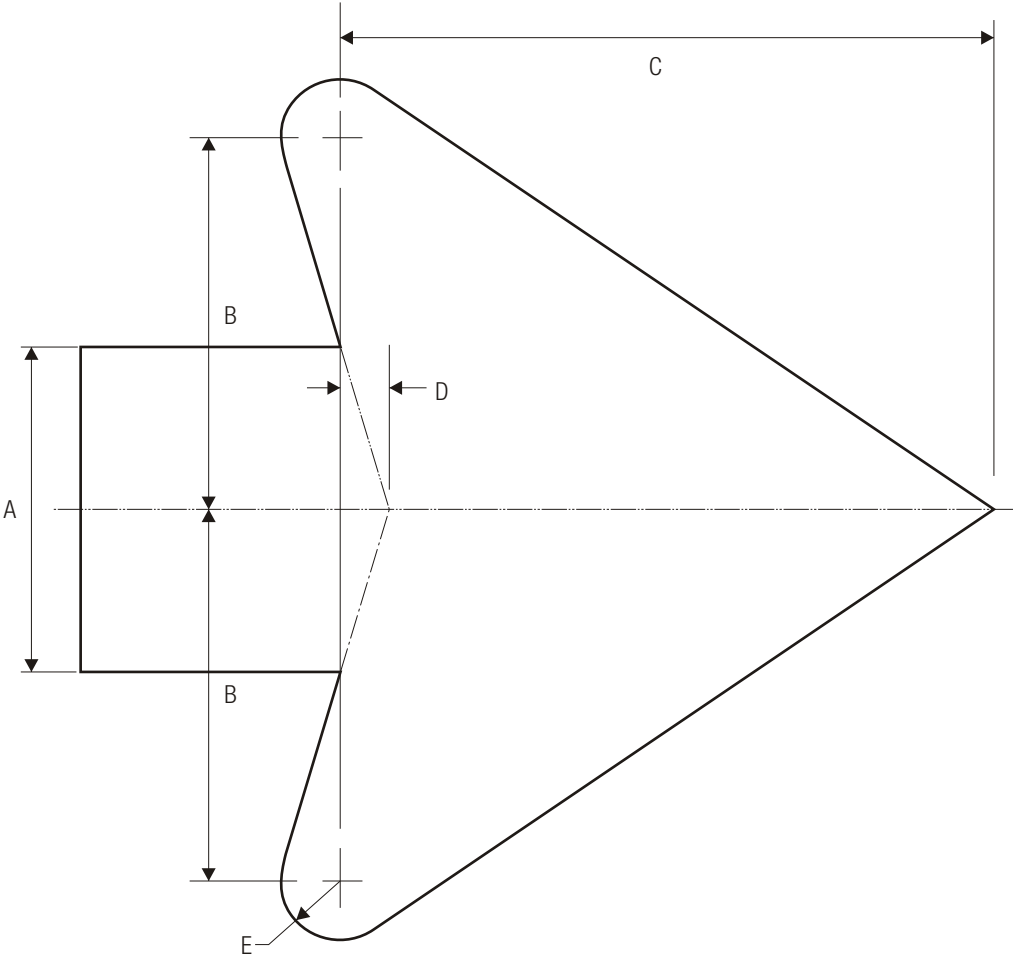

A	B	C	D	E
2	2.313	4.063	.313	.375
2.25	2.625	4.5	.375	.438
2.5	2.875	5.063	.375	.5
2.625	3	5.25	.375	.5
2.75	3	5.563	.438	.563
3	3.5	6.125	.438	.563
3.125	3.625	6.375	.5	.625
3.25	3.75	6.625	.5	.625
3.313	3.813	6.688	.5	.688
3.5	4	7.125	.563	.688
3.75	4.313	7.625	.563	.75
4	4.625	8.125	.625	.813
4.063	4.75	8.25	.625	.813
4.25	4.875	8.625	.625	.813
4.375	5	8.875	.688	.875
4.5	5.188	9.125	.688	.875

A	B	C	D	E
4.75	5.438	9.625	.75	1
4.875	5.625	9.875	.75	1
5	5.75	10.125	.75	1
5.25	6	10.625	.813	1.063
5.5	6.375	11.125	.875	1.125
5.75	6.625	11.688	.875	1.125
6	6.875	12.188	.938	1.188
6.5	7.5	13.188	1	1.625
7	8	14.188	1.063	1.375
7.5	8.625	15.188	1.125	1.5
8	9.188	16.25	1.25	1.625