

CODE: R1-5cL
 SIZE: 36" x 48"
 STANDARD



R01-05cL(36x48-STD)WHT;
 2.250" Radius, 0.875" Border, 0.625" Indent, Black on White;
 Stop Sign; "HERE" C; Arrow-Left; "FOR" C;
 "PEDESTRIANS" C specified length;

ALL DIMENSIONS ARE IN INCHES



COLORS:

- LEGEND & BORDER - BLACK (NON-REFL)
- STOP SYMBOL - RED (REFL)
- ARROW - BLACK (NON-REFL)
- BACKGROUND - WHITE (REFL)

ARIZONA DEPARTMENT OF TRANSPORTATION
 TRAFFIC ENGINEERING GROUP

DRAWN:

L. LOPEZ

DATE:

OCTOBER / 2012

APPROVED:

SIGNATURE ON FILE

CODE: R1-5cR

SIZE: 36" x 48"
STANDARD



R01-05cR(36x48-STD)WHT;

2.250" Radius, 0.875" Border, 0.625" Indent, Black on White;

Stop Sign; "HERE" C; Arrow-Right; "FOR" C;

"PEDESTRIANS" C specified length;

ALL DIMENSIONS ARE IN INCHES



COLORS:

LEGEND & BORDER - BLACK (NON-REFL)
YIELD SYMBOL - RED (REFL)
ARROW - BLACK (NON-REFL)
BACKGROUND - WHITE (REFL)

ARIZONA DEPARTMENT OF TRANSPORTATION
TRAFFIC ENGINEERING GROUP

DRAWN:

L. LOPEZ

DATE:

OCTOBER / 2012

APPROVED:

SIGNATURE ON FILE

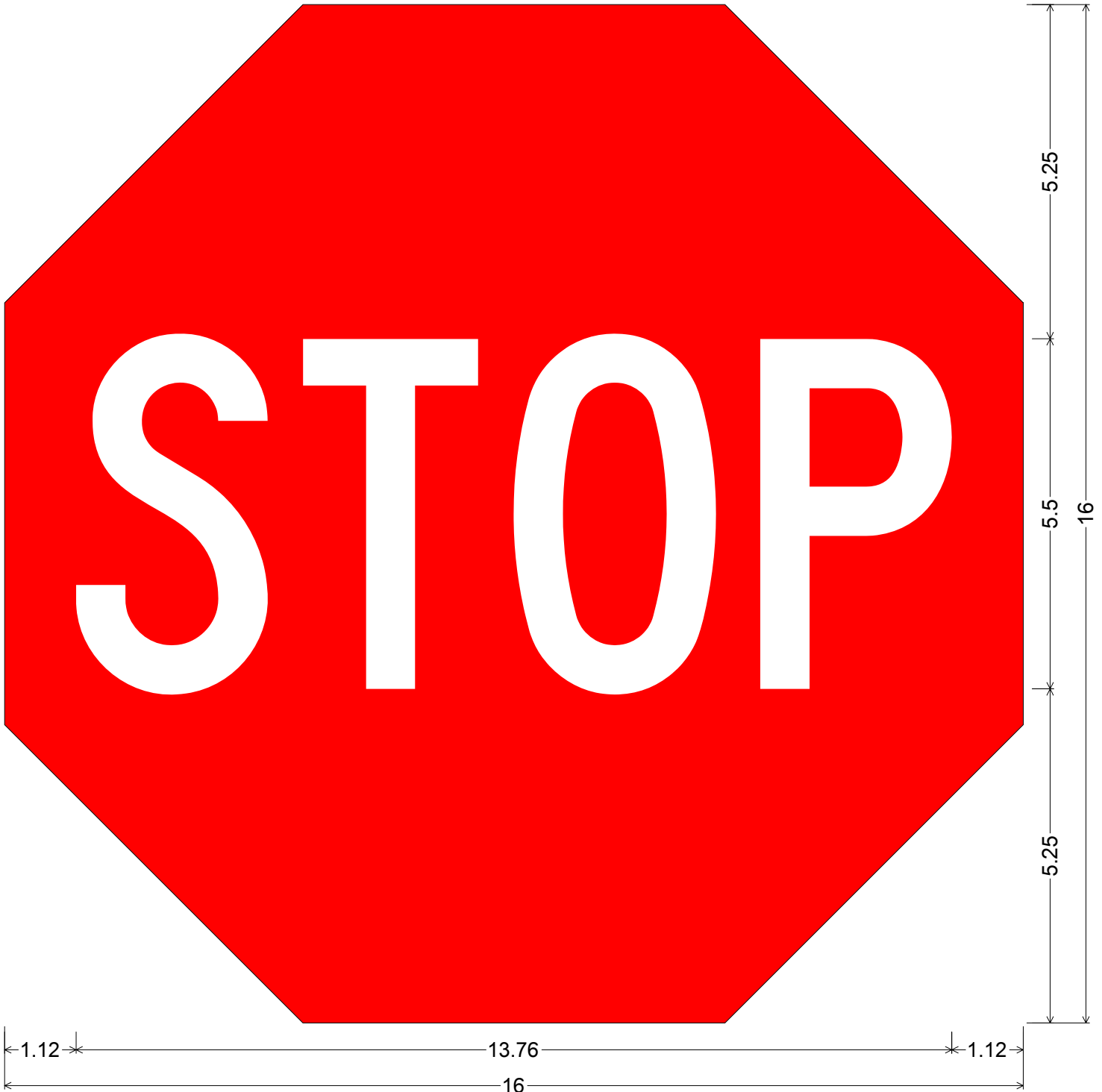

R1-1 (for use on R1-5c); No border, Red;
"STOP" White C 60% spacing;

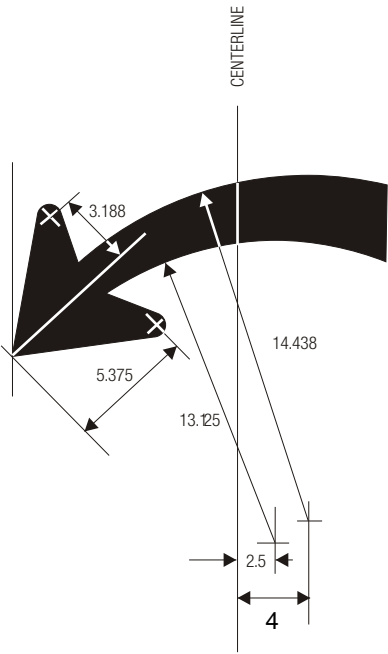

STANDARD ARROW DETAILS

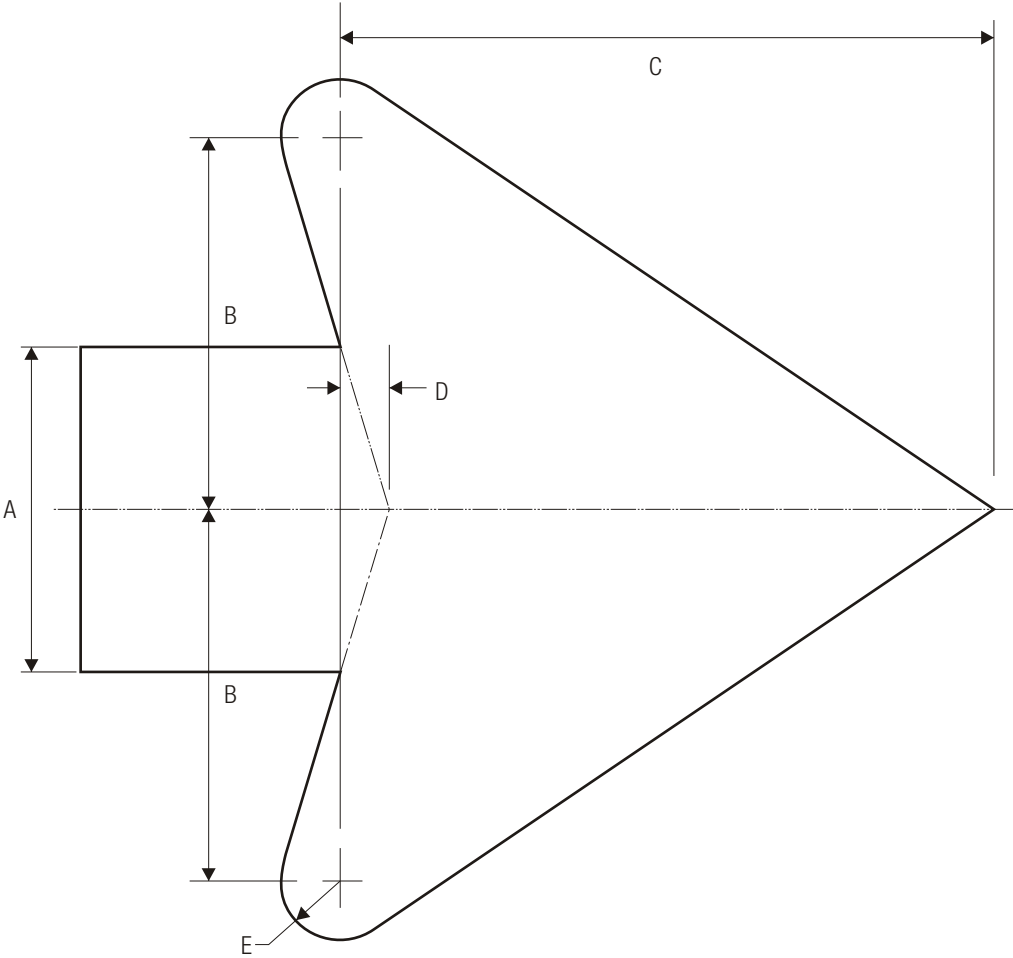

A	B	C	D	E
2	2.313	4.063	.313	.375
2.25	2.625	4.5	.375	.438
2.5	2.875	5.063	.375	.5
2.625	3	5.25	.375	.5
2.75	3	5.563	.438	.563
3	3.5	6.125	.438	.563
3.125	3.625	6.375	.5	.625
3.25	3.75	6.625	.5	.625
3.313	3.813	6.688	.5	.688
3.5	4	7.125	.563	.688
3.75	4.313	7.625	.563	.75
4	4.625	8.125	.625	.813
4.063	4.75	8.25	.625	.813
4.25	4.875	8.625	.625	.813
4.375	5	8.875	.688	.875
4.5	5.188	9.125	.688	.875

A	B	C	D	E
4.75	5.438	9.625	.75	1
4.875	5.625	9.875	.75	1
5	5.75	10.125	.75	1
5.25	6	10.625	.813	1.063
5.5	6.375	11.125	.875	1.125
5.75	6.625	11.688	.875	1.125
6	6.875	12.188	.938	1.188
6.5	7.5	13.188	1	1.625
7	8	14.188	1.063	1.375
7.5	8.625	15.188	1.125	1.5
8	9.188	16.25	1.25	1.625

