

10
9
8
7
6
5
4
3
2
1

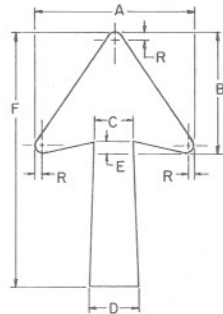

CROSS ROAD &
MAINLINE
ARROW DETAILS

"A" VERTICAL OR DIAGONAL ARROW

Letter size	Arrow dimensions in inches						
	A	B	C	D	E	F	R
10.67" U.C. — 8" Cap	15 1/8	11 9/16	3 3/4	5	1 5/16	24 1/4	13 1/16
13 1/3" U.C., 10"-12" Cap	18 1/4	14	4 1/2	6	1 1/2	29 1/4	3/4
16" U.C.	22 1/4	17	5 3/8	7 1/8	1 3/4	35 5/8	1

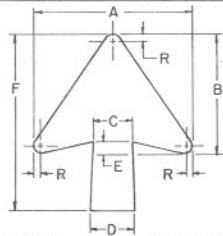

"B" VERTICAL OR DIAGONAL ARROW

Letter size	Arrow dimensions in inches						
	A	B	C	D	E	F	R
8"-10" Cap	14 1/2	11 3/16	3 3/4	4 3/8	1 3/16	17 1/4	13 1/16
13 1/3" U.C., 12" Cap	17 1/2	14	4 1/2	5 1/4	1 1/2	20 1/4	3/4
16" U.C.	21 7/8	17	5 3/8	6 1/4	1 3/4	25	1

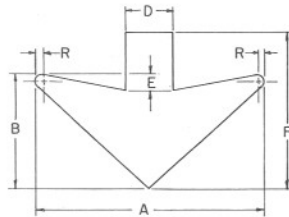

"C" VERTICAL DOWN ARROW

Letter size	Arrow dimensions in inches					
	A	B	D	E	F	R
16" U.C.	32	16	6 1/2	3	22	1
10.67" U.C.	24	12	5	2 1/4	16 1/2	3/4

CROSS ROAD
ARROW DETAILS

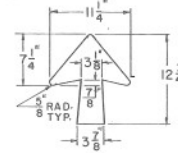

ONE LINE HORIZONTAL, VERTICAL OR
DIAGONAL ARROW
(For 8" U.C. & 6" L.C.)

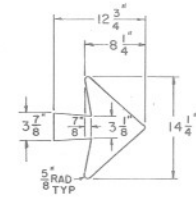

TWO LINE HORIZONTAL ARROW
(For 8" U.C. & 6" L.C.)

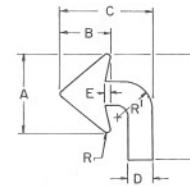

ADVANCE LEFT ARROW

Letter size	Arrow dimensions in inches						
	A	B	C	D	E	F	R
8" U.C.	11 1/4	7 1/4	13	3 1/2	7 7/8	15	5/8
10.67" U.C.	15 1/8	11 9/16	20	4 3/8	11 5/16	23	13/16

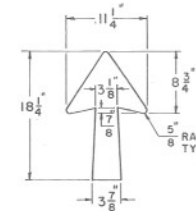

TWO LINE VERTICAL OR DIAGONAL ARROW
(For 8" U.C. & 6" U.C.)

DESIGN APPROVED

Barbara Brown
6/14/99

APPROVED FOR DISTRIBUTION

F. J. Spalding

STATE OF ARIZONA
DEPARTMENT OF TRANSPORTATION
DIVISION OF HIGHWAYS
STANDARD DRAWINGS

REV.

5-89

ARROW FORMAT DETAILS

DRAWING NO.

4-S-2.08