

TANDEM PARALLEL PARKING DETAIL

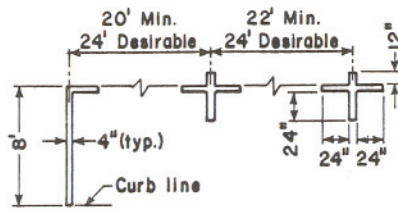

STANDARD PARALLEL PARKING DETAIL

NOTES:

1. Number and location of crosswalks at an intersection may vary as directed by the Traffic Engineer.
2. Stop bar shall be 12" to 24" as directed by the Traffic Engineer. Place in line with the stop sign or at the desired stopping point.
3. To be installed only when directed by the Traffic Engineer.
4. Tandem parking to be installed only when directed by the Traffic Engineer.
5. Red curb marking indicates parking prohibition; Green curb marking indicates time limit restriction; Yellow curb marking indicates loading zone restriction.

DO NOT SCALE

DESIGN APPROVED <i>[Signature]</i>	STATE OF ARIZONA DEPARTMENT OF TRANSPORTATION DIVISION OF HIGHWAYS STANDARD DRAWINGS	REV. 8-77 10-82 7-83
APPROVED FOR DISTRIBUTION <i>[Signature]</i>	PAVEMENT MARKINGS FOR CROSSWALKS, PARKING AND INTERSECTIONS	DRAWING NO. 4-M-101