

NO.	DESCRIPTION OF REVISIONS	DATE	MADE BY
1	RE-ISSUE	2/02	L. LOPEZ
2	CHANGED TEXT CASE, UPDATED BORDER, REVISED DRAWING, CALLOUTS & NOTES.	6/14	D.S. & L.L.

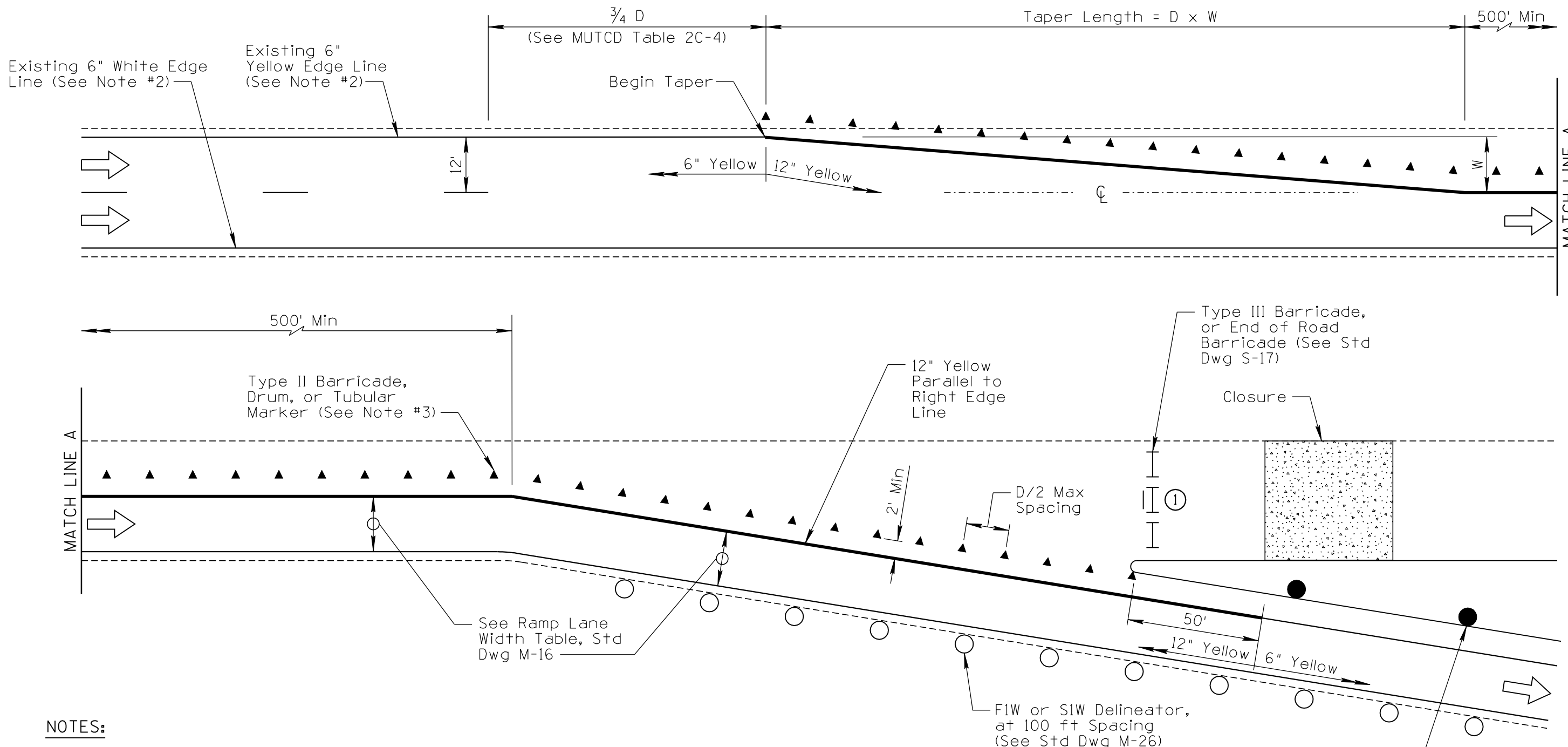

**NOTES:**

1. Where roadway conditions do not permit the use of this treatment, alternate treatment shall be as directed by the Engineer.
2. Where there is no existing edge line, taper to edge of paved shoulder.
3. Use portable guardrail or concrete barrier where specified by the Engineer.
4. The speed used for D and the taper may be the design speed, posted speed in advance of the closure, or as determined by the Engineer.

**SIGN LEGEND:**

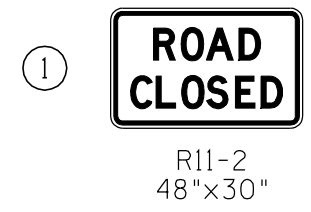

F1Y or S1Y Delineator at 200 ft Spacing Max, (See Std Dwg M-26)

NOT TO SCALE

DESIGN APPROVED	ARIZONA DEPARTMENT OF TRANSPORTATION INTERMODAL TRANSPORTATION DIVISION TRAFFIC SIGNING & MARKING STANDARD DRAWINGS	REVISION 6/14
<b>SIGNATURES</b>		DRAWING NO. M-3
APPROVED FOR DISTRIBUTION	STRIPING AND DELINEATION FOR FREEWAY TERMINALS	SHEET NO. 1 of 1
<b>ON FILE</b>		