

NO	DESCRIPTION OF REVISIONS	MADE BY	DATE
1	RE-ISSUE	L. LOPEZ	2/02
2	UPDATED	L. LOPEZ	5/03
3	ADDED SIGN CODE CALLOUTS	L. LOPEZ	5/04
4			

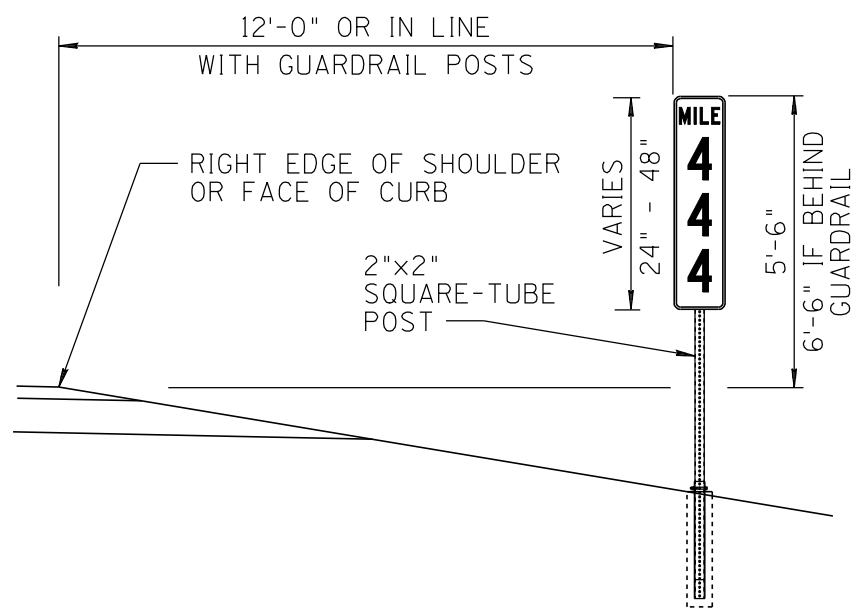

TYPICAL MILEPOST INSTALLATION

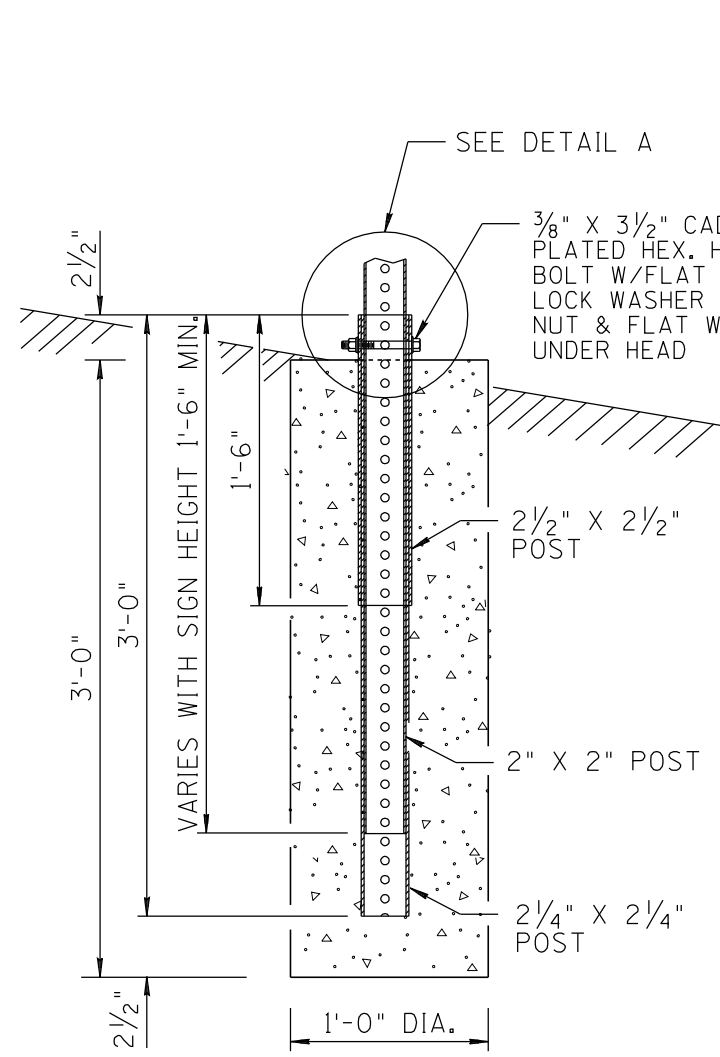
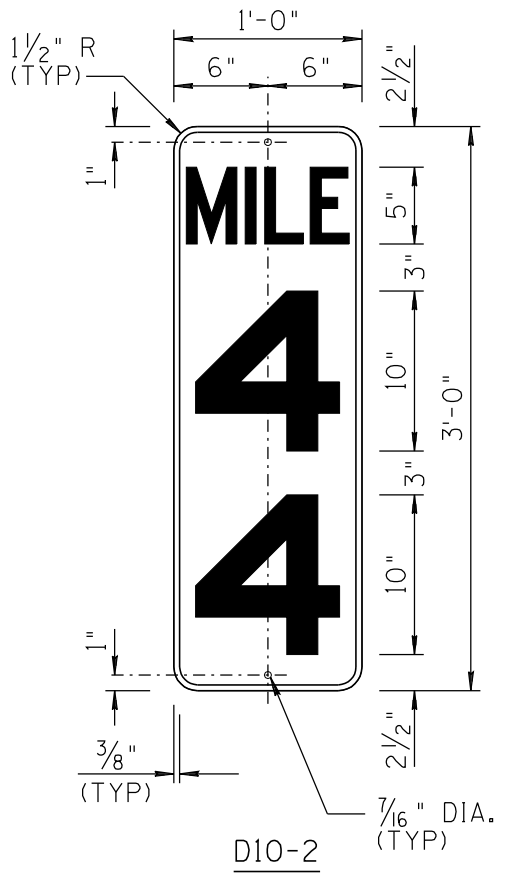
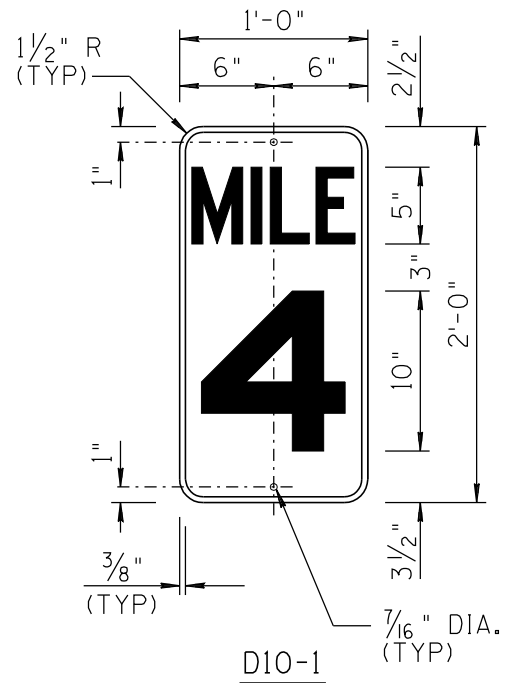

FOUNDATION DETAILS

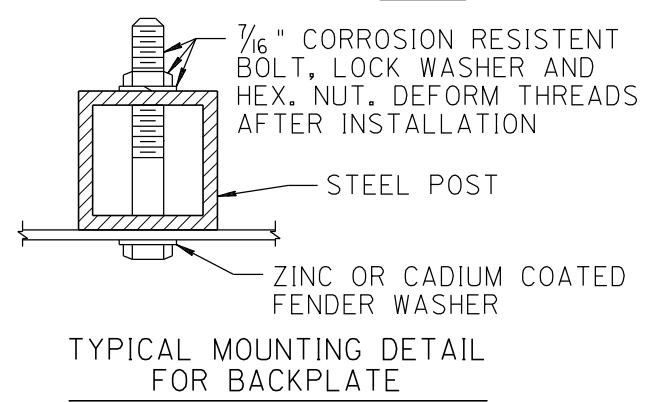
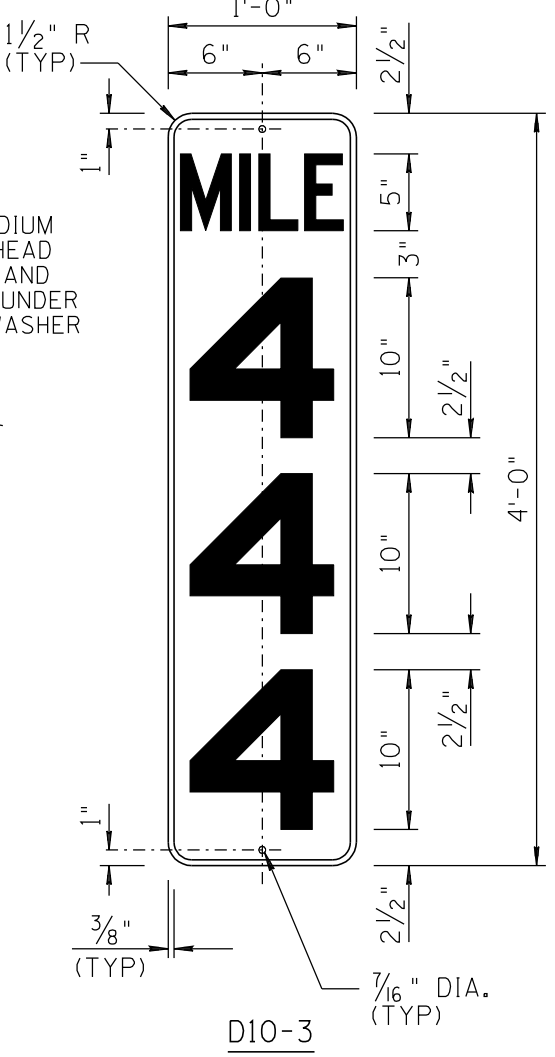

TYPICAL MOUNTING DETAIL FOR BACKPLATE

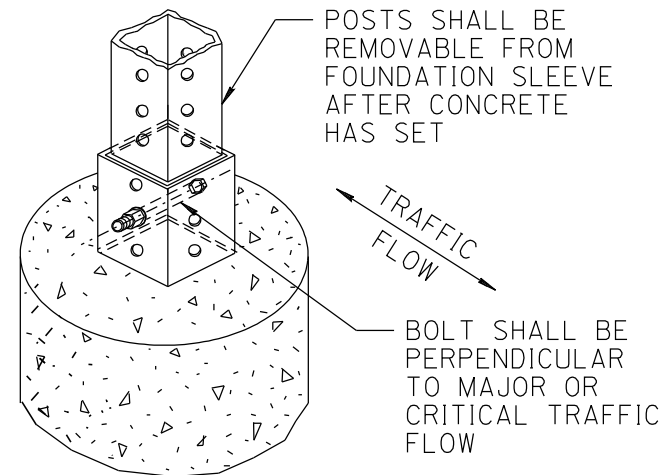

DETAIL A

NOTES:

- MILEPOSTS SHALL BE PLACED ON THE RIGHT SIDE OF THE ROADWAY FACING APPROACHING TRAFFIC. IF THEY CANNOT BE PLACED WITHIN 100 FOOT ACCURACY, THEY SHALL BE OMITTED.
- ANY NEW MILEPOST SHALL BE INSTALLED IN THE SAME LONGITUDINAL LOCATION AS THE CORRESPONDING EXISTING MILEPOST.
- MILEPOST PLATES SHALL BE FABRICATED FROM 0.125" THICK 3003-H14, 5052-H38, OR 6061-T6 ALUMINUM.
- ALL SURFACES COVERED WITH REFLECTIVE SHEETING SHALL BE PREPARED IN ACCORDANCE WITH THE RECOMMENDATIONS OF THE SHEETING MANUFACTURER. SHEETING SHALL CONFIRM TO SECTION 1007 OF THE STANDARD SPECIFICATIONS. PANEL SURFACES NOT COVERED WITH SHEETING SHALL BE ETCHED TO REDUCE GLARE FROM REFLECTED SUNLIGHT.
- POSTS SHALL BE PERFORATED SQUARE-TUBE, FORMED FROM 0.105" ASTM A-366 COLD ROLLED CARBON STEEL. THE SQUARE TUBES SHALL BE WELDED DIRECTLY IN THE CORNERS BY HIGH-FREQUENCY RESISTANCE WELDING OR EQUAL. POSTS SHALL BE EXTERNALLY SCARIFIED TO CONFORM TO STANDARD CORNER RADII OF 7/16" AND SHALL BE GALVANIZED TO CONFORM TO THE REQUIREMENTS OF ASTM A-525 COATING DESIGN G-90.
- PANELS SHALL BE ATTACHED TO POSTS USING 7/16" HEX-HEAD BOLTS WITH HEX NUT, FLAT WASHER, LOCK WASHER, AND ZINC OR CADMIUM COATED FENDER WASHER. FACE OF BOLT AND ZINC OR CADMIUM COATED FENDER PANEL SHALL BE THE SAME COLOR AS THE MILEPOST PANEL. THE MAXIMUM OUTSIDE DIAMETER OF ALL WASHERS SHALL BE 7/8".
- ALL HARDWARE SHALL CONFORM TO THE REQUIREMENTS OF ASTM A-307, CLASS A, AND SECTION 607-2.03 OF THE STANDARD SPECIFICATIONS.
- CONCRETE SHALL BE f'c = 2500 PSI OR STRONGER AND FINISHED FLAT.
- THE WORD "MILE" SHALL BE 5 INCH SERIES "C" AT 50% SPACING. NUMERALS SHALL BE AT 10 INCH SERIES "E" MODIFIED, PER THE FEDERAL HIGHWAY SIGN MANUAL. NUMERALS AND WORDS SHALL BE OPTICALLY SPACED ABOUT THE VERTICAL CENTERLINE.
- THE BORDER AND LEGEND SHALL BE WHITE. THE BACKGROUND SHALL BE GREEN AND MAY BE REVERSE SILK-SCREENED. SHEETING SHALL CONFIRM TO SECTION 1007 OF THE STANDARD SPECIFICATION.

SHEET 1 OF 2
NOT TO SCALE

DESIGN APPROVED	ARIZONA DEPARTMENT OF TRANSPORTATION INTERMODAL TRANSPORTATION DIVISION STANDARD DRAWINGS	REV. 5/04
APPROVED FOR DISTRIBUTION	FREEWAY MILEPOST DETAILS	DRAWING NO. S-10