

NO	DESCRIPTION OF REVISIONS	MADE BY	DATE
1	RE-ISSUE	L. LOPEZ	2/02
2			
3			
4			

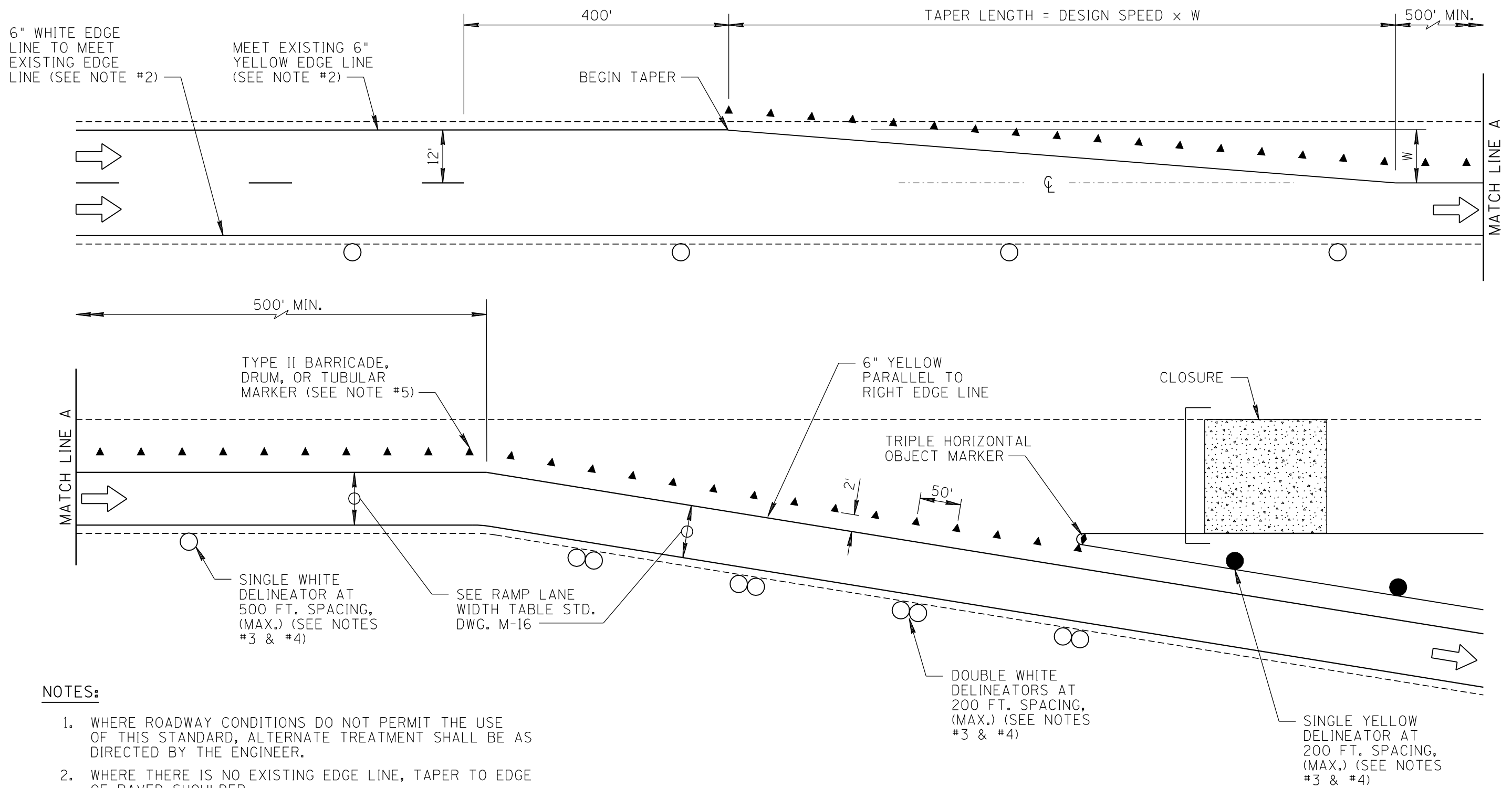

NOTES:

- WHERE ROADWAY CONDITIONS DO NOT PERMIT THE USE OF THIS STANDARD, ALTERNATE TREATMENT SHALL BE AS DIRECTED BY THE ENGINEER.
- WHERE THERE IS NO EXISTING EDGE LINE, TAPER TO EDGE OF PAVED SHOULDER.
- DELINEATORS SHALL BE SPACED BY THE SPACING TABLE SHOWN ON STANDARD DRAWINGS M-26.
- WHERE ADDITIONAL DELINEATION IS NECESSARY, PLACE REQUIRED DELINEATORS MID-WAY BETWEEN NORMALLY SPACED DELINEATORS.
- USE PORTABLE GUARDRAIL OR CONCRETE BARRIER WHEN SPECIFIED BY THE ENGINEER.

NOT TO SCALE

DESIGN APPROVED	ARIZONA DEPARTMENT OF TRANSPORTATION INTERMODAL TRANSPORTATION DIVISION STANDARD DRAWINGS	REV.
APPROVED FOR DISTRIBUTION		2/02
STRIPING AND DELINEATION FOR FREEWAY TERMINALS		DRAWING NO. M-3