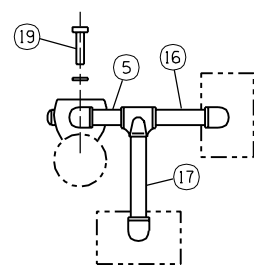
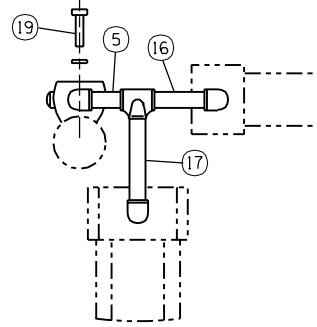

TABLE TO BE USED FOR FINDING NIPPLE LENGTH. (ITEM 12)

SIGNAL FACES COMBINATION	NIPPLE LENGTH (ITEM 12)					
	C	Q	F/R	M	H	G
C	0	40 1/2"	13 1/2"	13 1/2"	27"	27"
Q	40 1/2"	0	27"	27"	13 1/2"	13 1/2"
F/R	13 1/2"	27"	0	0	13 1/2"	13 1/2"
M	13 1/2"	27"	0	0	13 1/2"	13 1/2"
H	27"	13 1/2"	13 1/2"	13 1/2"	0	0
G	27"	13 1/2"	13 1/2"	13 1/2"	0	0

Signal Face	NIPPLE LENGTH (ITEM 3)					
	C	Q	F/R	M	H	G
Nipple Length	21"	61 1/2"	34 1/2"	34 1/2"	48"	48"

Threads On One End Only.



**MOUNTING ORIENTATION PLANS**

Fixed Direction Of Bracket Arms Predetermined At Site. Direction Of Signal Heads To Be Determined By Engineer.

**LIST OF MATERIALS**

Item	Qty.	Description
1	1	Terminal Compartment For Side Mounting. (T.S. 10-4-1)
2	1	Ornamental Cap. (See T.S. 10-1-6)
3	1	1/2" Pipe, See Table.
4	1	1/2" 90° Elbow, Drill & Tap For Setscrew.
5	1	1/2" I.D. Pipe Nipple, 12 1/2" Long.
6	1	1/2" Pipe Tee.
7	2	90° Elbow.
8	2	Flat Washer.
9	2	Neoprene Washer.
10	1	1/2" I.D. Pipe Nipple, 12" Long.
11	4	1/2" Lock Nipple, See Note No. 1.
12	1	1/2" I.D. Pipe Nipple, See Table.
13	1	1/2" Coupling, As Required.
14	2	Signal Head, See Plans.
15	2	90° Elbow With Locking Device. (T.S. 10-1-2)
16	2	1/2" I.D. Pipe Nipple, 12" Long.
17	2	1/2" I.D. Pipe Nipple, 12" Long.
* 18	1	1/2" I.D. Pipe Nipple, 9 1/2" Long For Ped. Signal, Only.
19	2	1/2" x 2" Galvanized Steel Bolt 13-UNC With Flat Washer And Lock Washer.
20	1	Conduit Lock Nut. (For "F", "M" & "R" Combination Only.)
21	1	1/2" I.D. Pipe Nipple, 3" Long. (For "F", "M" & "R" Combination Only.)
22	1	Malleable Hex Nut (For "F", "M" & "R" Combination Only.)

\* Special Nipple Length For Use Only With Ped. Signal Single Head Units.



**PLAN SYMBOLS**

**NOTES:**

- Lock Nipple Length shall be 1/8" for 8" Heads and 1/4" for 12" Heads.
- For Pole Drilling Detail See T.S. 4-21.

DESIGN APPROVED

**SIGNATURE**

ARIZONA DEPT. OF TRANSPORTATION  
INTERMODAL TRANSPORTATION DIVISION  
TRAFFIC SIGNALS & LIGHTING  
STANDARD DRAWINGS

APPROVED FOR DISTRIBUTION

**ON FILE**

TYPE VIII  
MOUNTING ASSEMBLY

DRAWING NO.

T.S. 9-6