

NO. 1 2010 EDITION  
 DESCRIPTION OF REVISIONS  
 MADE BY C. COLE  
 DATE 03/10  
 NO. 3 4  
 DESCRIPTION OF REVISIONS  
 MADE BY  
 DATE

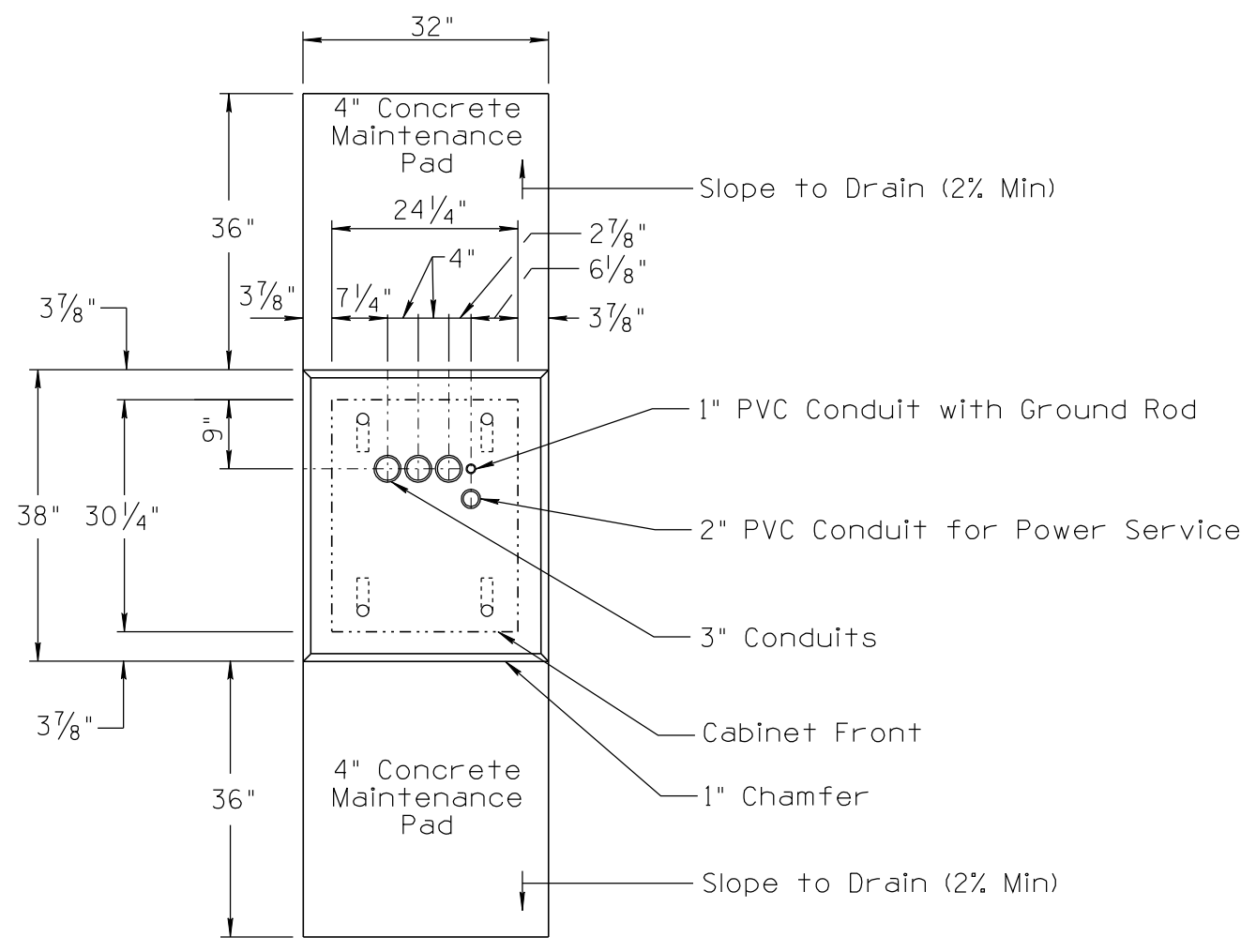

**CONTROLLER CABINET FOUNDATION**  
 (Top View)

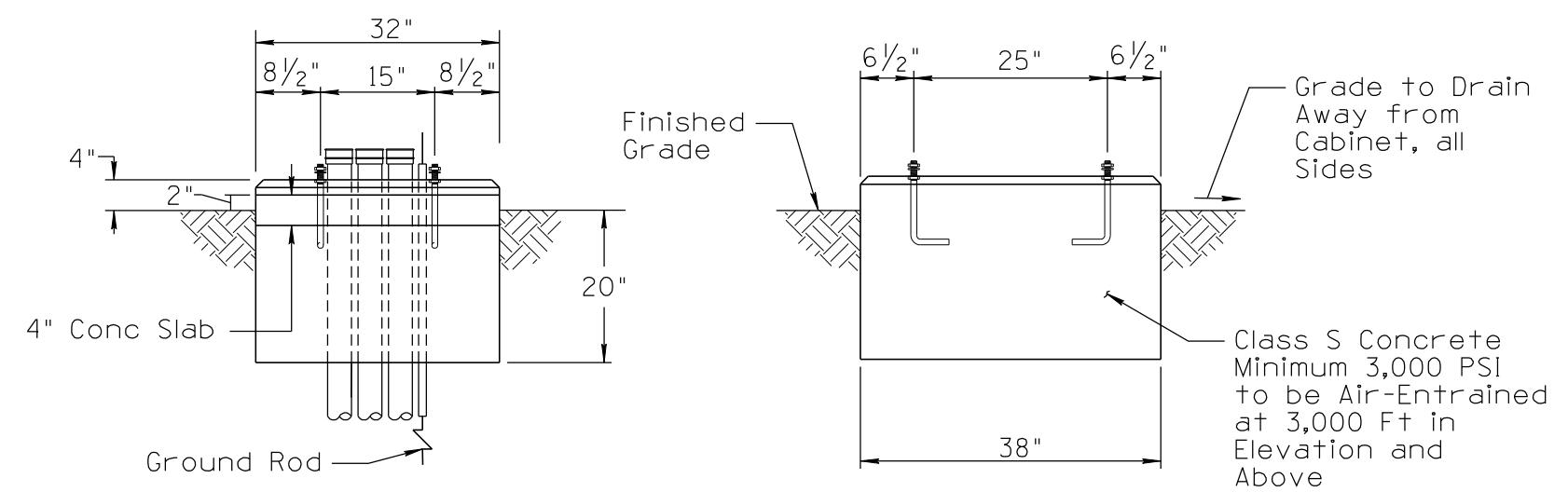

**FRONT VIEW**

**SIDE VIEW**

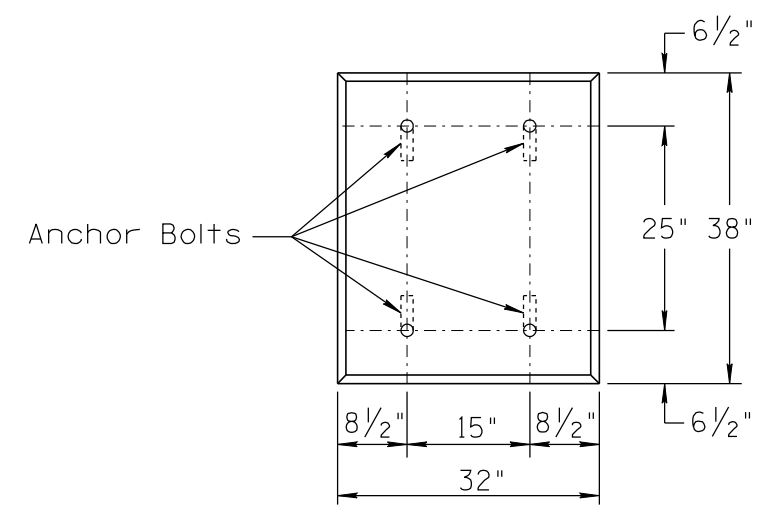

**ANCHOR BOLT ONLY LAYOUT FOUNDATION**  
 (Top View of Foundation)

**NOTES:**

1. All material and construction shall conform to the requirements of the Specifications
2. Unstable soil and/or steep slopes may require a deeper foundation. Cabinets shall not be located in drainage areas, unless they are elevated.
3. All conduits shown shall be furnished and installed in foundation. See individual plan sheets for stub-out direction.
4. Anchor bolts shall be galvanized steel, 3/4" x 12" x 4" or 5", complete with nuts and washers. Anchor bolts shall project a minimum of 1/2" and a maximum of 2 1/2" above foundation.
5. The contractor shall note that the conduit and anchor or bolt layout dimensions are extremely critical and shall be adhered to due to cabinet placement.
6. Use an approved silicon sealant RVT type, Grey in color or clear, between cabinet and foundation
7. Conduits shall project 2" to 4" above surface of foundation. Conduits shall be capped.

NOT TO SCALE

DESIGN APPROVED <b>SIGNATURE</b>	ARIZONA DEPARTMENT OF TRANSPORTATION INTERMODAL TRANSPORTATION DIVISION TRAFFIC SIGNALS AND LIGHTING STANDARD DRAWINGS	REVISION 03/10
APPROVED FOR DISTRIBUTION <b>ON FILE</b>	FOUNDATION FOR TYPE 340 CONTROL CABINET	DRAWING NO. T.S. 2-5
		SHEET NO. 1 OF 1