

NO	DESCRIPTION OF REVISIONS	MADE BY	DATE
1	REISSUED STANDARD DRAWING	RLF	4/06
2	DELETED GENERAL NOTE 7	RLF	5/07
3	REVISED VIEW; REMOVED CURB	RLF	5/07
4	ADDED NOTE & REVISED VIEW	RLF	5/12

### GENERAL NOTES

- For use where sidewalk is not continuous.
  - Ramp centerline shall be radial from the face of the curb at the Sidewalk Ramp Control Point.
  - The top of the Ramp Curb along the back of the Sidewalk Ramp shall match the elevation of the adjacent back of sidewalk and run parallel to the Sidewalk Ramp. The Ramp Curb along the side of the Sidewalk Ramp shall match the elevation at the back of the Curb & Gutter and the back of Ramp Curb.
  - Drainage inlets should not be located within marked crosswalks, or if crosswalks aren't marked, within the area a standard marked crosswalk would enclose.
  - Concrete shall receive a rough broom finish as shown.
  - See Std Dwg C-05.10 and C-05.20 for joint details.
- Pedestrian Push Button Post When Shown on Traffic Plans. See Traffic Signal Plans for Additional Information
  - ② 10" Maximum to Face of Pedestrian Push Button

### LEGEND

- ▲ Minimum Slope = 100:1 (0.01' /ft)
- ➔ Maximum Slope = 50:1 (0.02' /ft)
- ◼ Maximum Slope = 20:1 (0.05' /ft)
- ④

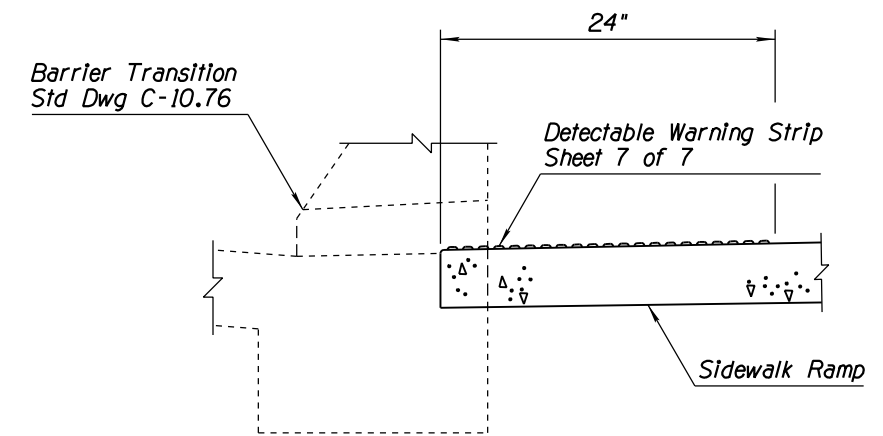
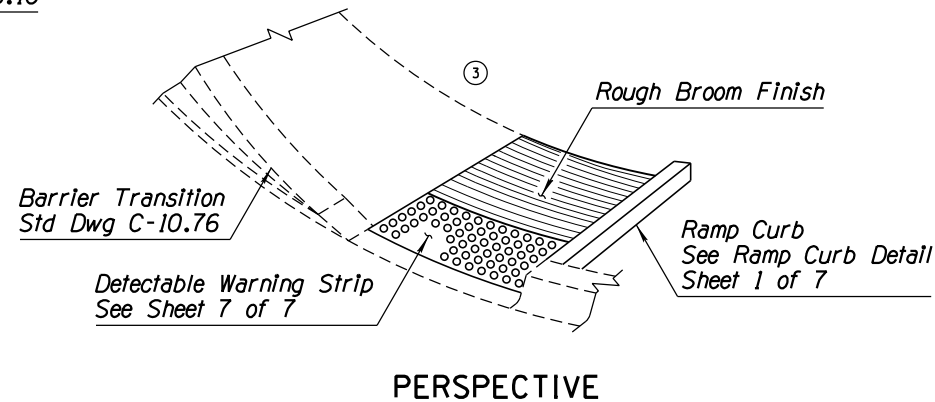
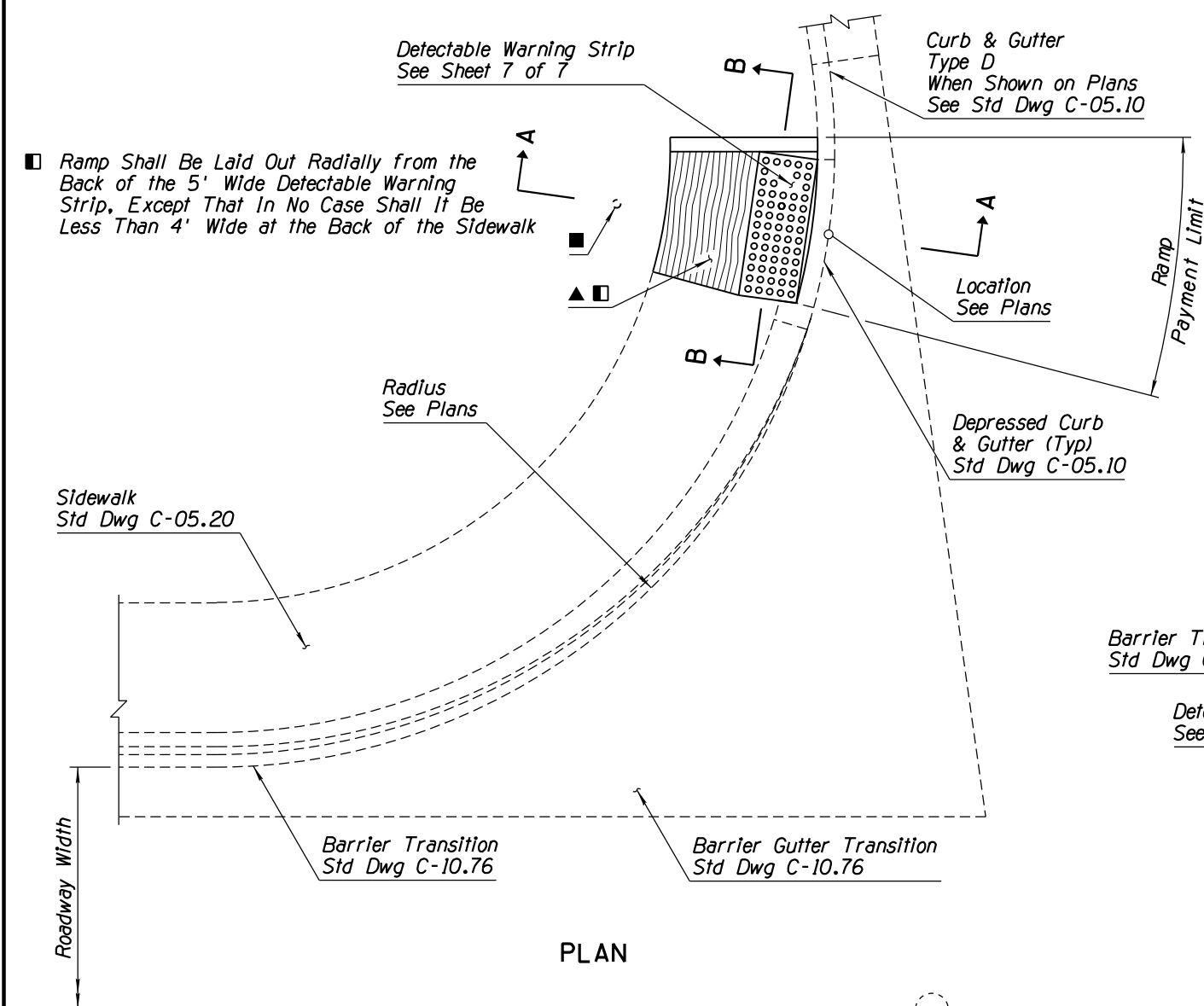

### DETAIL SIDEWALK RAMP AT SIDEWALK TERMINUS SIDEWALK BEHIND BARRIER

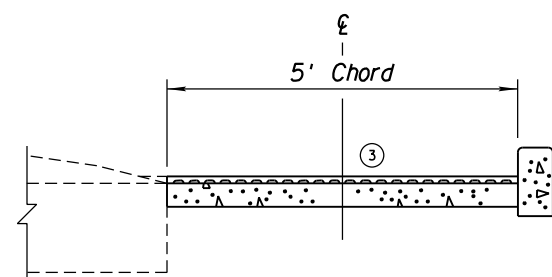

SECTION B-B

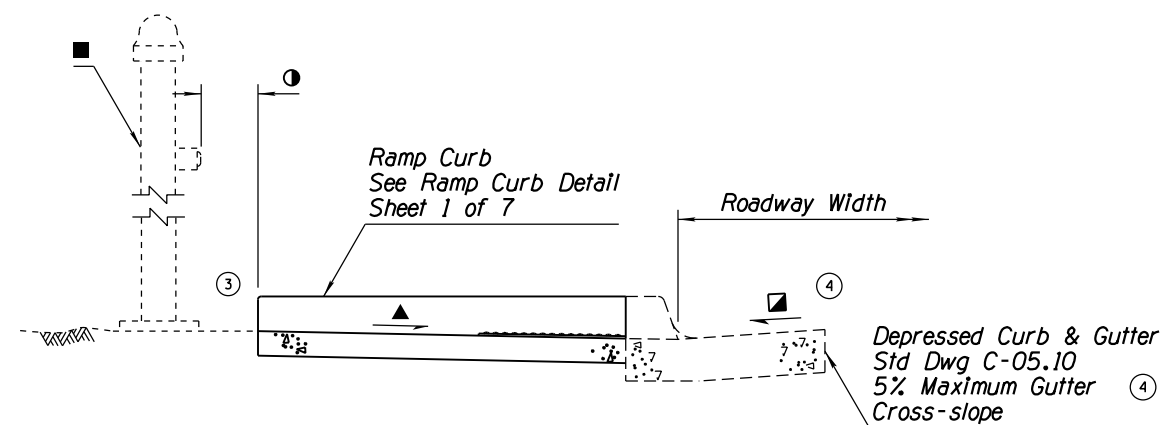

SECTION A-A

APPROVED FOR DESIGN 	STATE OF ARIZONA DEPARTMENT OF TRANSPORTATION ROADWAY STANDARD DRAWINGS	REV. 5/12
APPROVED FOR DISTRIBUTION 	SIDEWALK RAMP TYPE D	DRAWING NO. ① C-05.30 Sheet 4 of 7