

Click on MilePost numbers  
to view Plans Index sheets

xx Mile Post Numbers

# SR 98

Mile Post: 294 to 361

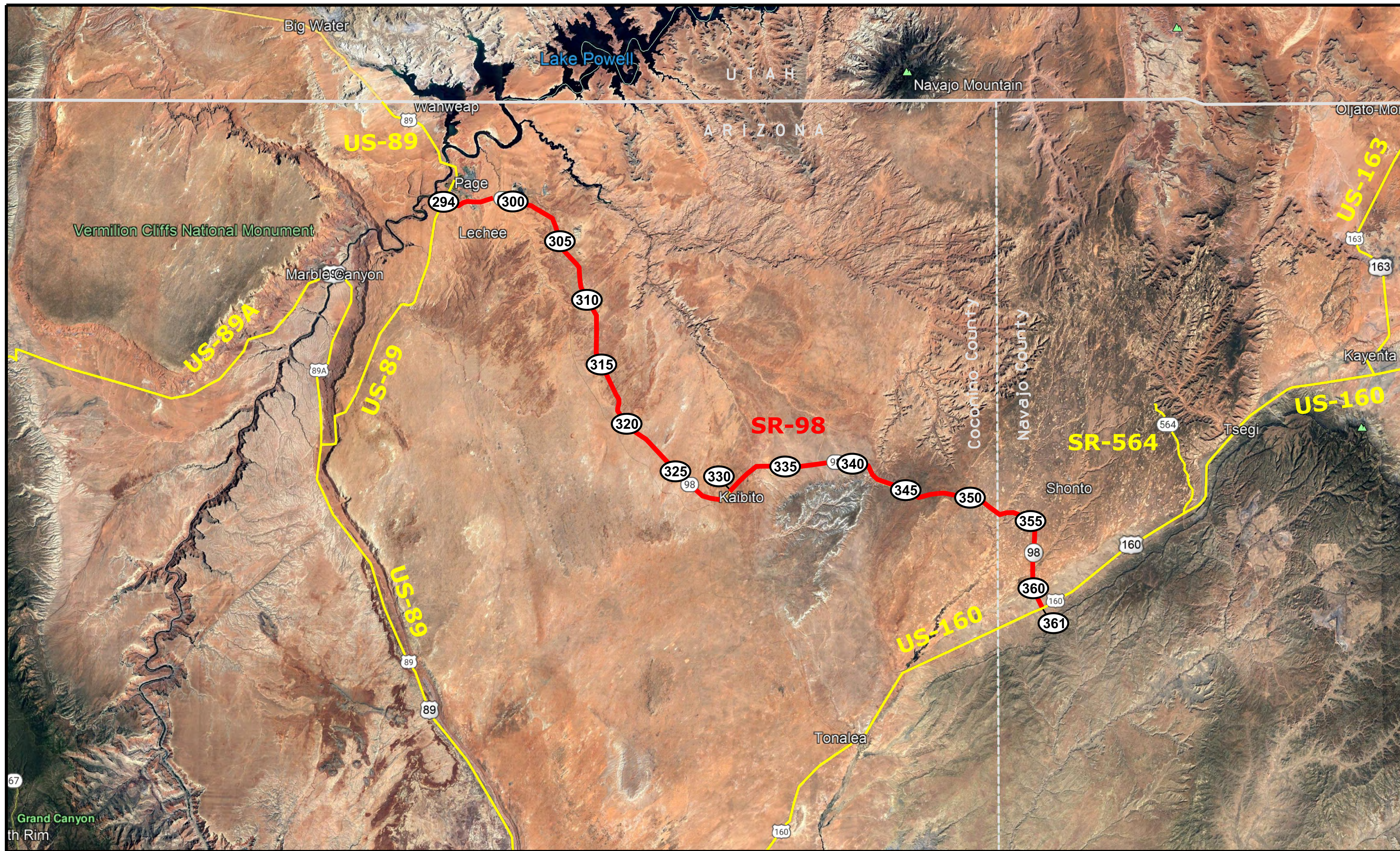



COCONINO COUNTY

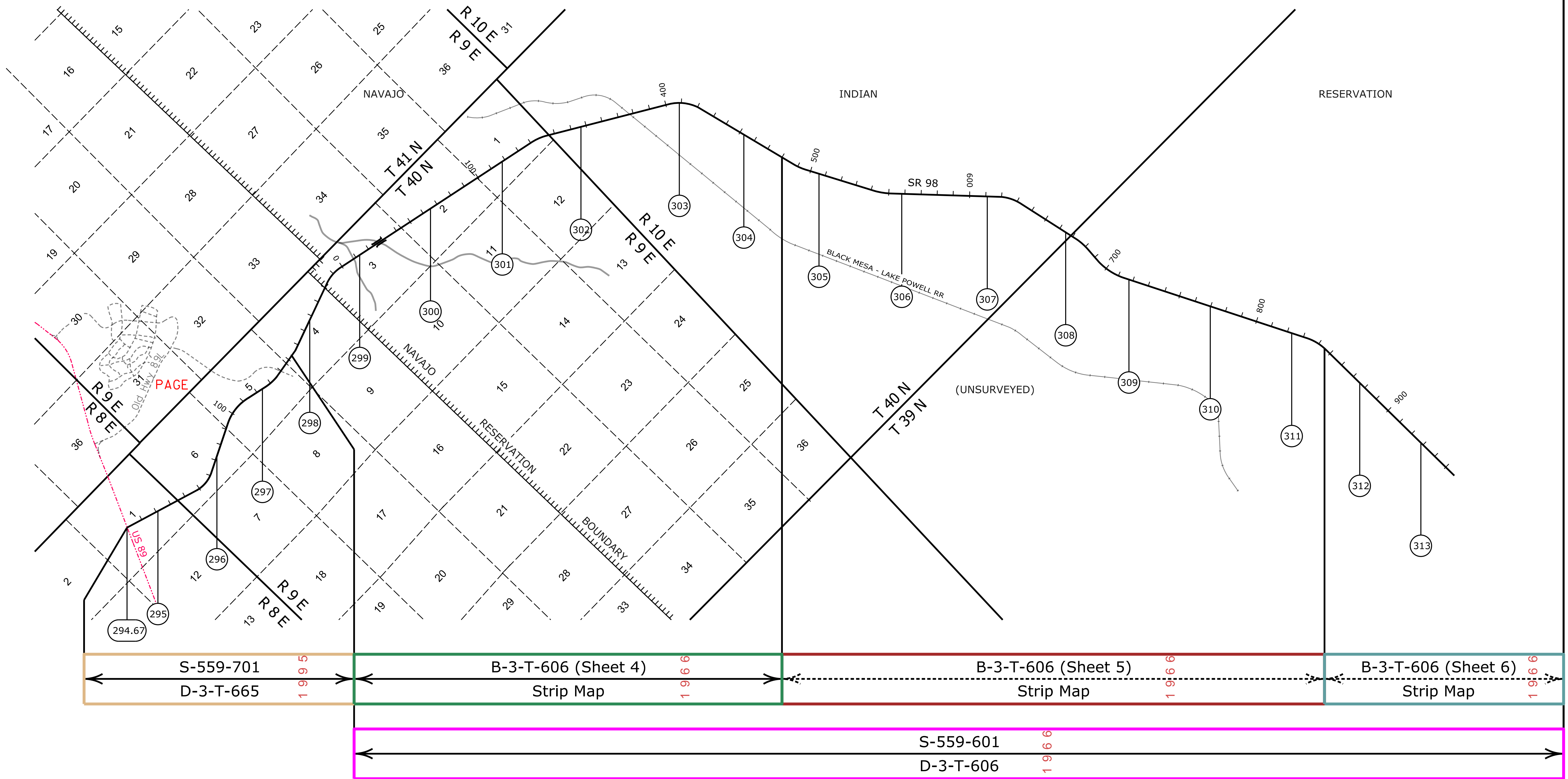
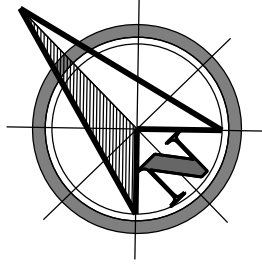

[Contact Us](#)

Click in colored box  
to view Plans/Maps  
ⓧ Mile Post Number



Right Of Way Index Map	ROUTE SR 98	MILEPOST 294.67 - 313.00
Page - Junction US 160 Hwy.		

COCONINO COUNTY

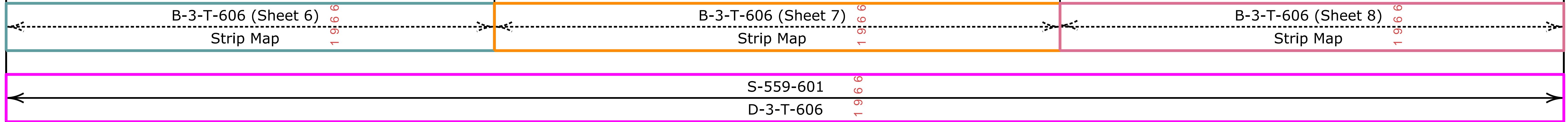
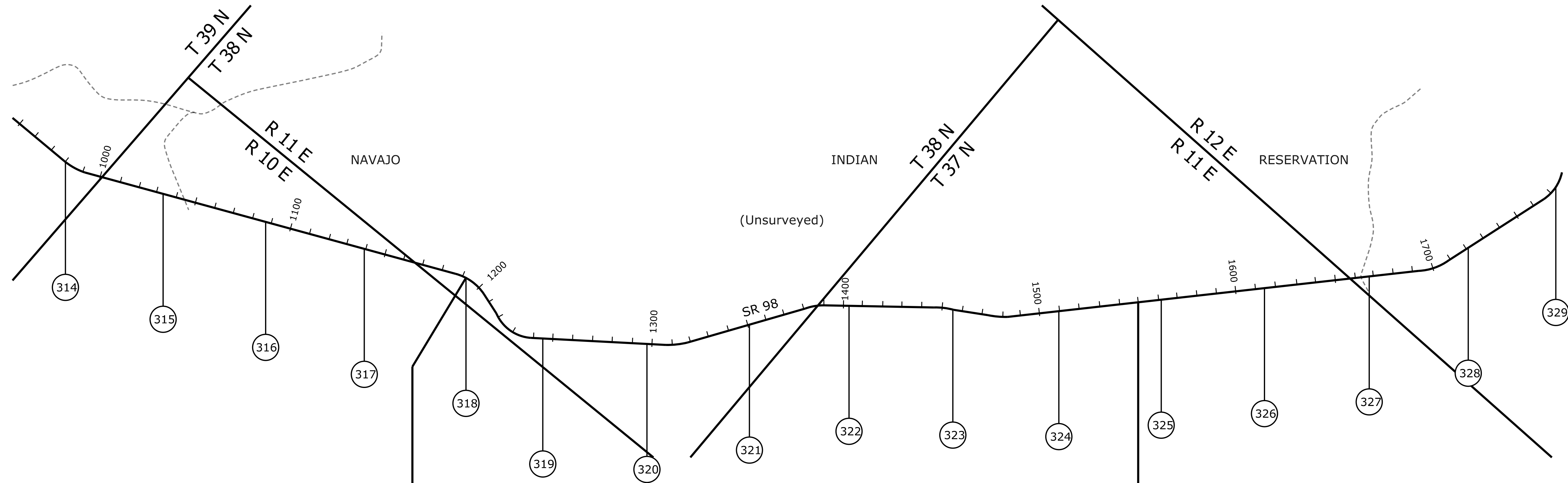
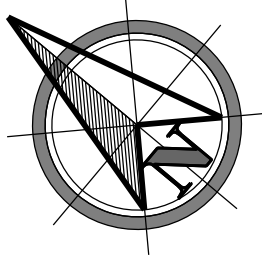

[Contact Us](#)

Click in colored box to view Plans/Maps  
 (xx) Mile Post Number



Right Of Way Index Map	ROUTE SR 98	MILEPOST 314.00 - 329.00
Page - Junction US 160 Hwy.		

COCONINO COUNTY

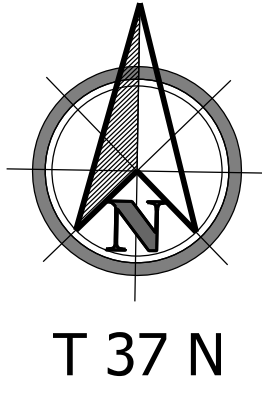

B-3-T-606 (Sheet 10)  
Strip Map

1 9 1 6 9

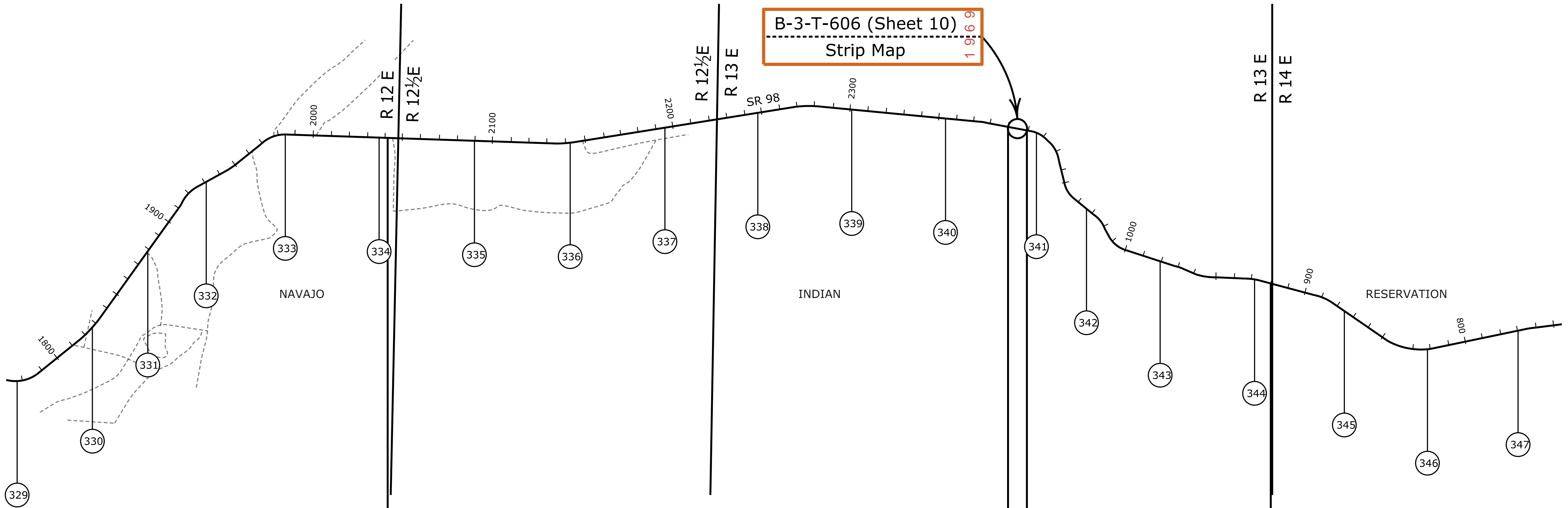

B-3-T-606 (Sheet 8)  
Strip Map

1 9 1 6 6

B-3-T-606 (Sheet 9)  
Strip Map

1 9 1 6 6

B-3-T-606 (Sheet 11)  
Strip Map

1 9 1 6 9

B-3-T-606 (Sheet 12)  
Strip Map

1 9 1 6 6

S-559-601  
D-3-T-606

1 9 1 6 6

Contact Us

Click in colored box  
to view Plans/Maps  
xx Mile Post Number



Right Of Way Index Map	ROUTE SR 98	MILEPOST 329.00 - 347.00
Page - Junction US 160 Hwy.		

G:\9340\Existing\_Plans\Basemaps\SR - 098\SR 98 Index Sheet.dgn

Modified: 01/27/15 2:43:31 PM

NAVAJO COUNTY

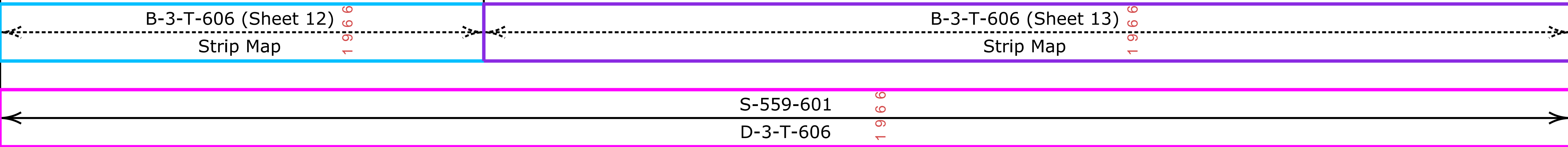
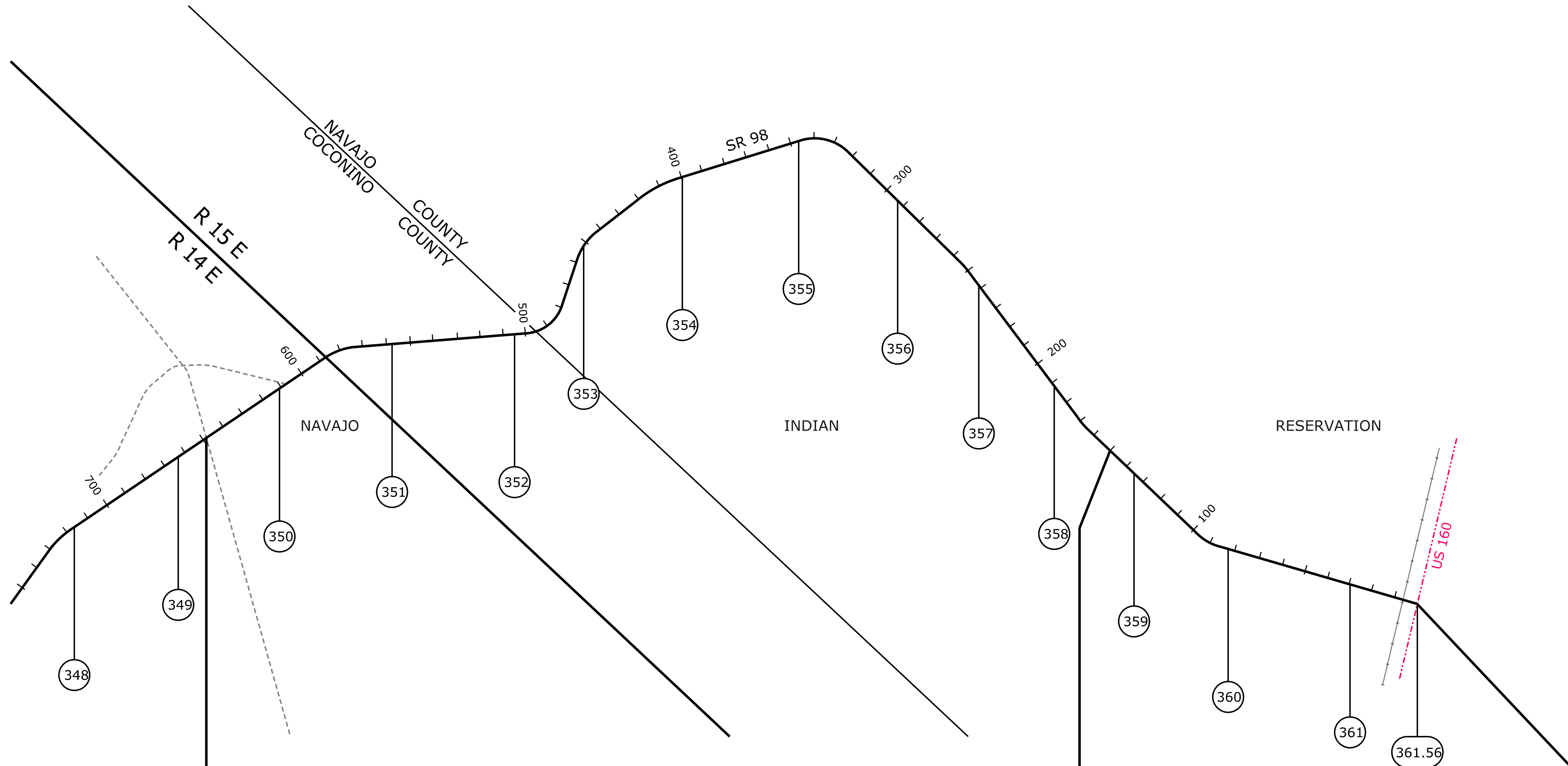
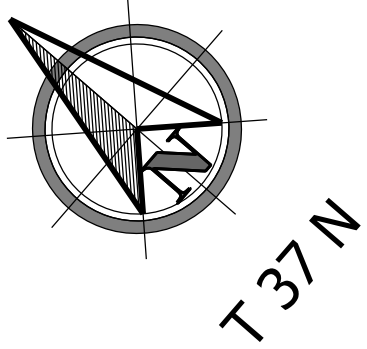

[Contact Us](#)

Click in colored box  
to view Plans/Maps  
(xx) Mile Post Number



Right Of Way Index Map	ROUTE SR 98	MILEPOST 348.00 - 361.56
Page - Junction US 160 Hwy.		