

### **APPENDIX C: AIRPORT LAYOUT PLAN DRAWINGS**

At the conclusion of the Alternatives Analysis, an evaluation was made of future options for airfield and landside development. This resulted in the selection of an alternative for the future development of Chandler Municipal Airport. Specific improvements needed to accommodate previously identified requirements for airport facilities were noted in the Airport Development Schedule and Financial Analysis. This appendix provides the Airport Layout Plan drawings that depict the results of the previous analysis, including the specific projects recommended for development, the impact of these projects on airspace and approaches to the Airport, land uses around the Airport, and the Airport's property map.

A set of plans, referred to as Airport Layout Plans, has been prepared to graphically depict the recommendations for airfield layout, disposition of obstructions, and future use of land in the vicinity of Chandler Municipal Airport. This set of plans includes the following:

- Sheet Index
- Airport Layout Plan
- Part 77 Airspace Plan
- Approach Zones Profiles
- Runway Protection Zone Plans and Profiles
- Land Use Plan
- Airport Property Map

The airport layout plan set has been prepared on a computer-aided drafting system for future ease of use. The computerized plan set provides detailed information of existing and future facility layout on multiple layers that permit the user to focus in on any section of the Airport at any desirable scale. The plan can be used as base information for design, and can be easily updated in the future to reflect new development and more detail concerning existing conditions as made available through design surveys. The plan set is provided in 22-inch x 34-inch reproducible hard copy in accordance with current FAA standards. The airport layout plan set has been developed in accordance with FAA-Western Pacific Region and ADOT-Aeronautics Division through the use of checklists provided by both agencies.

In order to comply with A.R.S. 28-8486, the Land Use Plan was developed to include overlays of the traffic pattern airspace and the airport noise contours for the 2025 condition using 60 and 55 DNL contours (55 DNL is required by the City of Chandler).

The drawings comprising the airport layout plan set for Chandler Municipal Airport are depicted in the following sheets.



# CHANDLER MUNICIPAL AIRPORT

## *Airport Layout Plan – 2006*

AZDOT PROJECT NO. E5S64 – MARICOPA COUNTY

*Chandler, Arizona*

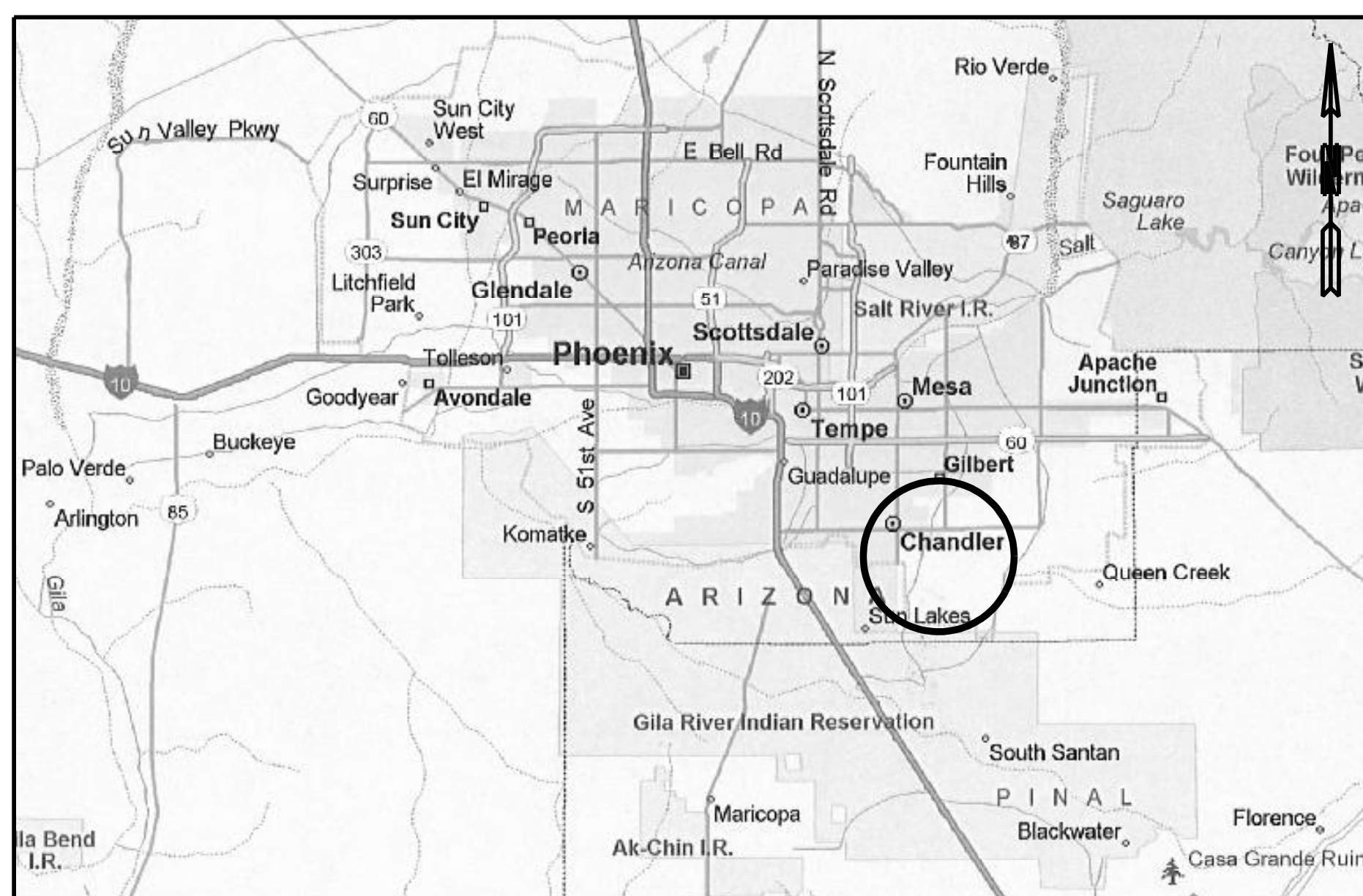

LOCATION MAP

### AIRPORT LAYOUT PLAN SET SHEET INDEX

1. AIRPORT LAYOUT PLAN
2. TERMINAL AREA PLANS
3. PART 77 AIRSPACE PLAN
4. APPROACH ZONES PROFILES
5. RUNWAY PROTECTION ZONE  
PLAN AND PROFILE RUNWAY 4R
6. RUNWAY PROTECTION ZONE  
PLAN AND PROFILE RUNWAY 22L
7. RUNWAY PROTECTION ZONE  
PLANS AND PROFILES RUNWAY 4L–22R
8. LAND USE PLAN
9. "EXHIBIT A" AIRPORT PROPERTY MAP

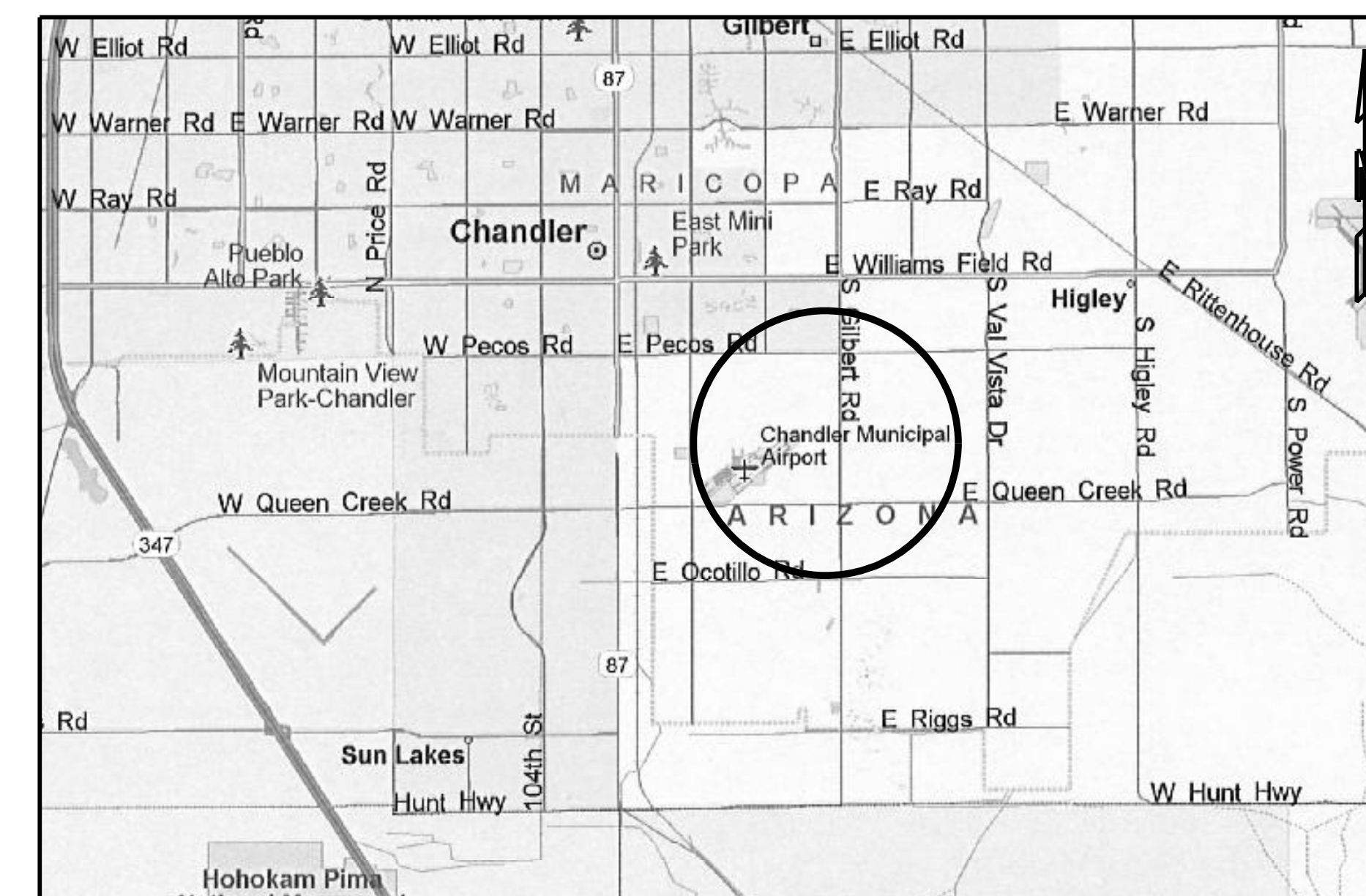

VICINITY MAP



ENGINEERS  
PLANNERS  
ECONOMISTS

**Wilbur Smith Associates**

1508 W. TARA DRIVE  
GILBERT, ARIZONA 85233  
PH: 480-775-4344

*DRAFT*



<sup>1</sup> Pavement strengths are expressed in Single(S) and Dual(D) wheel loading capacities.

RUNWAY END COORDINATES (NAD 83)			EXISTING		ULTIMATE	
RUNWAY 4R	Latitude		33° 15' 56.674" N		33° 15' 53.469" N	
	Longitude		111° 48' 50.901" W		111° 48' 55.387" W	
RUNWAY 22L	Latitude		33° 16' 27.754" N		33° 16' 37.049" N	
	Longitude		111° 48' 07.389" W		111° 47' 54.373" W	
RUNWAY 4L	Latitude		33° 15' 50.607" N		SAME	
	Longitude		111° 49' 11.831" W		SAME	
RUNWAY 22R	Latitude		33° 16' 19.978" N		SAME	
	Longitude		111° 48' 32.403" W		SAME	
RUNWAY PROTECTION ZONE DATA						
RUNWAY END	EXISTING RPZ DIMENSIONS			ULTIMATE RPZ DIMENSIONS		
	A	B	C	A	B	C
4R	500	700	1000	500	1010	1700
22L	500	700	1000	500	1010	1700
4L	500	700	1000	500	700	1000
22R	500	700	1000	500	700	1000

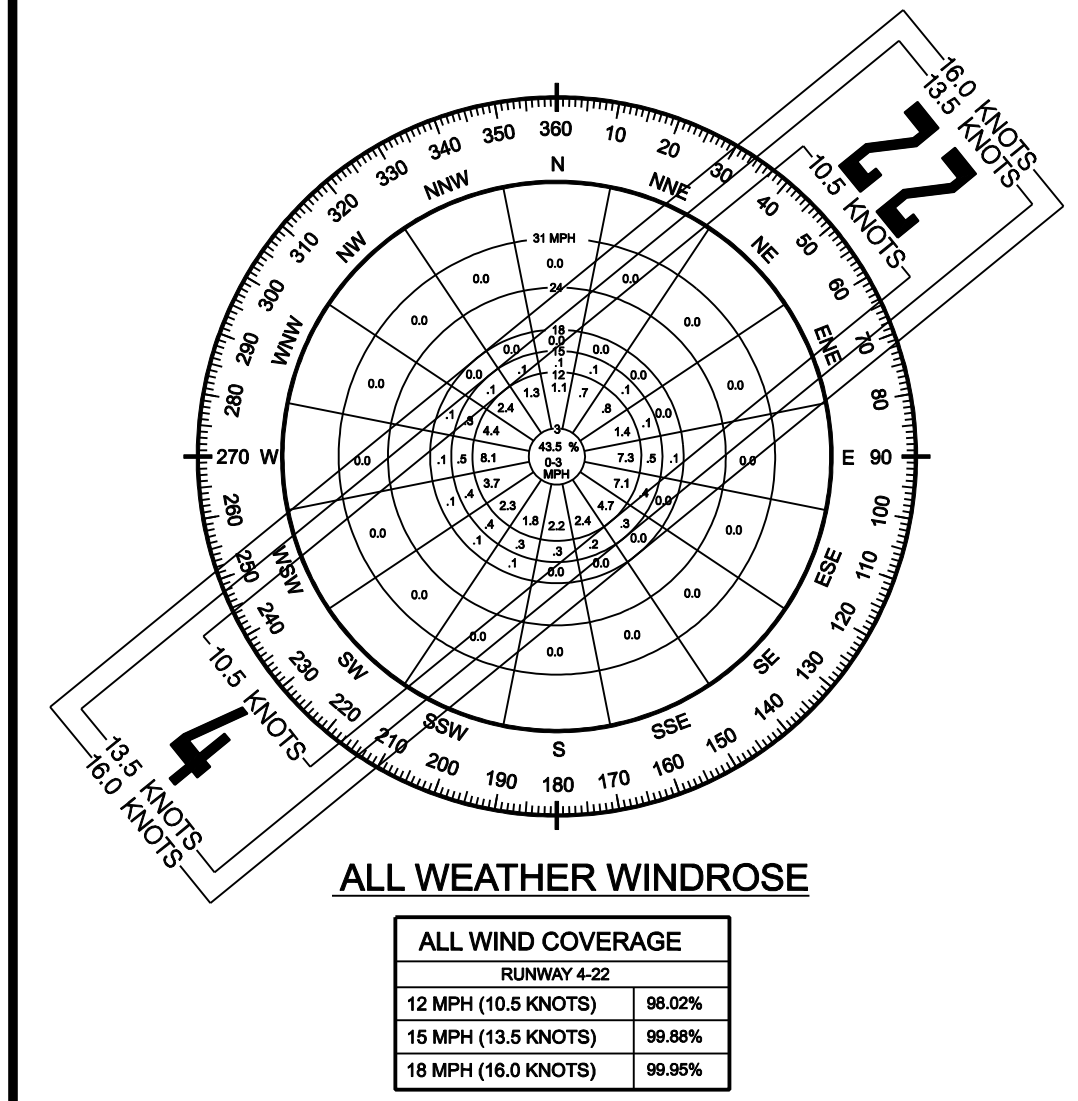
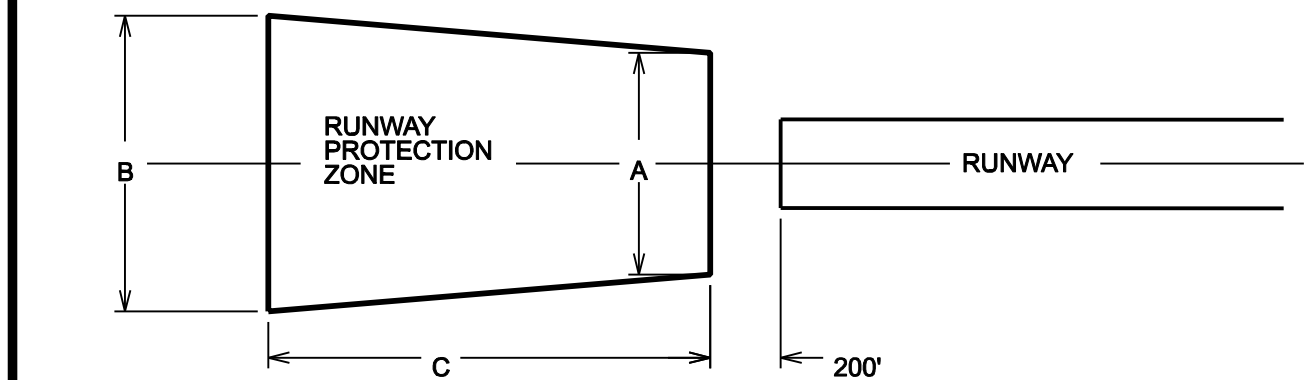

USAFETAC  
Air Weather Service (MAC)  
DATA STATION:  
Williams Air Force Base  
Mesa, Arizona  
OBSERVATIONS:  
53,403 Observations  
1963-1992

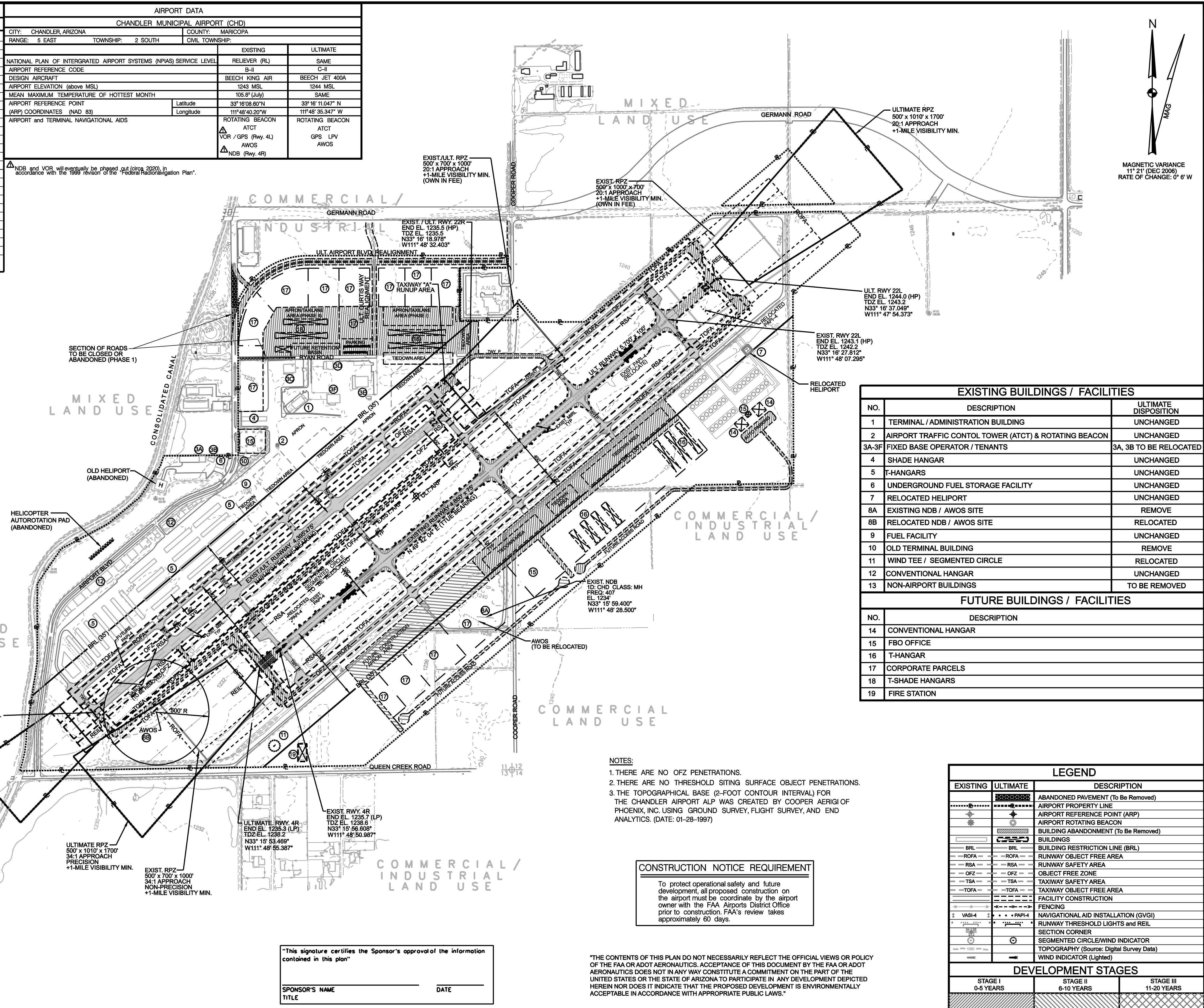

500 0 500 1000 1500

SCALE: 1" = 500'

[illegible]

PLANS PREPARED BY

 ENGINEERS  
PLANNERS  
ECONOMISTS

**Wilbur Smith Associates**

1508 W. TARA DRIVE  
GILBERT, ARIZONA 85233  
PH 602/833-8800

<p>PLANS PREPARED FOR</p> <p>CHANDLER MUNICIPAL AIRPORT</p> <p>CHANDLER, ARIZONA</p>	
<p>PROJECT NO. (CLIENT)</p> <p>AZDOT - E5S64</p>	<p>PROJECT NO. (WSA)</p> <p>A31476</p>

AIRPORT LAYOUT PLAN



EXISTING BUILDINGS / FACILITIES			FUTURE BUILDINGS / FACILITIES	
NO.	DESCRIPTION	ULTIMATE DISPOSITION	NO.	DESCRIPTION
1	TERMINAL / ADMINISTRATION BUILDING	UNCHANGED	14	CONVENTIONAL HANGAR
2	AIRPORT TRAFFIC CONTROL TOWER (ATCT) & ROTATING BEACON	UNCHANGED	15	FBO OFFICE
3A-3F	FIXED BASE OPERATION HANGAR	3A, 3B TO BE RELOCATED	16	T-HANGAR
4	SHADE HANGAR	UNCHANGED	17	CORPORATE PARCELS
5	T-HANGAR	UNCHANGED	18	T-SHADE HANGARS
6	UNDERGROUND FUEL STORAGE FACILITY	UNCHANGED		
7	RELOCATED HELIPORT	UNCHANGED		
8	NDB / AWOS SITE	REMOVE / RELOCATE		
9	FUEL FACILITY	UNCHANGED		
10	OLD TERMINAL BUILDING	REMOVE		
11	WIND TEE / SEGMENTED CIRCLE	RELOCATED		
12	CONVENTIONAL HANGAR	UNCHANGED		
13	NON-AIRPORT BUILDINGS	TO BE REMOVED		

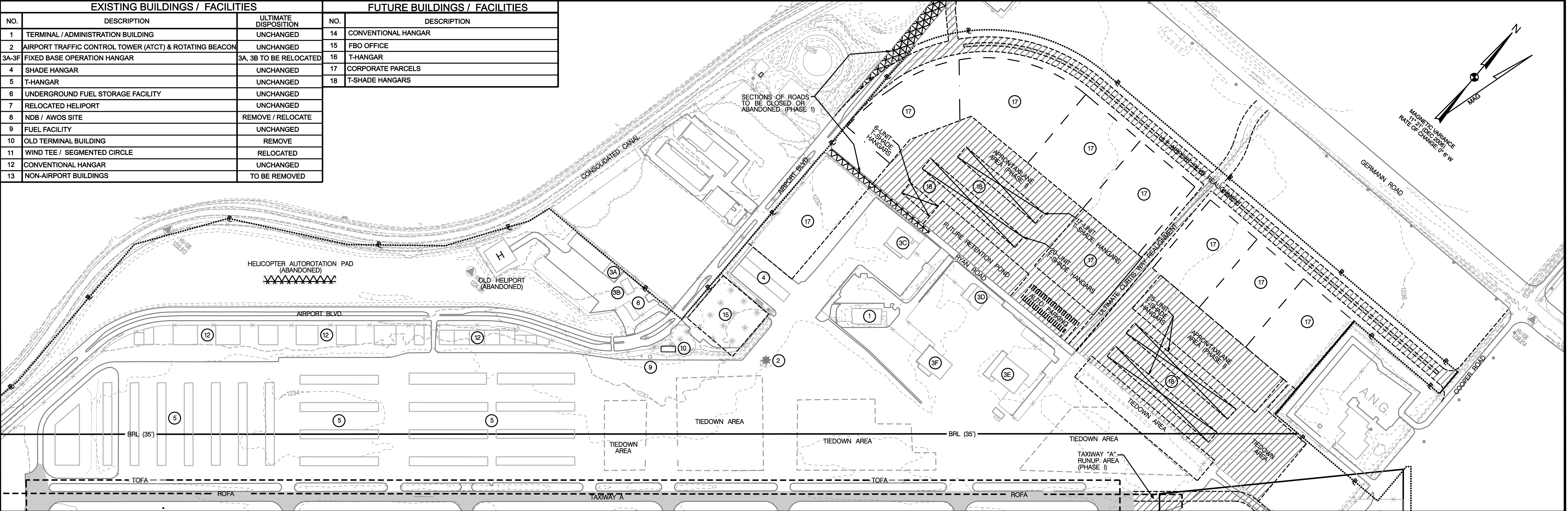

NORTHWEST of RUNWAY 4L-22R

NOTE:  
THE TOPOGRAPHICAL BASE (2-FOOT CONTOUR INTERVAL) FOR THE CHANDLER AIRPORT ALP WAS CREATED BY COOPER AERIGI OF PHOENIX, INC. USING GROUND SURVEY, FLIGHT SURVEY, AND END ANALYTICS. (DATE: 01-28-1997)

LEGEND		
EXISTING	ULTIMATE	DESCRIPTION
---	---	ABANDONED PAVEMENT (To Be Removed)
---	---	AIRPORT PROPERTY LINE
---	---	AIRPORT REFERENCE POINT (ARP)
---	---	AIRPORT ROTATING BEACON
---	---	BUILDING ABANDONMENT (To Be Removed)
---	---	BUILDINGS
---	---	BUILDING RESTRICTION LINE (BRL)
---	---	RUNWAY OBJECT FREE AREA
---	---	RUNWAY SAFETY AREA
---	---	OBJECT FREE ZONE
---	---	TAXIWAY SAFETY AREA
---	---	TAXIWAY OBJECT FREE AREA
---	---	FACILITY CONSTRUCTION
---	---	FENCING
---	---	NAVIGATIONAL AID INSTALLATION (GVGI)
---	---	RUNWAY THRESHOLD LIGHTS and REIL
---	---	SECTION CORNER
---	---	SEGMENTED CIRCLE/WIND INDICATOR
---	---	TOPOGRAPHY (Source: Digital Survey Data)
---	---	WIND INDICATOR (Lighted)
DEVELOPMENT STAGES		
STAGE I 0-5 YEARS	STAGE II 6-10 YEARS	STAGE III 11-20 YEARS

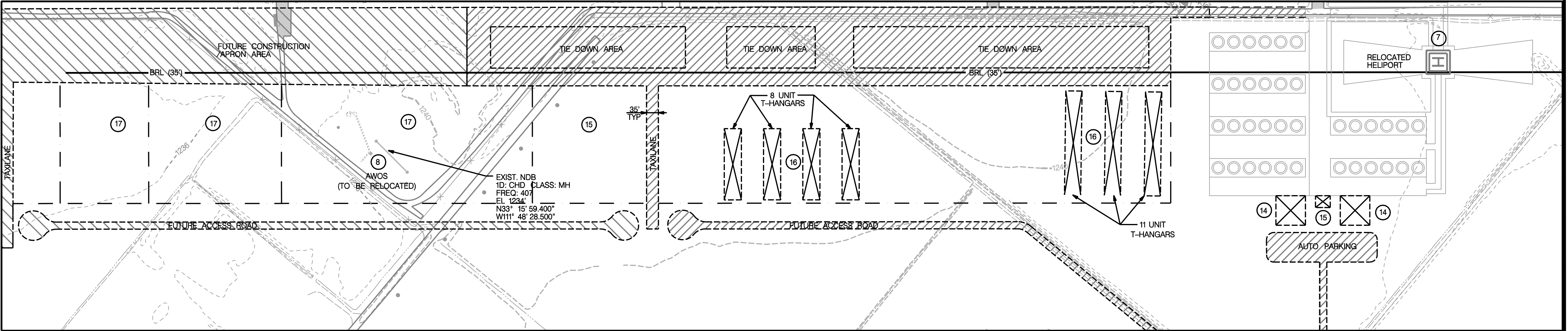

SOUTHEAST of RUNWAY 4R-22L

"THE CONTENTS OF THIS PLAN DO NOT NECESSARILY REFLECT THE OFFICIAL VIEWS OR POLICY OF THE FAA OR ADOT AERONAUTICS. ACCEPTANCE OF THIS DOCUMENT BY THE FAA OR ADOT AERONAUTICS DOES NOT IN ANY WAY CONSTITUTE A COMMITMENT ON THE PART OF THE UNITED STATES OR THE STATE OF ARIZONA TO PARTICIPATE IN ANY DEVELOPMENT DEPICTED HEREIN NOR DOES IT INDICATE THAT THE PROPOSED DEVELOPMENT IS ENVIRONMENTALLY ACCEPTABLE IN ACCORDANCE WITH APPROPRIATE PUBLIC LAWS."

REVISIONS:				
REV. NO.	BY	APP'D.	DATE	DESCRIPTION OF REVISION
1		FAA	4-10-92	ALP - CONDITIONAL APPROVAL
2		FAA	9-23-94	ALP - REVALIDATED
3		FAA	12-10-99	ALP - REVALIDATED
4		FAA	5-22-00	ALP - CONDITIONAL APPROVAL
			--	
			--	

200 0 200 400 600			
SCALE: 1" = 200'			
DESIGNED BY	SP	DATE	11 / 06
DRAWN BY	KW	DATE	11 / 06
CHECKED BY	JM	DATE	12 / 06

APPROVALS	

PLANS PREPARED BY

ENGINEERS  
PLANNERS  
ECONOMISTS

**Wilbur Smith Associates**

1508 W. TARA DRIVE  
GILBERT, ARIZONA 85233  
PH: 480-775-4344

PLANS PREPARED FOR	
CHANDLER MUNICIPAL AIRPORT CHANDLER, ARIZONA	
PROJECT NO. (CLIENT)	PROJECT NO. (WSA)
AZDOT - E5S64	A31476

TERMINAL AREA PLANS	
	NO. 2



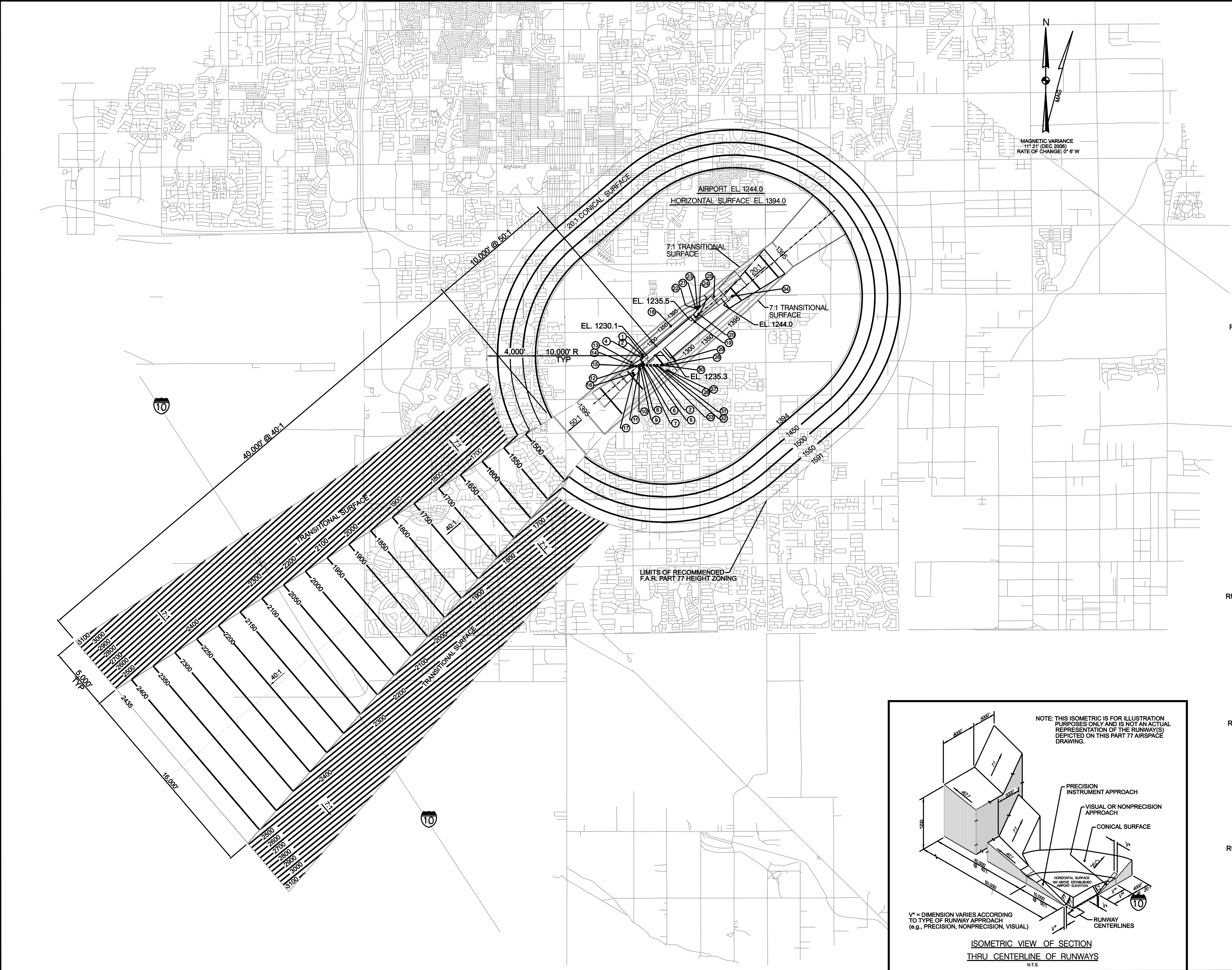

GENERAL NOTES

1. OBSTRUCTIONS, CLEARANCES, AND LOCATIONS ARE CALCULATED FROM ULTIMATE RUNWAY END ELEVATIONS AND ULTIMATE APPROACH SURFACES, UNLESS OTHERWISE NOTED.
2. DEPICTION OF FEATURES AND OBJECTS WITHIN THE PRIMARY, TRANSITIONAL, AND HORIZONTAL PART 77 SURFACES, ARE ILLUSTRATED ON THIS DRAWING, THE PART 77 AIRSPACE PLAN.
3. DEPICTION OF FEATURES AND OBJECTS WITHIN THE OUTER PORTION OF THE APPROACH SURFACES, IS ILLUSTRATED ON THE APPROACH PROFILES DRAWING, SHEET 4 OF THESE PLANS.
4. DEPICTION OF FEATURES AND OBJECTS WITHIN THE INNER PORTION OF THE APPROACH SURFACES, IS ILLUSTRATED ON THE RUNWAY PROTECTION ZONE PLAN AND PROFILE DRAWINGS, SHEETS 5, 6 AND 7 OF THESE PLANS.
5. EXISTING AND FUTURE HEIGHT AND HAZARD ORDINANCES ARE TO BE AMENDED AND /OR REFERENCED UPON APPROVAL OF UPDATED AIRPORT AIRSPACE DRAWING.
6. ADDITIONAL OBSTRUCTION DATA IS ILLUSTRATED ON NATIONAL OCEAN SURVEY DOCUMENT OC 6494, AIRPORT OBSTRUCTION CHART.

OBSTRUCTION TABLE

		OBSTRUCTION TABLE			
	OBSTRUCTION NUMBER	OBJECT DESCRIPTION	ELEVATION (MSL)	SURFACE PENETRATION /CLEARANCE	ULTIMATE OBJECT DISPOSITION
RUNWAY 4L	①	ROAD	1246	15	UNCHANGED
	②	ROAD	1246	13	UNCHANGED
	③	POLE	1264	4	UNCHANGED
	④	ROAD	1244	9	UNCHANGED
	⑤	POLE	1264	26	UNCHANGED
	⑥	POLE	1263	22	UNCHANGED
	⑦	POLE	1257	15	UNCHANGED
	⑧	POLE	1263	19	UNCHANGED
	⑨	POLE	1264	18	UNCHANGED
	⑩	ROAD	1246	0	UNCHANGED
	⑪	TREE	1290	41	UNCHANGED
	⑫	POLE	1266	16	UNCHANGED
	⑬	POLE	1274	21	UNCHANGED
	⑭	CAMERA ON LIGHT POLE	1263	9	UNCHANGED
	⑮	POLE	1265	12	UNCHANGED
	⑯	TREE	1286	24	UNCHANGED
RUNWAY 22R	⑰	TREE	1289	27	UNCHANGED
	⑱	ANTENNA	1337	10	UNCHANGED
	⑲	BUSH	1238	1	REMOVE
	⑳	FENCE	1245	−4	RELOCATE
	㉑	TOWER	1319	52	UNCHANGED
	㉒	BUILDING VENT	1259	6	UNCHANGED
	㉓	TREE	1265	2	REMOVE
	㉔	POLE	1272	13	UNCHANGED
	㉕	TREE	1281	−5	REMOVE
RUNWAY 4R	㉖	TREE	1266	16	UNCHANGED
	㉗	TREE	1282	1	REMOVE
	㉘	TREE	1275	21	UNCHANGED
	㉙	CANTENARY	1263	16	UNCHANGED
	㉚	POLE	1266	4	UNCHANGED
	㉛	POLE	1265	7	UNCHANGED
	㉜	TREE	1267	2	REMOVE
	㉝	POLE	1264	3	UNCHANGED
	㉞	POLE	1261	−3	REMOVE
RUNWAY 22L	㉟	POLE	1261	−3	REMOVE

NOTE:  
THE OBSTRUCTION DATA WAS COLLECTED IN ACCORDANCE WITH FAA  
AREA NAVIGATION APPROACH (ANA-LPV) SURVEY SPECIFICATIONS  
NOAA - NATIONAL GEODETIC SURVEY - (4-1-2005)

"THE CONTENTS OF THIS PLAN DO NOT NECESSARILY REFLECT THE OFFICIAL VIEWS OR POLICY OF THE FAA OR ADOT AERONAUTICS. ACCEPTANCE OF THIS DOCUMENT BY THE FAA OR ADOT AERONAUTICS DOES NOT IN ANY WAY CONSTITUTE A COMMITMENT ON THE PART OF THE UNITED STATES OR THE STATE OF ARIZONA TO PARTICIPATE IN ANY DEVELOPMENT DEPICTED HEREIN NOR DOES IT INDICATE THAT THE PROPOSED DEVELOPMENT IS ENVIRONMENTALLY ACCEPTABLE IN ACCORDANCE WITH APPROPRIATE PUBLIC LAWS."

REVISIONS:				
REV. NO.	BY	APP'D.	DATE	DESCRIPTION OF REVISION
1		FAA	4-10-92	ALP - CONDITIONAL APPROVAL
2		FAA	9-23-94	ALP - REVALIDATED
3		FAA	12-10-99	ALP - REVALIDATED
4		FAA	5-22-00	ALP - CONDITIONAL APPROVAL
			--	
			--	
			--	

4000 0 4000 8000 12000

SCALE: 1" = 4000'

DESIGNED BY	SP	DATE	11 / 06
DRAWN BY	KW	DATE	11 / 06
CHECKED BY	JM	DATE	12 / 06

APPROVALS

PLANS PREPARED BY



ENGINEERS  
PLANNERS  
ECONOMISTS

**Wilbur Smith Associates**

1508 W. TARA DRIVE  
GILBERT, ARIZONA 85233  
PH: 480-775-4344

PLANS PREPARED FOR

CHANDLER MUNICIPAL AIRPORT  
CHANDLER, ARIZONA

PROJECT NO. (CLIENT)

AZDOT - E5S64

PROJECT NO. (WSA)

A31476

PART 77 AIRSPACE PLAN

NO. 3



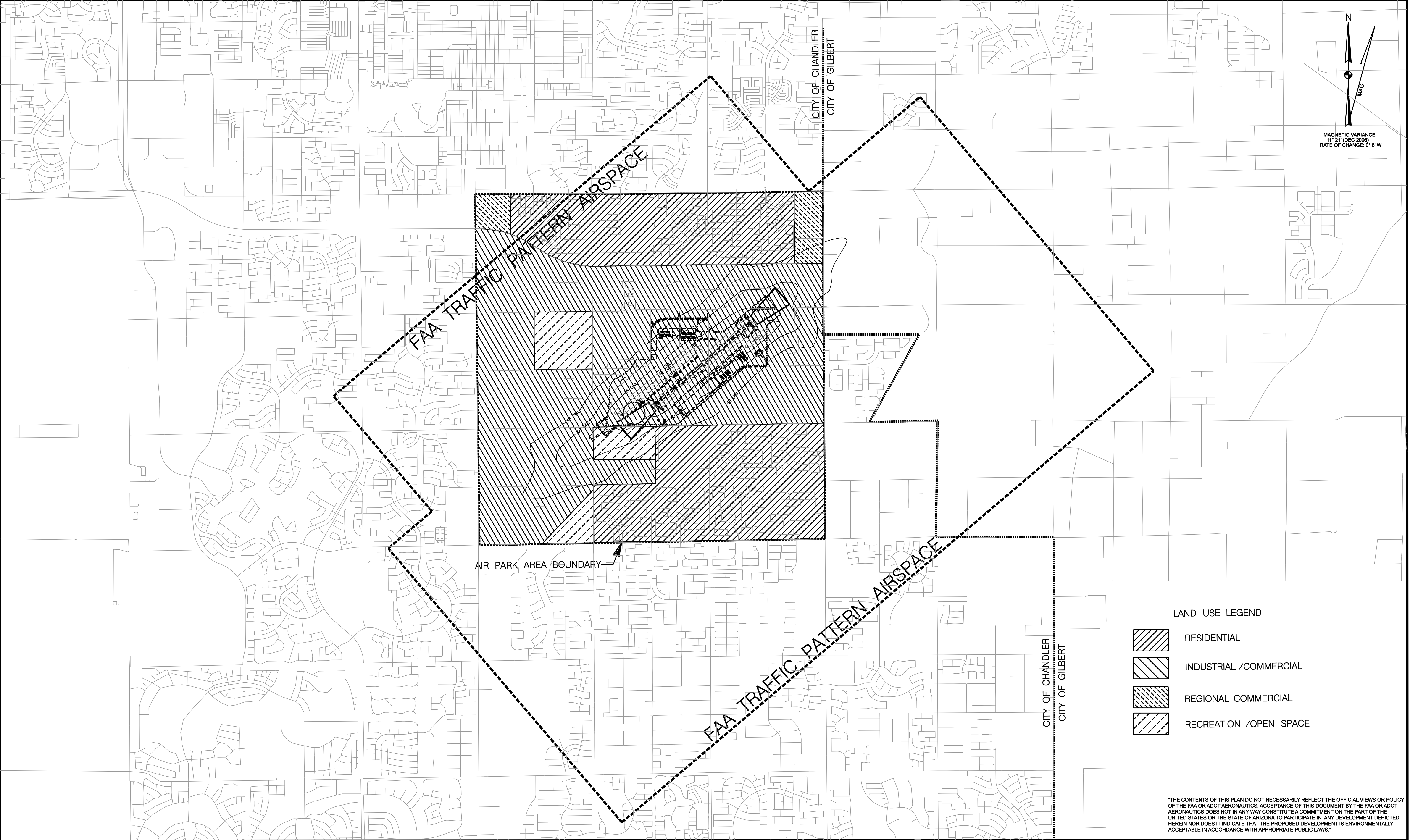

MAGNETIC VARIANCE  
11° 21' (DEC 2008)  
RATE OF CHANGE: 0° 8' W

LAND USE LEGEND

- RESIDENTIAL
- INDUSTRIAL /COMMERCIAL
- REGIONAL COMMERCIAL
- RECREATION /OPEN SPACE

"THE CONTENTS OF THIS PLAN DO NOT NECESSARILY REFLECT THE OFFICIAL VIEWS OR POLICY OF THE FAA OR ADOT. AERONAUTICS ACCEPTANCE OF THIS DOCUMENT BY THE FAA OR ADOT AERONAUTICS DOES NOT IN ANY WAY CONSTITUTE A COMMITMENT ON THE PART OF THE UNITED STATES OR THE STATE OF ARIZONA TO PARTICIPATE IN ANY DEVELOPMENT DEPICTED HEREIN NOR DOES IT INDICATE THAT THE PROPOSED DEVELOPMENT IS ENVIRONMENTALLY ACCEPTABLE IN ACCORDANCE WITH APPROPRIATE PUBLIC LAWS."

REVISIONS:				
REV. NO.	BY	APP'D.	DATE	DESCRIPTION OF REVISION
1		FAA	4-10-92	ALP - CONDITIONAL APPROVAL
2		FAA	9-23-94	ALP - REVALIDATED
3		FAA	12-10-99	ALP - REVALIDATED
4		FAA	5-22-00	ALP - CONDITIONAL APPROVAL
			- -	
			- -	
			- -	

2000 0 2000 4000 6000			
SCALE: 1" = 2000'			
DESIGNED BY	SP	DATE	11 / 06
DRAWN BY	KW	DATE	11 / 06
CHECKED BY	JM	DATE	12 / 06

APPROVALS

PLANS PREPARED BY

 ENGINEERS  
PLANNERS  
ECONOMISTS

**Wilbur Smith Associates**  
1508 W. TARA DRIVE  
GILBERT, ARIZONA 85233  
PH: 480-775-4344

PLANS PREPARED FOR	
CHANDLER MUNICIPAL AIRPORT CHANDLER, ARIZONA	
PROJECT NO. (CLIENT)	PROJECT NO. (WSA)
AZDOT - E5S64	A31476

DRAFT LAND USE PLAN	
	NO. 8

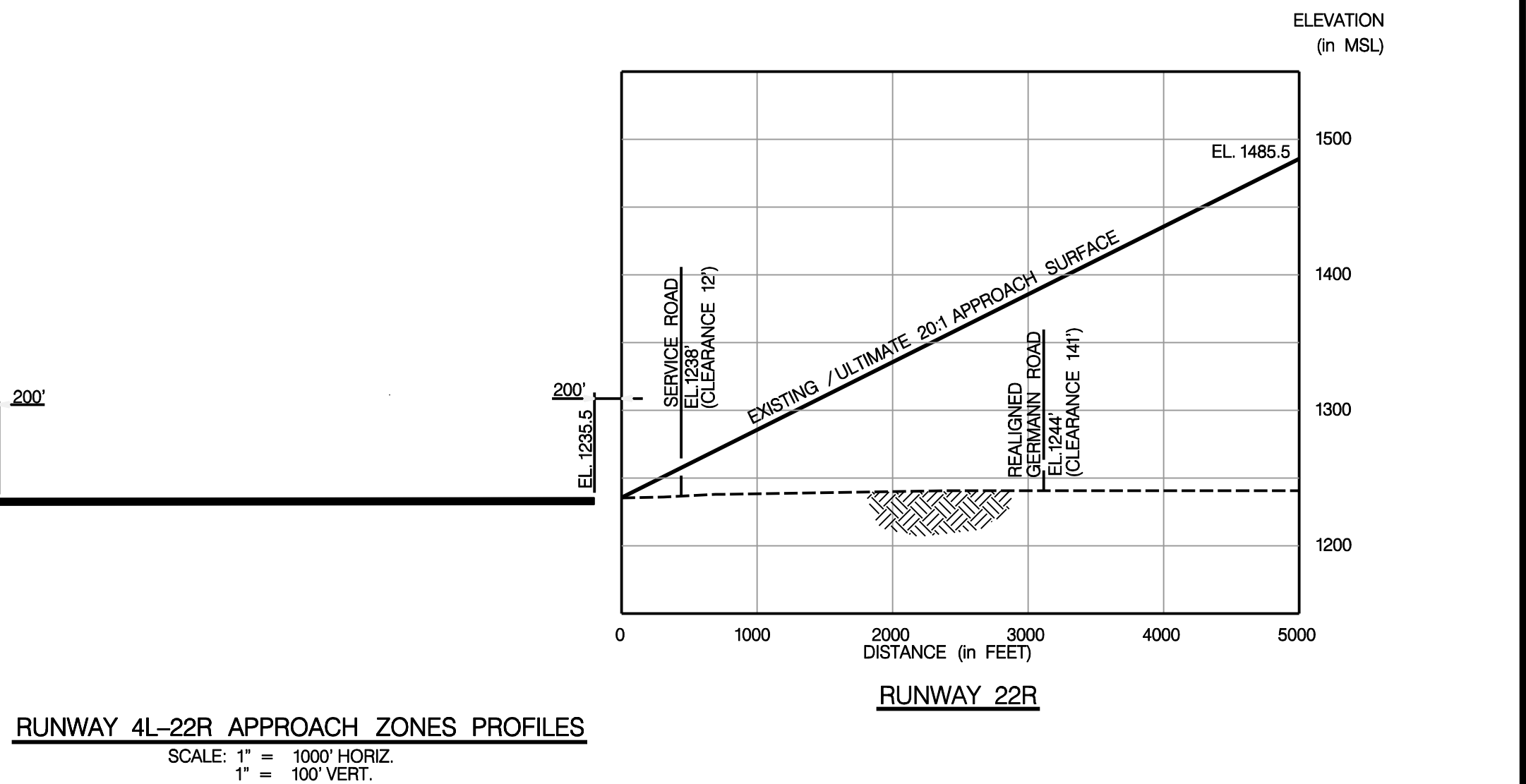
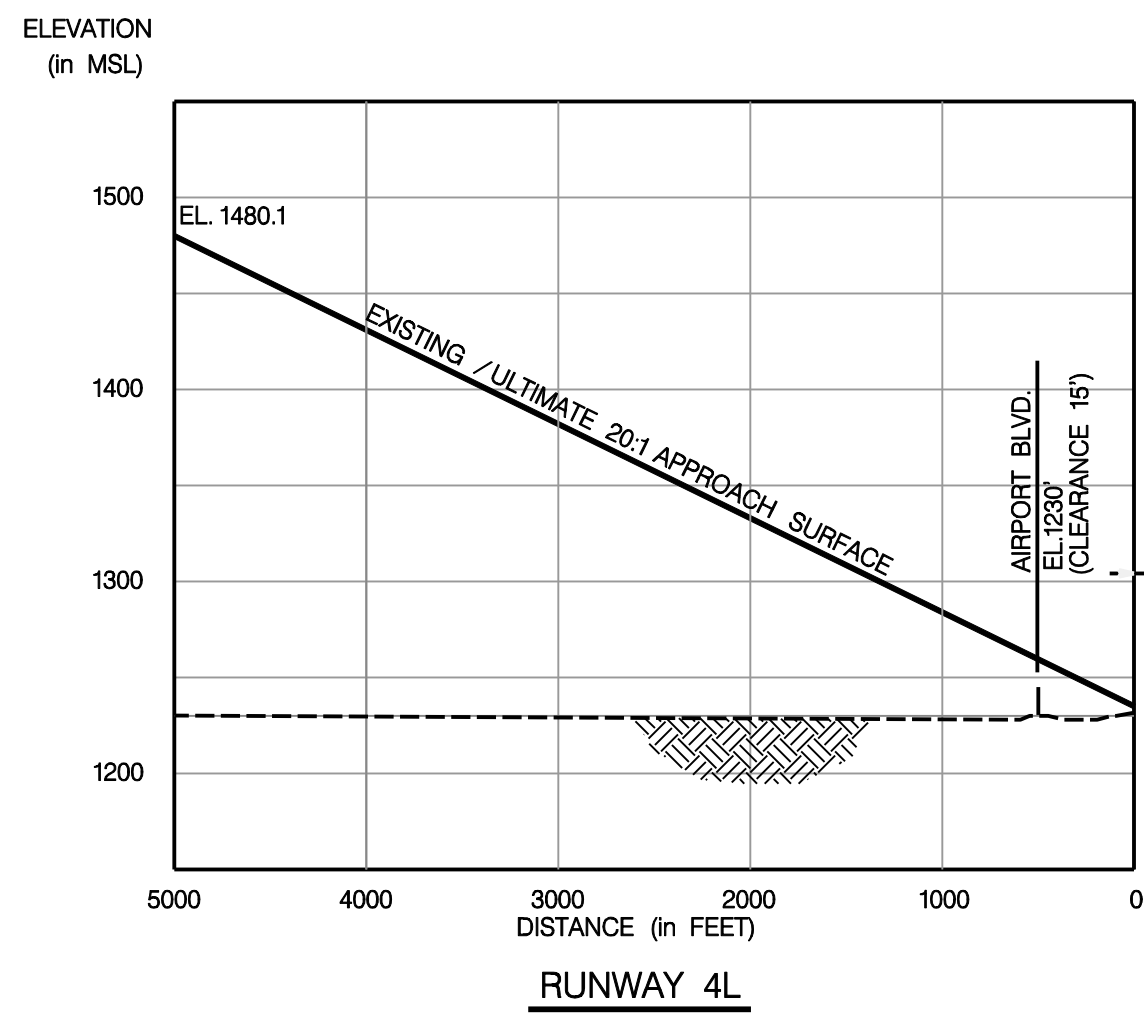
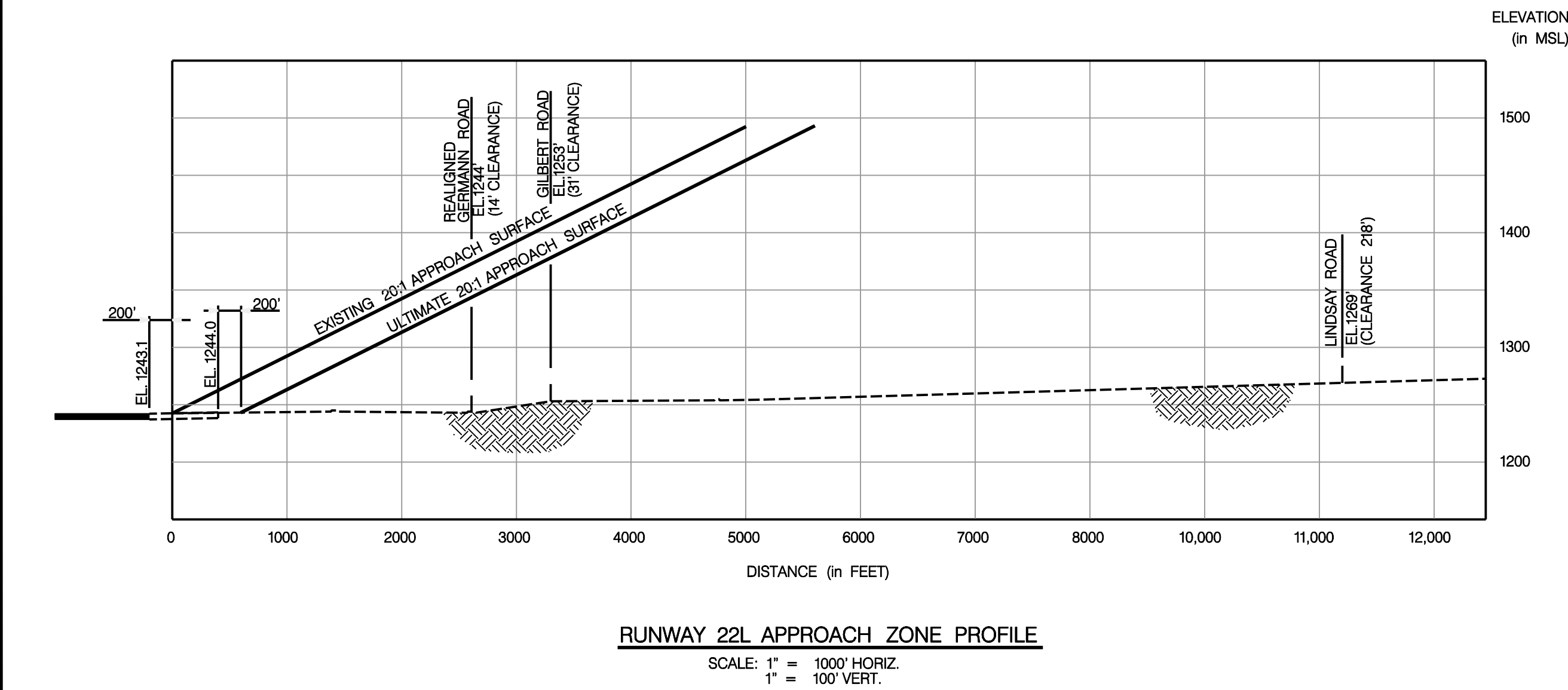
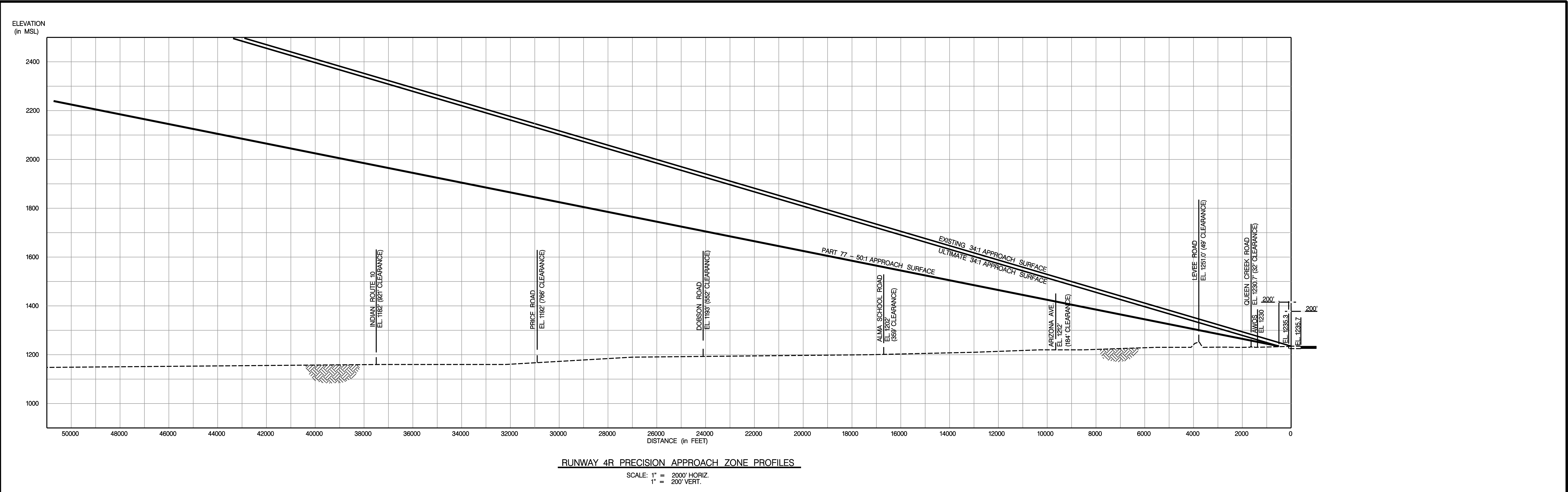

OBSTRUCTION TABLE					
OBJECT DESCRIPTION	OBJECT ELEVATION	OBSTRUCTED PART 77 SURFACE	SURFACE ELEVATION	OBJECT PENETRATION	PROPOSED OBJECT DISPOSITION
NO OBSTRUCTIONS NOTED					

NOTES:

1. TERRAIN PROFILE REPRESENTS THE HIGHEST POINT ACROSS THE WIDTH AND ALONG THE LENGTH OF THE APPROACH SURFACE AND PRIMARY SURFACE.

2. THE TOPOGRAPHICAL BASE (2-FOOT CONTOURS) FOR THE CHANDLER AIRPORT ALP WAS CREATED BY COOPER AERIG OF PHOENIX, INC. USING GROUND SURVEY, FLIGHT SURVEY, AND END ANALYTICS. (DATE: 01-28-1997)

"THE CONTENTS OF THIS PLAN DO NOT NECESSARILY REFLECT THE OFFICIAL VIEWS OR POLICY OF THE FAA OR ADOT AERONAUTICS. ACCEPTANCE OF THIS DOCUMENT BY THE FAA OR ADOT AERONAUTICS DOES NOT IN ANY WAY CONSTITUTE A COMMITMENT ON THE PART OF THE UNITED STATES OR THE STATE OF ARIZONA TO PARTICIPATE IN ANY DEVELOPMENT DEPICTED HEREIN NOR DOES IT INDICATE THAT THE PROPOSED DEVELOPMENT IS ENVIRONMENTALLY ACCEPTABLE IN ACCORDANCE WITH APPROPRIATE PUBLIC LAWS."

REVISIONS:					APPROVALS		PLANS PREPARED BY		PLANS PREPARED FOR		APPROACH ZONE PROFILES	
REV. NO.	BY	APP'D.	DATE	DESCRIPTION OF REVISION								
1		FAA	4-10-92	ALP - CONDITIONAL APPROVAL	SCALE: AS NOTED		 ENGINEERS PLANNERS ECONOMISTS <b>Wilbur Smith Associates</b> 1508 W. TARA DRIVE GILBERT, ARIZONA 85233 PH: 480-775-4344		CHANDLER MUNICIPAL AIRPORT CHANDLER, ARIZONA			
2		FAA	9-23-94	ALP - REVALIDATED								
3		FAA	12-10-99	ALP - REVALIDATED								
4		FAA	5-22-00	ALP - CONDITIONAL APPROVAL								
			--		DESIGNED BY	SP	DATE	11 / 06	PROJECT NO. (CLIENT) <b>AZDOT - E5S64</b>		PROJECT NO. (WSA) <b>A31476</b>	
			--		DRAWN BY	KW	DATE	11 / 06				
			--		CHECKED BY	JM	DATE	12 / 06				



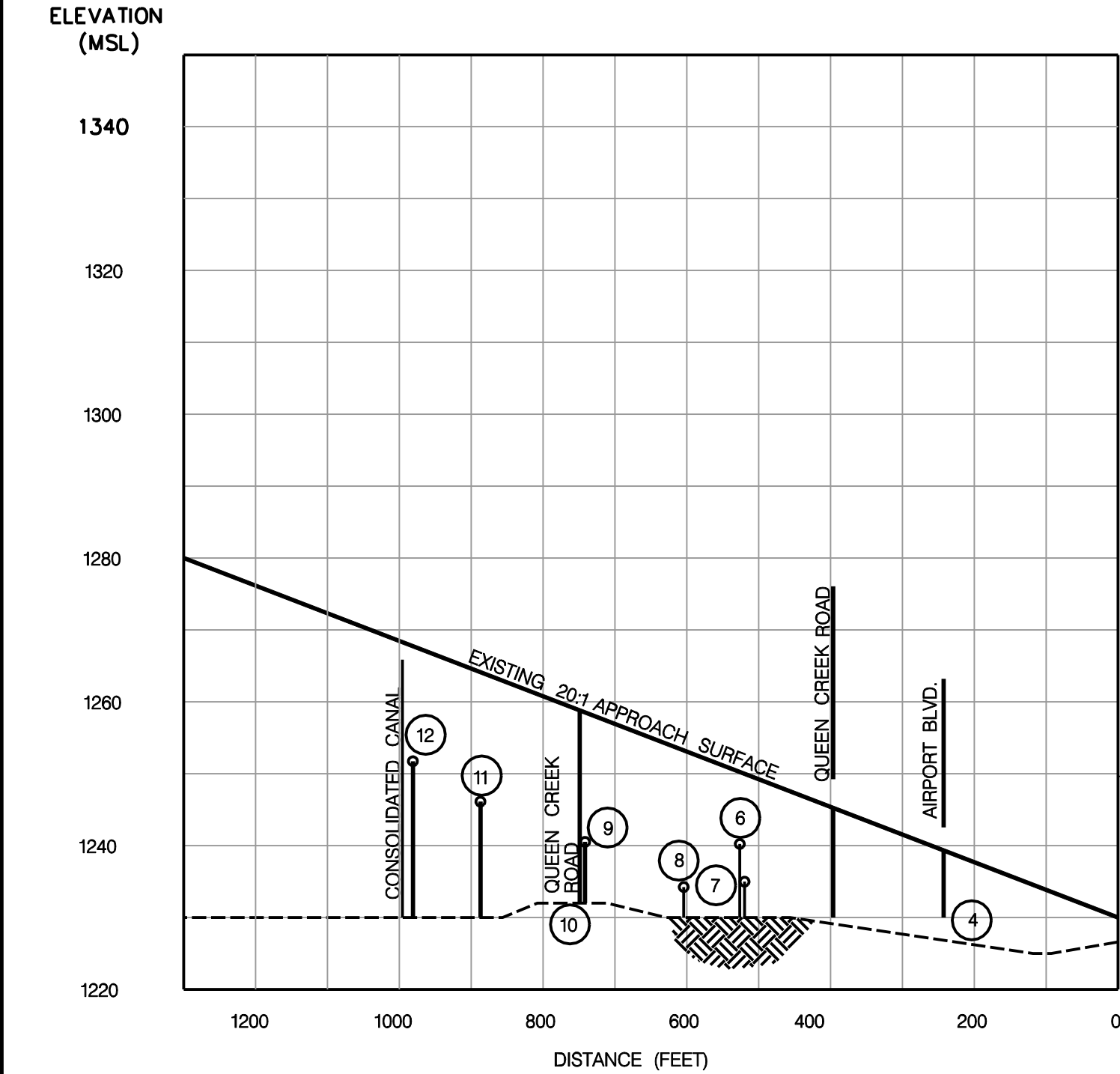
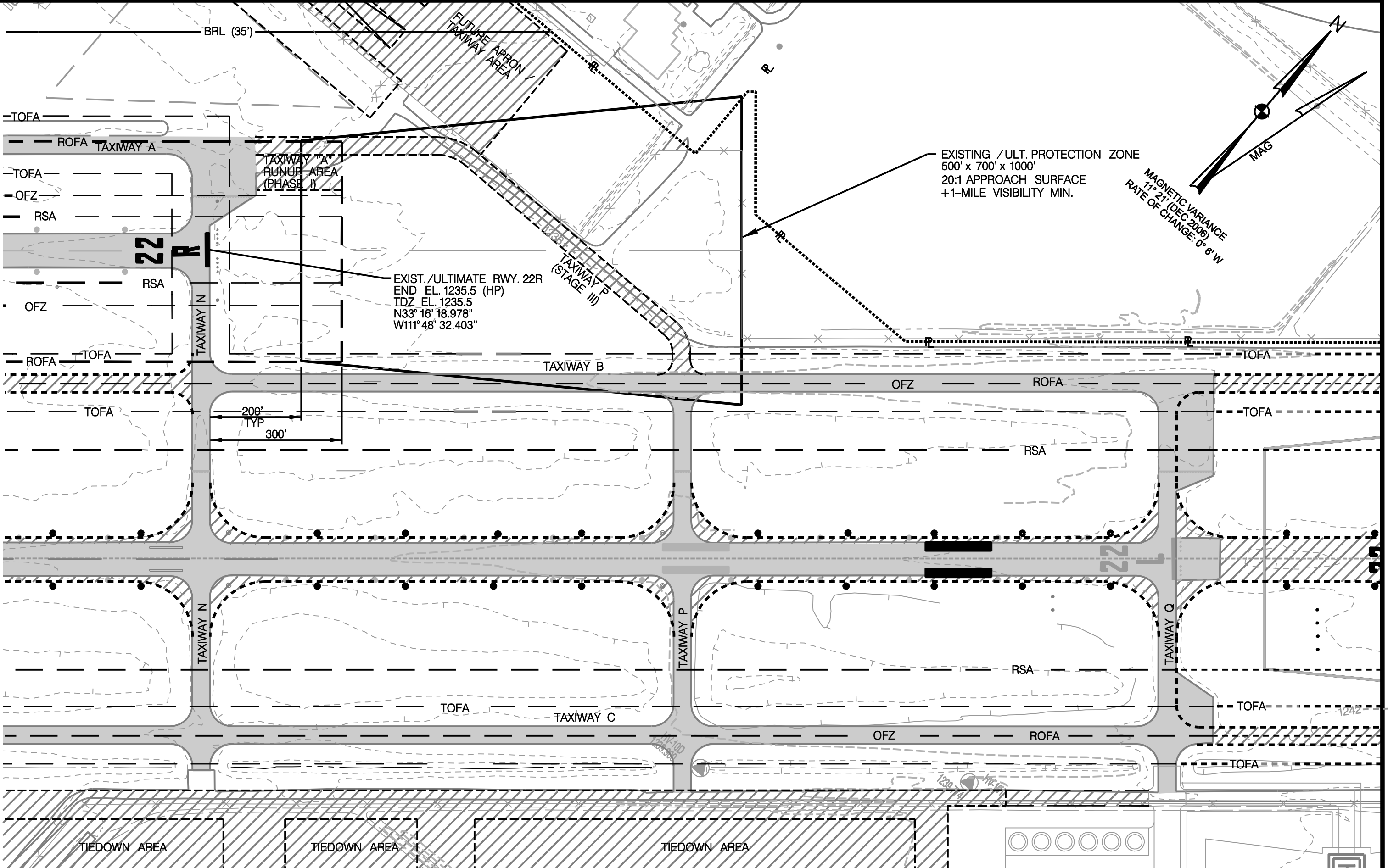
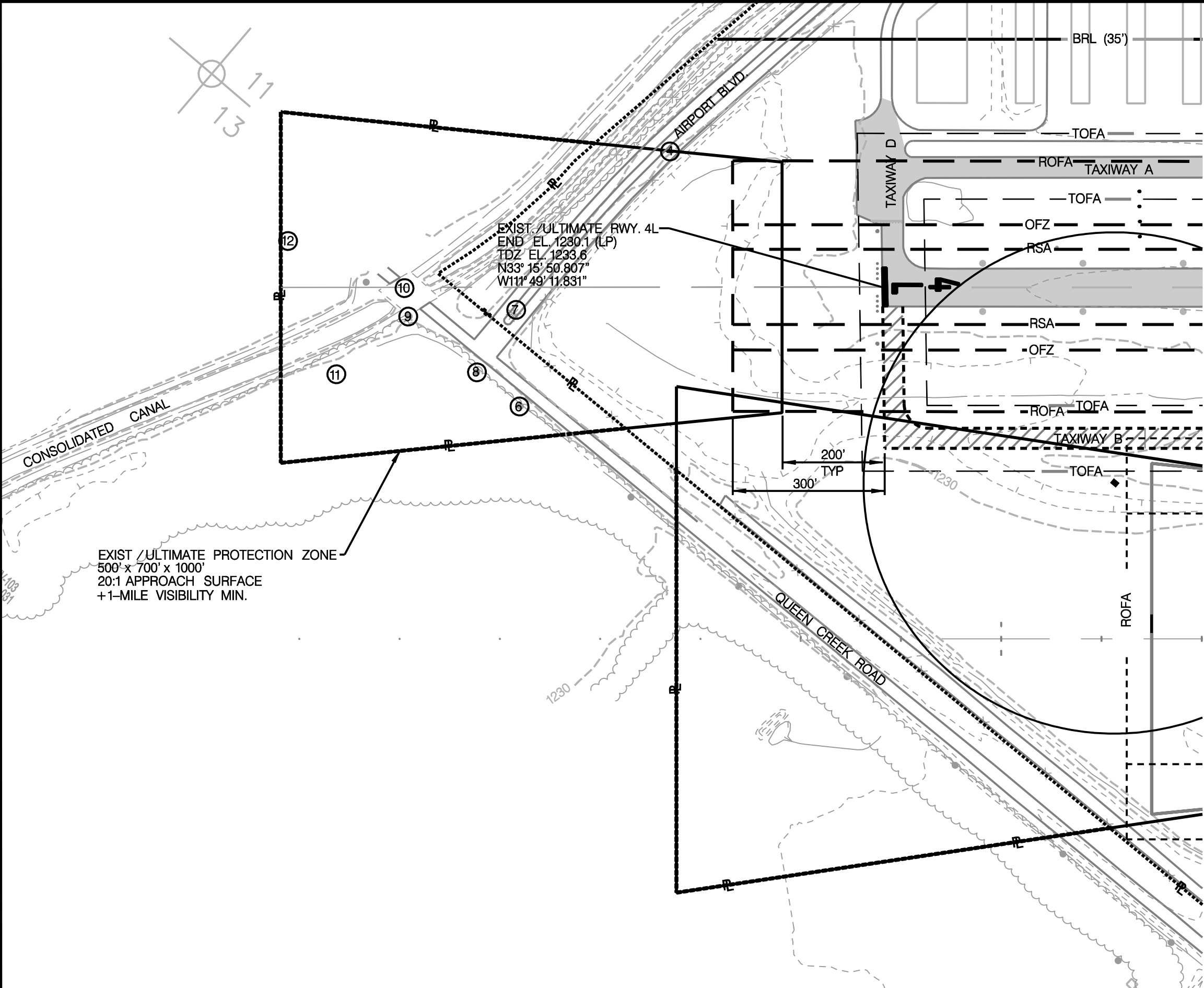

OBSTRUCTION TABLE				
OBSTRUCTION NUMBER	OBJECT DESCRIPTION	ELEVATION (MSL)	SURFACE PENETRATION / CLEARANCE	ULTIMATE OBJECT DISPOSITION
④	AIRPORT BLVD.	1244	9	UNCHANGED
⑥	POLE	1263	32	UNCHANGED
⑦	POLE	1257	26	UNCHANGED
⑧	POLE	1263	32	UNCHANGED
⑨	POLE	1264	33	UNCHANGED
⑩	QUEEN CREEK RD.	1246	15	UNCHANGED
⑪	TREE	1290	59	UNCHANGED
⑫	POLE	1266	35	UNCHANGED

NOAA - NATIONAL GEODETIC SURVEY (4-1-2005)

NO OBSTRUCTIONS - RUNWAY 22R

NOTE:  
TERRAIN PROFILE REPRESENTS THE HIGHEST POINT ACROSS THE  
WIDTH AND ALONG THE LENGTH OF THE APPROACH SURFACE  
AND PRIMARY SURFACE

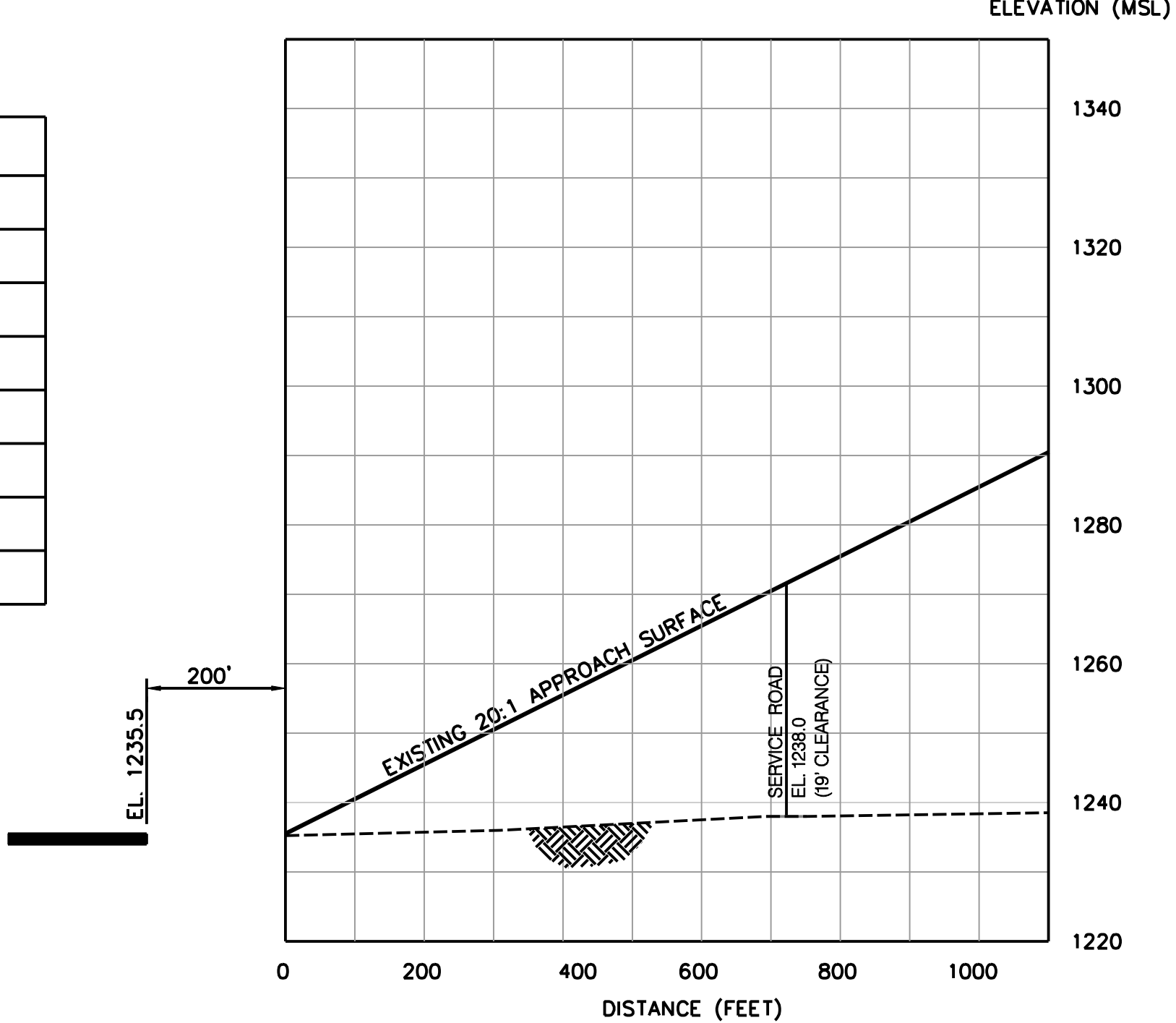

LEGEND		
EXISTING	ULTIMATE	DESCRIPTION
-----	-----	ABANDONED PAVEMENT (To Be Removed)
-----	-----	AIRPORT PROPERTY LINE
-----	-----	AIRPORT REFERENCE POINT (ARP)
-----	-----	AIRPORT ROTATING BEACON
-----	-----	BUILDING ABANDONMENT (To Be Removed)
-----	-----	BUILDINGS
-----	-----	BUILDING RESTRICTION LINE (BRL)
-----	-----	RUNWAY OBJECT FREE AREA
-----	-----	RUNWAY SAFETY AREA
-----	-----	OBJECT FREE ZONE
-----	-----	TAXIWAY SAFETY AREA
-----	-----	TAXIWAY OBJECT FREE AREA
-----	-----	FACILITY CONSTRUCTION
-----	-----	FENCING
-----	-----	NAVIGATIONAL AID INSTALLATION (GVGI)
-----	-----	RUNWAY THRESHOLD LIGHTS and REIL
-----	-----	SECTION CORNER
-----	-----	SEGMENTED CIRCLE/WIND INDICATOR
-----	-----	TOPOGRAPHY (Source: Digital Survey Data)
-----	-----	WIND INDICATOR (Lighted)

DEVELOPMENT STAGES		
STAGE I 0-5 YEARS	STAGE II 6-10 YEARS	STAGE III 11-20 YEARS

REVISIONS:				
REV. NO.	BY	APP'D.	DATE	DESCRIPTION OF REVISION
1		FAA	4-10-92	ALP - CONDITIONAL APPROVAL
2		FAA	9-23-94	ALP - REVALIDATED
3		FAA	12-10-99	ALP - REVALIDATED
4		FAA	5-22-00	ALP - CONDITIONAL APPROVAL
			--	
			--	
			--	

SCALE: 1" = 200' HORIZ 1" = 20' VERT			
DESIGNED BY	SP	DATE	11 / 06
DRAWN BY	KW	DATE	11 / 06
CHECKED BY	JM	DATE	12 / 06

APPROVALS	

PLANS PREPARED BY

 ENGINEERS  
PLANNERS  
ECONOMISTS

**Wilbur Smith Associates**  
1508 W. TARA DRIVE  
GILBERT, ARIZONA 85233  
PH: 480-775-4344

PLANS PREPARED FOR	
CHANDLER MUNICIPAL AIRPORT CHANDLER, ARIZONA	
PROJECT NO. (CLIENT)	PROJECT NO. (WSA)
AZDOT - E5S64	A31476

RUNWAY PROTECTION ZONES PLAN AND PROFILE RUNWAY 4L-22R	
	NO. 7



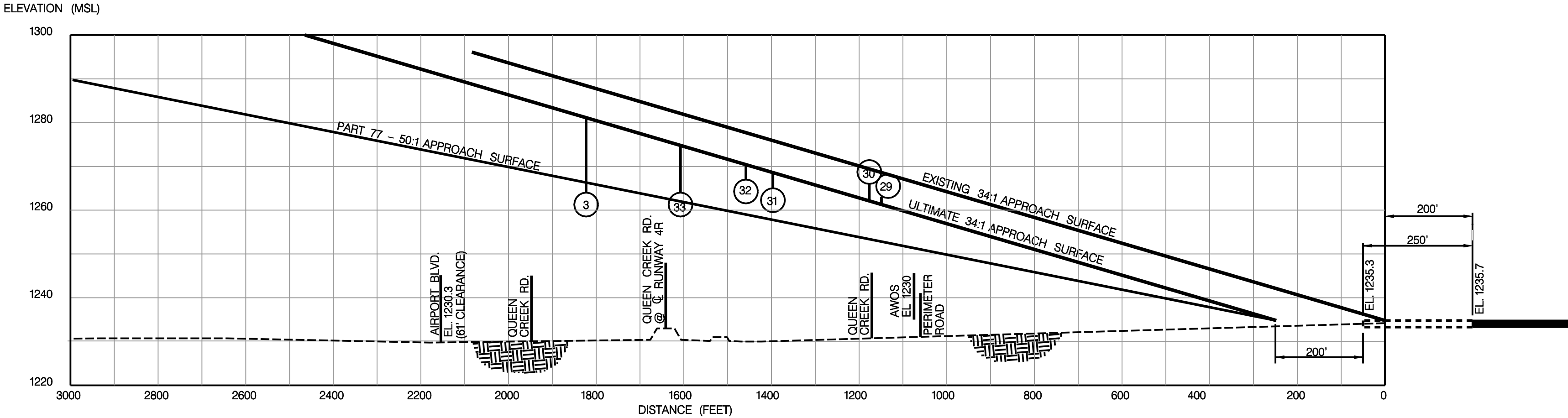
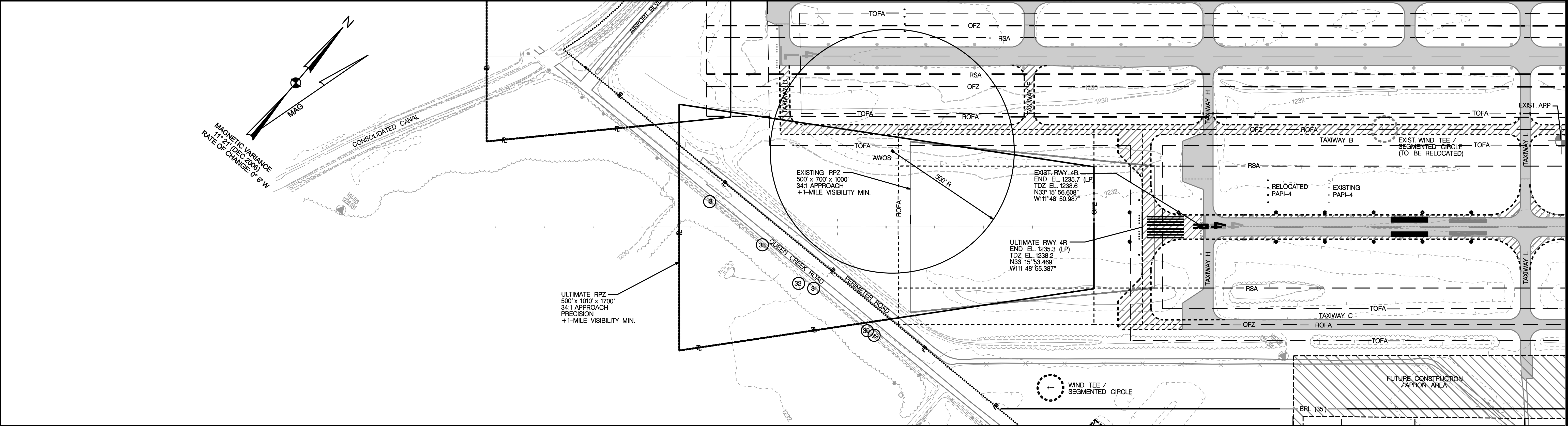

OBSTRUCTION TABLE

OBSTRUCTION NUMBER	OBJECT DESCRIPTION	ELEVATION (MSL)	SURFACE PENETRATION / CLEARANCE	ULTIMATE OBJECT DISPOSTION
③	POLE	1264	9	UNCHANGED
②9	CATENARY	1263	4	UNCHANGED
③0	POLE	1266	7	UNCHANGED
③1	POLE	1265	2	UNCHANGED
③2	TREE	1267	3	REMOVE
③3	POLE	1264	-4	REMOVE

NOAA – NATIONAL GEODETIC SURVEY (4-1-2005)

NOTES:  
1. TERRAIN PROFILE REPRESENTS THE HIGHEST POINT ACROSS THE WIDTH AND ALONG THE LENGTH OF THE APPROACH SURFACE AND PRIMARY SURFACE.  
2. THE TOPOGRAPHICAL BASE (2-FOOT CONTOURS) FOR THE CHANDLER AIRPORT ALP WAS CREATED BY COOPER AERIGI OF PHOENIX, INC. USING GROUND SURVEY, FLIGHT SURVEY, AND END ANALYTICS. (DATE: 01-28-1997)

"THE CONTENTS OF THIS PLAN DO NOT NECESSARILY REFLECT THE OFFICIAL VIEWS OR POLICY OF THE FAA OR ADOT AERONAUTICS. ACCEPTANCE OF THIS DOCUMENT BY THE FAA OR ADOT AERONAUTICS DOES NOT IN ANY WAY CONSTITUTE A COMMITMENT ON THE PART OF THE UNITED STATES OR THE STATE OF ARIZONA TO PARTICIPATE IN ANY DEVELOPMENT DEPICTED HEREIN NOR DOES IT INDICATE THAT THE PROPOSED DEVELOPMENT IS ENVIRONMENTALLY ACCEPTABLE IN ACCORDANCE WITH APPROPRIATE PUBLIC LAWS."

LEGEND		
EXISTING	ULTIMATE	DESCRIPTION
		ABANDONED PAVEMENT (To Be Removed)
		AIRPORT PROPERTY LINE
		AIRPORT REFERENCE POINT (ARP)
		AIRPORT ROTATING BEACON
		BUILDING ABANDONMENT (To Be Removed)
		BUILDINGS
		BUILDING RESTRICTION LINE (BRL)
		RUNWAY OBJECT FREE AREA
		RUNWAY SAFETY AREA
		OBJECT FREE ZONE
		TAXIWAY SAFETY AREA
		TAXIWAY OBJECT FREE AREA
		FACILITY CONSTRUCTION
		FENCING
		NAVIGATIONAL AID INSTALLATION (GVGI)
		RUNWAY THRESHOLD LIGHTS and REIL
		SECTION CORNER
		SEGMENTED CIRCLE/WIND INDICATOR
		TOPOGRAPHY (Source: Digital Survey Data)
		WIND INDICATOR (Lighted)
DEVELOPMENT STAGES		
STAGE I 0-5 YEARS	STAGE II 6-10 YEARS	STAGE III 11-20 YEARS

REVISIONS:				
REV. NO.	BY	APP'D.	DATE	DESCRIPTION OF REVISION
1		FAA	4-10-92	ALP – CONDITIONAL APPROVAL
2		FAA	9-23-94	ALP – REVALIDATED
3		FAA	12-10-99	ALP – REVALIDATED
4		FAA	5-22-00	ALP – CONDITIONAL APPROVAL
			--	
			--	
			--	

SCALE: 1" = 200' HORIZ 1" = 20' VERT			
DESIGNED BY	SP	DATE	11 / 06
DRAWN BY	KW	DATE	11 / 06
CHECKED BY	JM	DATE	12 / 06

APPROVALS	

PLANS PREPARED BY



ENGINEERS  
PLANNERS  
ECONOMISTS

**Wilbur Smith Associates**  
1508 W. TARA DRIVE  
GILBERT, ARIZONA 85233  
PH: 480-775-4344

PLANS PREPARED FOR	
CHANDLER MUNICIPAL AIRPORT CHANDLER, ARIZONA	
PROJECT NO. (CLIENT) AZDOT – E5S64	PROJECT NO. (WSA) A31476

RUNWAY PROTECTION ZONE  
PLAN AND PROFILE  
RUNWAY 4R

NO. 5

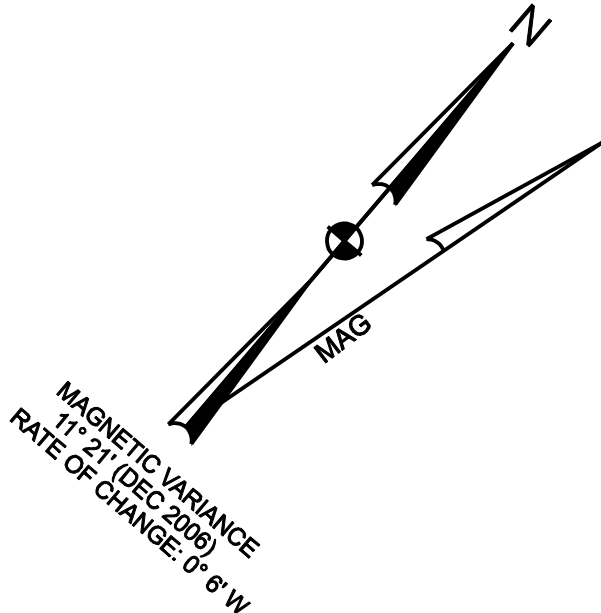
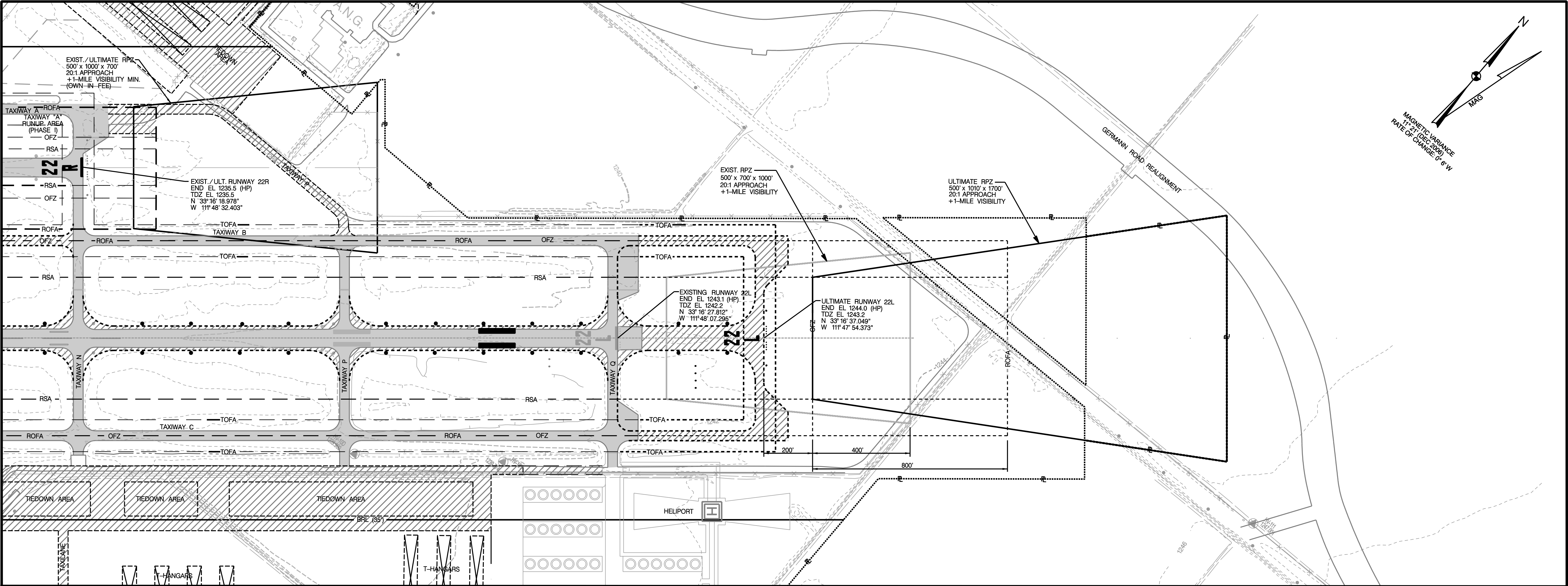

LEGEND		
EXISTING	ULTIMATE	DESCRIPTION
		ABANDONED PAVEMENT (To Be Removed)
		AIRPORT PROPERTY LINE
		AIRPORT REFERENCE POINT (ARP)
		AIRPORT ROTATING BEACON
		BUILDING ABANDONMENT (To Be Removed)
		BUILDINGS
BRL	BRL	BUILDING RESTRICTION LINE (BRL)
ROFA	ROFA	RUNWAY OBJECT FREE AREA
RSA	RSA	RUNWAY SAFETY AREA
OFZ	OFZ	OBJECT FREE ZONE
TSA	TSA	TAXIWAY SAFETY AREA
TOFA	TOFA	TAXIWAY OBJECT FREE AREA
		FACILITY CONSTRUCTION
		FENCING
VASI-4	PAPI-4	NAVIGATIONAL AID INSTALLATION (GVGI)
		RUNWAY THRESHOLD LIGHTS and REIL
		SECTION CORNER
		SEGMENTED CIRCLE/WIND INDICATOR
		TOPOGRAPHY (Source: Digital Survey Data)
		WIND INDICATOR (Lighted)

DEVELOPMENT STAGES		
STAGE I 0-5 YEARS	STAGE II 6-10 YEARS	STAGE III 11-20 YEARS

REVISIONS:				
REV. NO.	BY	APP'D.	DATE	DESCRIPTION OF REVISION
1		FAA	4-10-92	ALP - CONDITIONAL APPROVAL
2		FAA	9-23-94	ALP - REVALIDATED
3		FAA	12-10-99	ALP - REVALIDATED
4		FAA	5-22-00	ALP - CONDITIONAL APPROVAL
			--	
			--	
			--	

SCALE: 1" = 200' HORIZ 1" = 20' VERT			
DESIGNED BY	SP	DATE	11 / 06
DRAWN BY	KW	DATE	11 / 06
CHECKED BY	JM	DATE	12 / 06

APPROVALS	

PLANS PREPARED BY



ENGINEERS  
PLANNERS  
ECONOMISTS

**Wilbur Smith Associates**  
1508 W. TARA DRIVE  
GILBERT, ARIZONA 85233  
PH: 480-775-4344

PLANS PREPARED FOR

CHANDLER MUNICIPAL AIRPORT  
CHANDLER, ARIZONA

PROJECT NO. (CLIENT)	PROJECT NO. (WSA)
AZDOT - E5S64	A31476

RUNWAY PROTECTION ZONE  
PLAN AND PROFILE  
RUNWAY 22L

	NO. 6
--	-------

NO OBSTRUCTIONS ON RUNWAY 22L

NOTES:  
1. TERRAIN PROFILE REPRESENTS THE HIGHEST POINT ACROSS THE WIDTH AND ALONG THE LENGTH OF THE APPROACH SURFACE AND PRIMARY SURFACE.  
2. THE TOPOGRAPHICAL BASE (2-FOOT CONTOURS) FOR THE CHANDLER AIRPORT ALP WAS CREATED BY COOPER AERIGI OF PHOENIX, INC. USING GROUND SURVEY, FLIGHT SURVEY, AND END ANALYTICS. (DATE: 01-28-1997)

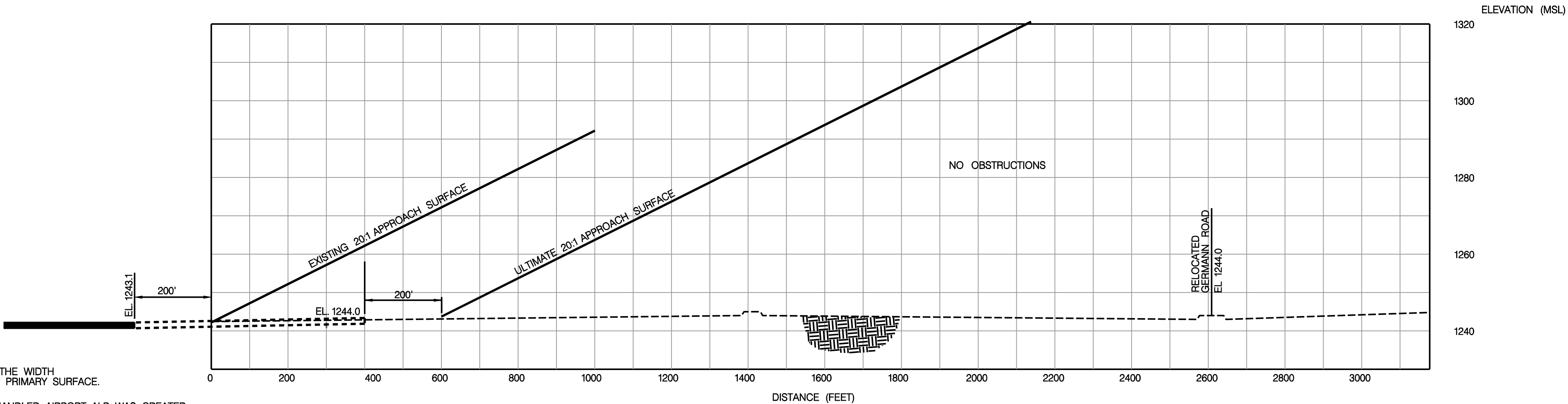

"THE CONTENTS OF THIS PLAN DO NOT NECESSARILY REFLECT THE OFFICIAL VIEWS OR POLICY OF THE FAA OR ADOT AERONAUTICS. ACCEPTANCE OF THIS DOCUMENT BY THE FAA OR ADOT AERONAUTICS DOES NOT IN ANY WAY CONSTITUTE A COMMITMENT ON THE PART OF THE UNITED STATES OR THE STATE OF ARIZONA TO PARTICIPATE IN ANY DEVELOPMENT DEPICTED HEREIN NOR DOES IT INDICATE THAT THE PROPOSED DEVELOPMENT IS ENVIRONMENTALLY ACCEPTABLE IN ACCORDANCE WITH APPROPRIATE PUBLIC LAWS."



DEED RECORDING INFORMATION (COUNTY ASSESSOR – MARICOPA COUNTY, AZ)					
OWNER: PARCEL NUMBER	ACREAGE	DEED DATE	RECORDING INFORMATION	GRANTOR / DEED TYPE	FAAP/ADAP/AIP GRANT ACCEPTANCE
City of Chandler 303-32-001	40	5-28-1948	Deed #: NOD-44446 Book: 303 Map: 32 Parcel: 1	State of Arizona / Warranty	FAAP 9-02-008-8604 7-14-1959
City of Chandler 303-32-002	39	5-28-1948	Deed #: NOD-44447 Book: 303 Map: 32 Parcel: 2	State of Arizona / Warranty	FAAP 9-02-008-8604 7-14-1959
City of Chandler 303-32-003	38.96	5-28-1948	Deed #: NOD-44448 Book: 303 Map: 32 Parcel: 3	State of Arizona / Warranty	FAAP 9-02-008-8604 7-14-1959
City of Chandler 303-32-005	39	5-28-1948	Deed #: NOD-44445 Book: 303 Map: 32 Parcel: 5	State of Arizona / Warranty	FAAP 9-02-008-8604 7-14-1959
City of Chandler 303-32-009B	21.043	3-31-1988	Deed #: 880150742 Book: 303 Map: 32 Parcel: 009B	John Demetria LTD. / Warranty	AIP-3-04-0008-04 8-25-1987
City of Chandler 303-32-009C	35.702	1-26-1994	Deed #: 9400066751 Book: 303 Map: 32 Parcel: 009C	Airpark Associates LTD. Liability Company / Warranty	AIP-3-04-0008-09 9-23-1993
City of Chandler 303-32-011C	6.625	10-24-1985	Deed #: 860101579 Book: 303 Map: 32 Parcel: 011C	Roosevelt Water Conservation District / Warranty	—
City of Chandler 303-32-012L	31.8	1-27-1975	Deed #: 11009-0175 Book: 303 Map: 32 Parcel: 012L	Roosevelt Water Conservation District / Warranty	AIP-3-04-0008-01 9-24-1984
City of Chandler 303-32-012M	7.83	9-6-1987	Deed #: 870499012 Book: 303 Map: 32 Parcel: 012M	Queen Creek Trust / Warranty	AIP-3-04-0008-03 9-26-1986
City of Chandler 303-32-012Q	6	12-31-1986	Deed #: 860733678 Book: 303 Map: 32 Parcel: 012Q	D.J. Patterson / Warranty	AIP-3-04-0008-07 7-25-1991
City of Chandler 303-32-012R	8.914	12-31-1986	Deed #: 860733678 Book: 303 Map: 32 Parcel: 012R	D.J. Patterson / Warranty	ADAP-5-04-0008-02 9-30-1978
City of Chandler 303-32-012T	44.834	3-3-1986	Deed #: 860101579 Book: 303 Map: 32 Parcel: 012T	Roosevelt Water Conservation District / Warranty	AIP-3-04-0008-06 5-18-1989
City of Chandler 303-32-013J	24.65	5-29-2002	Deed #: 887110100 Book: 303 Map: 32 Parcel: 013J	AJ Chandler Air Park LLC / Warranty	AIP-3-04-0008-11 ADOT E1135 ADOT E1102 7-14-2000, 7-1-2000, and 4-2-2001
City of Chandler 303-32-013K	0.21	5-29-2002	Deed #: 887110100 Book: 303 Map: 32 Parcel: 013K	AJ Chandler Air Park LLC / Warranty	AIP-3-04-0008-11 ADOT E1135 ADOT E1102 7-14-2000, 7-1-2000, and 4-2-2001
City of Chandler 303-32-013L	0.71	5-29-2002	Deed #: 887110100 Book: 303 Map: 32 Parcel: 013L	AJ Chandler Air Park LLC / Warranty	AIP-3-04-0008-11 ADOT E1135 ADOT E1102 7-14-2000, 7-1-2000, and 4-2-2001
City of Chandler 303-32-013M	0.43	5-29-2002	Deed #: 887110100 Book: 303 Map: 32 Parcel: 013M	AJ Chandler Air Park LLC / Warranty	AIP-3-04-0008-11 ADOT E1135 ADOT E1102 7-14-2000, 7-1-2000, and 4-2-2001
City of Chandler 303-32-013N	2.11	5-29-2002	Deed #: 887110100 Book: 303 Map: 32 Parcel: 013N	AJ Chandler Air Park LLC / Warranty	AIP-3-04-0008-11 ADOT E1135 ADOT E1102 7-14-2000, 7-1-2000, and 4-2-2001
City of Chandler 303-32-014C	19.536	1-4-1993	Deed #: 930000184 Book: 303 Map: 32 Parcel: 014C	D.W. Patterson / Warranty	AIP-3-04-0008-06 5-18-1989
City of Chandler 303-31-001H	1.464	11-2-87	Deed #: 870666054 Book: 303 Map: 31 Parcel: 001H	Spitler /Warranty	AIP-3-04-0008-03 9-25-1986
City of Chandler 303-31-001N	22.076	9-12-1994	Deed #: 940672607 Book: 303 Map: 31 Parcel: 001N	R & E Farms /Special Warranty Deed	AIP-3-04-0008-08 6-25-1992
City of Chandler 303-31-009F	6.971	6-10-1988	Deed #: 880282164 Book: 303 Map: 31 Parcel: 009F	Chandler Airpark Limited Partnership /Warranty	AIP-3-04-0008-04 8-25-1987
City of Chandler 303-31-013C	1.72	1-4-1993	Deed #: 930000185 Book: 303 Map: 31 Parcel: 013C	C. Max Killian /Special Warranty Deed	AIP-3-04-0008-08 6-25-1992
City of Chandler 303-31-014A	46.589	6-11-1993	Deed #: 930370306 Book: 303 Map: 31 Parcel: 014C	D.W. Patterson / Special Warranty Deed	AIP-3-04-0008-08 6-25-1992
City of Chandler 303-31-015B	70	9-2-1988	Deed #: 880437911 Book: 303 Map: 31 Parcel: 015B	D.W. Patterson / Warranty	AIP-3-04-0008-08 8-25-1987 and 6-23-1988
City of Chandler 303-31-015D	3	8-31-1990	Deed #: 900394579 Book: 303 Map: 31 Parcel: 015D	D.W. Patterson / Warranty	AIP-3-04-0008-06 5-18-1989
City of Chandler 303-31-015E	6.728	8-31-1990	Deed #: 900394580 Book: 303 Map: 31 Parcel: 015E	D.W. Patterson / Warranty	AIP-3-04-0008-06 5-18-1989
City of Chandler 303-30-002B	2.416	7-7-1988	Deed #: 880330730 Book: 303 Map: 30 Parcel: 002B	Exeter Real Estate Investors / Warranty	AIP-3-04-0008-04 8-25-1987
City of Chandler 303-30-007B	4.16	7-22-1988	Deed #: 880360384 Book: 303 Map: 30 Parcel: 007B	D.W. Patterson / Warranty	AIP-3-04-0008-105 6-23-1988
Total Acreage	532.478	Note: The total acreage shown in this table is the cumulative sum of the above described parcels, whose acreages were obtained from legal descriptions and other legal documents obtained through the title search, referred to in the "Notice" block.			

REVISIONS:				
REV. NO.	BY	APP'D.	DATE	DESCRIPTION OF REVISION
1	FAA		4-10-92	ALP – CONDITIONAL APPROVAL
2	FAA		9-23-94	ALP – REVALIDATED
3	FAA		12-10-99	ALP – REVALIDATED
4	FAA		5-22-00	ALP – CONDITIONAL APPROVAL
			--	
			--	
			--	

500 0 500 1000 1500			
SCALE: 1" = 500'			
DESIGNED BY	SP	DATE	11 / 06
DRAWN BY	KW	DATE	11 / 06
CHECKED BY	JM	DATE	12 / 06

APPROVALS	

PLANS PREPARED BY



ENGINEERS  
PLANNERS  
ECONOMISTS

**Wilbur Smith Associates**  
1508 W. TARA DRIVE  
GILBERT, ARIZONA 85233  
PH: 480-775-4344

PLANS PREPARED FOR	
CHANDLER MUNICIPAL AIRPORT CHANDLER, ARIZONA	
PROJECT NO. (CLIENT)	PROJECT NO. (WSA)
AZDOT – E5S64	A31476

LEGEND		
EXISTING	ULTIMATE	DESCRIPTION
-----	-----	ABANDONED PAVEMENT (To Be Removed)
-----	-----	AIRPORT PROPERTY LINE
-----	-----	AIRPORT REFERENCE POINT (ARP)
-----	-----	AIRPORT ROTATING BEACON
-----	-----	BUILDING ABANDONMENT (To Be Removed)
-----	-----	BUILDINGS
-----	-----	BUILDING RESTRICTION LINE (BRL)
-----	-----	RUNWAY OBJECT FREE AREA
-----	-----	RUNWAY SAFETY AREA
-----	-----	OBJECT FREE ZONE
-----	-----	TAXIWAY SAFETY AREA
-----	-----	TAXIWAY OBJECT FREE AREA
-----	-----	FACILITY CONSTRUCTION
-----	-----	FENCING
-----	-----	NAVIGATIONAL AID INSTALLATION (GVGI)
-----	-----	RUNWAY THRESHOLD LIGHTS and REIL
-----	-----	SECTION CORNER
-----	-----	SEGMENTED CIRCLE/WIND INDICATOR
-----	-----	TOPOGRAPHY (Source: Digital Survey Data)
-----	-----	WIND INDICATOR (Lighted)