

LEGEND

	Airport Property Line
	Runway Pavement
	Existing Taxiway and Apron Pavement
	Future Pavement (Taxiway)
	Future Pavement (Apron)
	Future Pavement (Parking and Circulation)
	Future General Aviation Development
	Future Aviation Facilities Development
	Airport Reference Point (ARP)
	Airport Rotating Beacon
	Existing Building
	Future Building Expansion
	Building Restriction Line (BRL)
	Runway Protection Zone (RPZ)
	Obstacle Free Zone (OFZ)
	Runway Safety Area (RSA)
	Runway Object Free Area (ROFA)
	Precision Object Free Area (POFZ)
	ILS Localizer and Glideslope Critical Areas
	Fencing
	Precision Approach Path Indicator (PAPI)
	Runway Threshold Lights
	Topographic Contours
	Wind Cone
	Optical Landing System (OLS)
	Touchdown Reflector
	Radar Reflector
	Runway End Identification Lights (REIL)
	Runway Visual Zone (RVZ)
	Part 77 Surface
	Water
	Arresting Gear
	Section Corner

BUILDINGS/FACILITIES

Number	Description	Building Elevation
(1)	Passenger Terminal/YCAA Administration	221.2'
(2)	Rental Car Maintenance Facility	230.3'
(3)	Public Parking Toll Booths	216.3'
(4)	FAA Airways Facilities Office	211.1'
(5)	Yuma County Airport Authority (YCAA)	211.1'
(6)	YCAA - Northwest GA Hangar Facility	210.2'
(7)	CareFlight	213.5'
(8)	CareFlight Above Ground Fuel Storage Facility	194.6'
(9)	Fortuna/J-Mar	210.8'
(10)	Number Not Used	N/A
(11)	Aircraft Wash Facility	199.9'
(12)	YCAA - West GA Hangar Facility	212.0'
(13)	YCAA - West GA Hangar Facility, T-Shape Hangars	202.6'
(14)	Maintenance Hangar	202.0'
(15)	Yuma Pilots Center	206.5'
(16)	Underground Fuel Storage Facility	197.7'
(17)	Storage Hangar	209.4'
(18)	GA Public Apron	N/A
(19)	YCAA - Aviation Facilities	204.4'
(20)	YCAA - 40th Street Apron	N/A
(21)	YCAA - West Visiting Aircraft Line	186.9'
(22)	Navy Transceiver (Non-YCAA)	205.4'
(23)	Number Not Used	N/A
(24)	Localizer Antenna	
(25)	MDC Localizer Antenna	
(26)	FedEx Building (Future)	
(27)	YCAA Pappy Boyington Hangar	210.0'
(28)	Aviation Facilities Apron (Future)	
(29)	Defense Contractor Complex Apron (DCC)	

OBSTRUCTION TABLE

NO.	OBJECT	TOP ELEVATION (ft - AMSL)	PART 77 PENETRATION (ft)	RESOLUTION
(A)	Tree	250.9'	0.5'	Trim/Remove
(B)	Terrain	250.0'	5.4'	N/A
(C)	Tree	272.5'	22.2'	Trim/Remove
(D)	Road	208.0'	3.4'	TBD
(E)	Tree Cluster	213.1'	6.4'	TBD

NOTE:
 1. Obstruction A located outside of exhibit boundary. See sheet 6.
 2. Obstruction D and obstruction E do not penetrate the existing Runway 8 "Visual" Part 77 20:1 surface. However, these objects would penetrate the Part 77 34:1 surface at such time Runway 8 upgrades to Ultimate non-precision instrument approach.
 3. Obstruction B penetrates military ADC surface only.

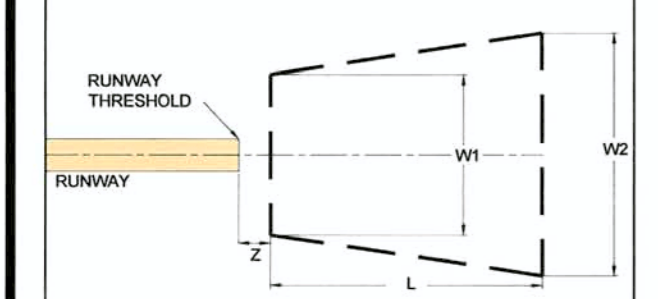

RUNWAY PROTECTION ZONE (RPZ) TABLE

RUNWAY	VISIBILITY MINIMUMS	W1	W2	L	Z
8	Visual	500	700	1,000	200
26	Visual	500	700	1,000	200
17	1-Mile	500	700	1,000	200
35	Visual	500	700	1,000	200
3R	1-Mile	500	1,010	1,700	200
21L	1-Mile	500	1,010	1,700	200
3L	1/2-Mile ^{1/}	1,500	1,750	2,500	200
21R	1/2-Mile	1,500	1,750	2,500	200

1/ Runway 3L approach visibility minimum for military only.

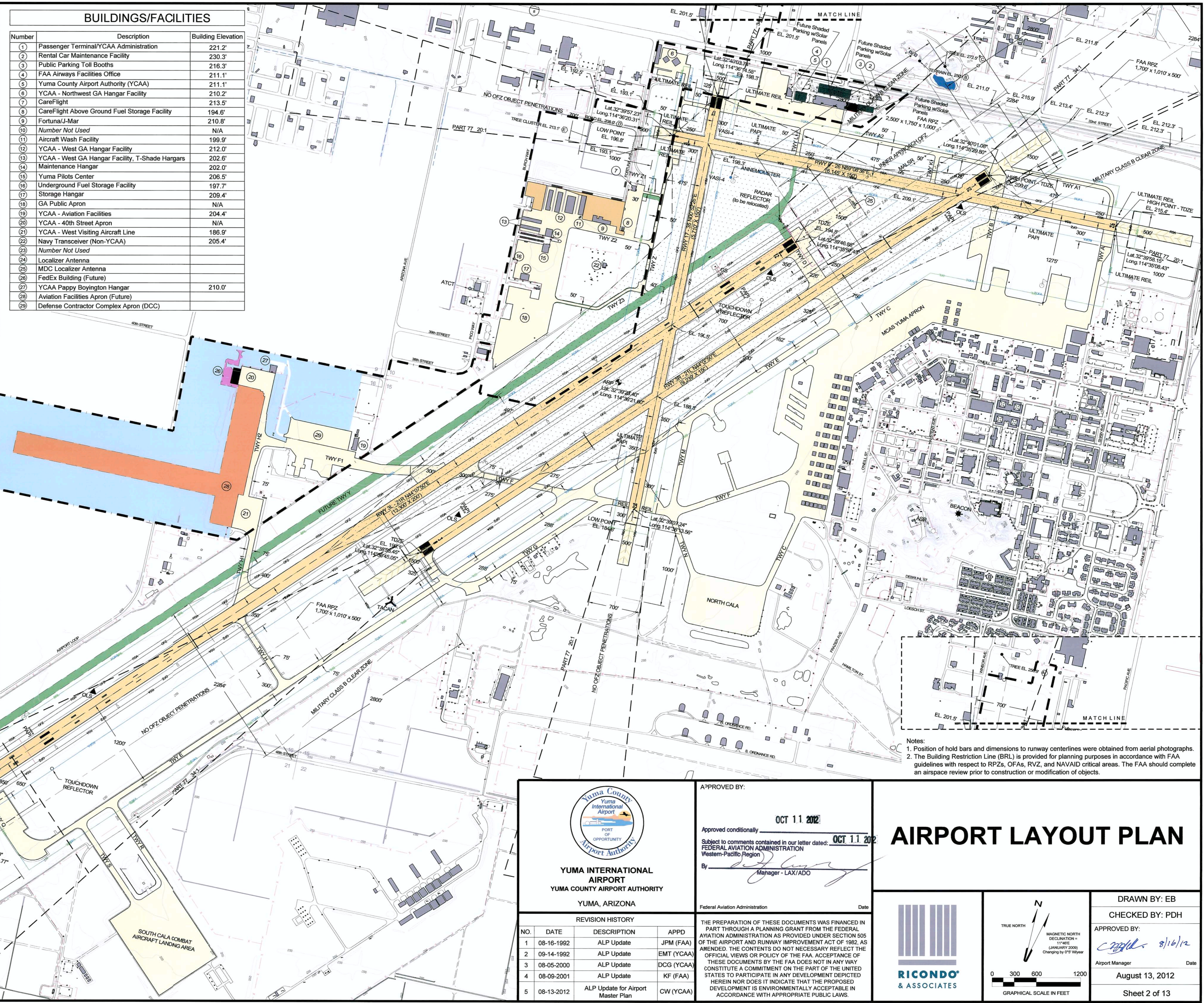

Notes:
 1. Position of hold bars and dimensions to runway centerlines were obtained from aerial photographs.
 2. The Building Restriction Line (BRL) is provided for planning purposes in accordance with FAA guidelines with respect to RPZs, OFAs, RVZ, and NAVAID critical areas. The FAA should complete an airspace review prior to construction or modification of objects.

Drawing: Z:\YUMA\ALP Update 2011\Sheet 2 - ALP.dwg, Layout: 24x36, Aug 13, 2012, 3:00pm

YUMA INTERNATIONAL AIRPORT
 YUMA COUNTY AIRPORT AUTHORITY
 YUMA, ARIZONA

APPROVED BY:

 Manager - LAX/ADO

Approved conditionally
 Subject to comments contained in our letter dated: **OCT 11 2012**
 FEDERAL AVIATION ADMINISTRATION
 Western-Pacific Region

AIRPORT LAYOUT PLAN

DRAWN BY: EB
 CHECKED BY: PDH
 APPROVED BY:

 Airport Manager
 August 13, 2012
 Sheet 2 of 13

REVISION HISTORY

NO.	DATE	DESCRIPTION	APPD
1	08-16-1992	ALP Update	JPM (FAA)
2	09-14-1992	ALP Update	EMT (YCAA)
3	08-05-2000	ALP Update	DCG (YCAA)
4	08-09-2001	ALP Update	KF (FAA)
5	08-13-2012	ALP Update for Airport Master Plan	CW (YCAA)

Federal Aviation Administration Date

THE PREPARATION OF THESE DOCUMENTS WAS FINANCED IN PART THROUGH A PLANNING GRANT FROM THE FEDERAL AVIATION ADMINISTRATION AS PROVIDED UNDER SECTION 505 OF THE AIRPORT AND RUNWAY IMPROVEMENT ACT OF 1982, AS AMENDED. THE CONTENTS DO NOT NECESSARILY REFLECT THE OFFICIAL VIEWS OR POLICY OF THE FAA. ACCEPTANCE OF THESE DOCUMENTS BY THE FAA DOES NOT IN ANY WAY CONSTITUTE A COMMITMENT ON THE PART OF THE UNITED STATES TO PARTICIPATE IN ANY DEVELOPMENT DEPICTED HEREIN NOR DOES IT INDICATE THAT THE PROPOSED DEVELOPMENT IS ENVIRONMENTALLY ACCEPTABLE IN ACCORDANCE WITH APPROPRIATE PUBLIC LAWS.

TRUE NORTH
 MAGNETIC NORTH DECLINATION = 11°45' (JANUARY 2009) Changing by 0.5" W/year

0 300 600 1200
 GRAPHICAL SCALE IN FEET