

RUNWAY DATA		5/23	5/23
		EXISTING (E)	FUTURE (F)
APPROACH TYPE/ VISIBILITY MINIMUMS	TRW 5 TRW 23	Visual, Utility/ VR	NIP, >Utility/ 1-Mile
FAR PART 77 APPROACH SLOPE		TRW 5 - 20:1 TRW 23 - 20:1	TRW 5 - 34:1 TRW 23 - 34:1
RUNWAY LENGTH		7,100'	7,100'
RUNWAY WIDTH		75'	75'
PAVEMENT TYPE		ASPHALT	ASPHALT
PAVEMENT STRENGTH (LBS)		12,500 SW	30,000 SW/ 45,000 DG
RUNWAY LIGHTING		MIR	MIR
RUNWAY MARKING		TRW 5- NIP TRW 23- NIP	TRW 5- NIP TRW 23- NIP
% EFFECTIVE GRADIENT		1.00 %	1.00 %
% MAXIMUM GRADE		1.00 %	1.00 %
LINE OF SITE REQUIREMENTS MET		YES	YES
VISUAL AIDS		TRW 5: PAPI-2 TRW 23: PAPI-2	TRW 5: PAPI-2 TRW 23: PAPI-2
NAVIGATIONAL AIDS		NONE	NIP/ GPS
AIRPORT REFERENCE CODE (ARC)		B-II	B-II
CRITICAL AIRCRAFT APPROACH SPEED (KNOTS)		BEECH KING AIR B-200 103	FALCON 20 107
WINGSPAN		54.5'	63.5'
MAX. CERTIFIED TAKEOFF WEIGHT UNDERCARRIAGE WIDTH		12,500 lbs. 12' 9"	28,660 lbs. 14' 7"
RUNWAY SAFETY AREA: WIDTH LENGTH BEYOND WY ENDS		150' 300'	150' 300'
RUNWAY OBJECT FREE AREA: WIDTH LENGTH BEYOND WY ENDS		500' 300'	"SAME" "SAME"
RUNWAY/ TAXIWAY SEPARATION		250'	250'
OBSTACLE FREE ZONE: WIDTH LENGTH BEYOND WY ENDS		400' 200'	400' 200'
NO OZ OBJECT PENETRATIONS			
RUNWAY ELEVATIONS (AVID 88)(MSL)		TRW 5 5,687.6'	TRW 23 5,622.3'
RUNWAY END TOUCHDOWN ZONE HIGH POINT LOW POINT		5,687.6' 5,622.3'	5,687.6' 5,651.4' 5,622.3'
DISTANCE FROM WY CL TO HOLD BARS AND SIGNS		200'	200'
WIND COVERAGE/ 10.5 kt- 12 mph. 13 kt- 15 mph.		94.9% 100 %	94.9% 100 %
RUNWAY CL TO TAXIWAY CL		240'	240'
TAXIWAY CL TO FIXED OBJECT TAXIWAY OFA WIDTH TAXIWAY SAFETY AREA WIDTH		65.5' 131' 79'	65.5' 131' 79'
TAXIWAY LIGHTING		MILT	MILT
TAXIWAY MARKING		CENTERLINE	CENTERLINE
TAXIWAY SURFACE TYPE		ASPHALT	ASPHALT

AIRPORT DATA		
AIRPORT NAME	KAYENTA AIRPORT	
AIRPORT IDENTIFIER	O7V	
COUNTY/ STATE	NAVAJO COUNTY ARIZONA	
TOWNSHIP/ RANGE	T 38 N, R 19E & R 20 E	
	EXISTING	FUTURE
AIRPORT ELEVATION (AVID 88)(MSL)	5,688'	5,688'
AIRPORT REFERENCE POINT (AP) COORDINATES (NAND 83)	LAT 36°42'59.231" N LONG 110°13'42.411" W	LAT 36°42'59.231" N LONG 110°13'42.411" W
MEAN MAX. TEMP: HOTTEST MONTH (JULY)	90°	90°
AIRPORT REFERENCE CODE	B-II	B-II
PICAS ROLE	GA	"SAME"
MAGNETIC VARIATION	8.55°	TBD
WINGTIP CLEARANCE	26'	
AIRPORT & TERMINAL AVOIDS	N/A	GPS

AIRPORT FACILITIES LIST	
BUILDING	BUILDING
STRUCTURE	TOP ELEV.
① TERMINAL	5,710'
② AUTOMOBILE PARKING	---
③ MAINTENANCE HANGAR	5,710'
④ BOX HANGARS	5,650' / 5,670'
⑤ AIRCRAFT TIE DOWNS	---
⑥ T-HANGARS	5,655'
⑦ SLURRY TANKS	5,660'
⑧ SRE BUILDING	---
⑨ HELIPADS	---
⑩ FUEL TANKS	---
⑪ MOTORCOACH PARKING	---

(e) Existing/ (f) Future

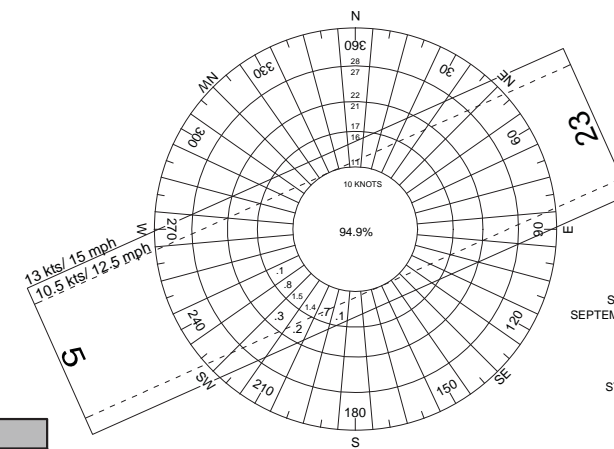

SOURCE: BUCKSKIN LO ARIZONA CROWS
SEPTEMBER 2002 - JULY 2004 (16,776 OBSERVATIONS)
24 OBSERVATIONS/ DAY
NOTE: AIRPORT SHOULD CONTINUE TO
COLLECT WIND DATA UNTIL THE FAA
WINDROWS REQUIREMENTS ARE MET.
STATION LOCATION IS 31 NAUTICAL MILES
SOUTHWEST OF THE AIRPORT.

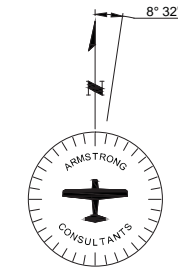

MAGNETIC NORTH SOURCE:
INTERPEX/GEOMAGIX 3.09.05
EPOCH YEAR 2005 (U.S. 2005 MODEL)
RATE OF CHANGE -1.91 min./yr.



WIND COVERAGE DATA			
RUNWAY	10.5 kt/ 12 mph	13 kt/ 15 mph	16 kt/ 20 mph
5/23 (E)	94.9%	100%	100%

- NOTES**
- NO THRESHOLD SITING SURFACE PENETRATIONS
 - BASE MAPPING PROVIDED BY KAYENTA TOWNSHIP.
 - CONTOUR ELEVATIONS TAKEN FROM U.S.G.S. DEM
 - HORIZONTAL COORDINATES: NAND 83
VERTICAL COORDINATES: AVID 88
 - PACS & SACS PROTECTED WITH AN ALUMINUM CAP

RUNWAY END COORDINATES (NAND 83)		
RUNWAY END	LATITUDE	LONGITUDE
5 (E)	36°42'44.880" N	110°14'22.205" W
23 (E)	36°43'13.578" N	110°13'02.612" W

RUNWAY END COORDINATES ARE NOT SURVEYED.
COORDINATES ARE BASED ON THE PAC'S AND SAC'S SURVEY CONTROL.

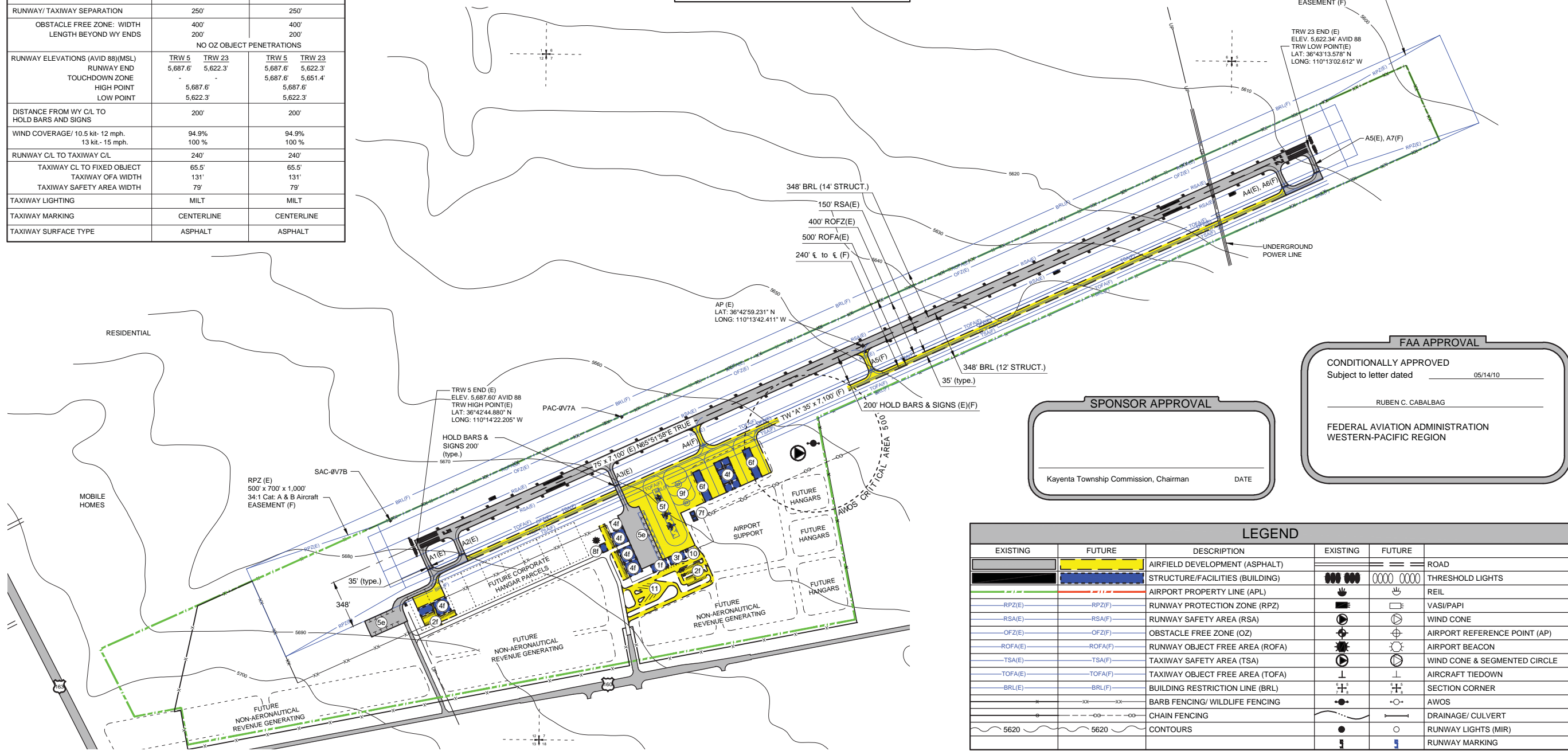

SPONSOR APPROVAL

Kayenta Township Commission, Chairman DATE

FAA APPROVAL

CONDITIONALLY APPROVED
Subject to letter dated 05/14/10

RUBEN C. CABALBAG

FEDERAL AVIATION ADMINISTRATION
WESTERN-PACIFIC REGION

LEGEND					
EXISTING	FUTURE	DESCRIPTION	EXISTING	FUTURE	DESCRIPTION
[Symbol]	[Symbol]	AIRFIELD DEVELOPMENT (ASPHALT)	[Symbol]	[Symbol]	ROAD
[Symbol]	[Symbol]	STRUCTURE/FACILITIES (BUILDING)	[Symbol]	[Symbol]	THRESHOLD LIGHTS
[Symbol]	[Symbol]	AIRPORT PROPERTY LINE (APL)	[Symbol]	[Symbol]	REIL
[Symbol]	[Symbol]	RUNWAY PROTECTION ZONE (RPZ)	[Symbol]	[Symbol]	VAS/PAPI
[Symbol]	[Symbol]	RUNWAY SAFETY AREA (RSA)	[Symbol]	[Symbol]	WIND CONE
[Symbol]	[Symbol]	OBSTACLE FREE ZONE (OZ)	[Symbol]	[Symbol]	AIRPORT REFERENCE POINT (AP)
[Symbol]	[Symbol]	RUNWAY OBJECT FREE AREA (ROFA)	[Symbol]	[Symbol]	AIRPORT BEACON
[Symbol]	[Symbol]	TAXIWAY SAFETY AREA (TSA)	[Symbol]	[Symbol]	WIND CONE & SEGMENTED CIRCLE
[Symbol]	[Symbol]	TAXIWAY OBJECT FREE AREA (TOFA)	[Symbol]	[Symbol]	AIRCRAFT TIEDOWN
[Symbol]	[Symbol]	BUILDING RESTRICTION LINE (BRL)	[Symbol]	[Symbol]	SECTION CORNER
[Symbol]	[Symbol]	BARB FENCING/ WILDLIFE FENCING	[Symbol]	[Symbol]	AWOS
[Symbol]	[Symbol]	CHAIN FENCING	[Symbol]	[Symbol]	DRAINAGE/ CULVERT
[Symbol]	[Symbol]	CONTOURS	[Symbol]	[Symbol]	RUNWAY LIGHTS (MIR)
[Symbol]	[Symbol]		[Symbol]	[Symbol]	RUNWAY MARKING

ARMSTRONG CONSULTANTS, Inc.
airport engineering and planning services

861 Rood Avenue
Grand Junction, CO 81501
ph: 970.242.0101 fax: 970.241.1769

KAYENTA AIRPORT
KAYENTA, ARIZONA

AIRPORT LAYOUT PLANS

No.	Revision	Date	By
1	LAST ALP 2007 BY CARTER ASSOCIATES		
2	MASTER PLAN/ALP (045702)	2006	
3	ALP UPDATE (ACI 055736)	7/09	LKB

Project No: 055736
Date: 07/2009
File Name: 5736502

Drawn: RFD
Checked: ZAP
Approved: DA

AIRPORT LAYOUT PLAN