

- NOTES**
- ALL LATITUDE/LONGITUDE COORDINATES SHOWN ARE 1983 NORTH AMERICAN DATUM (NAD 83).
 - THE NAVAJO NATION SHOULD ENCOURAGE COMPATIBLE LAND USE FOR POTENTIAL AVIATION PURPOSES ON PROPERTY NOT CURRENTLY OWNED OR CONTROLLED BY THE NAVAJO NATION.
 - ALL FUTURE ELECTRICAL WILL BE UNDERGROUND.

SPONSOR APPROVAL

This Airport Layout Plan (ALP) drawing set was prepared in accordance with FAA Advisory Circular 150/5070-6, Airport Master Plans, and identifies the current conditions and future needs of the Chinle Municipal Airport as identified during the development of the ALP set which was finalized in September 2015.

Russell Begaye 12/29/15
 Mr. Russell Begaye, President
 THE NAVAJO NATION

FAA APPROVAL

Approved conditionally *January 15, 2016*
 Subject to comments contained in our letter dated *1-15-2016*

FEDERAL AVIATION ADMINISTRATION
 Western-Pacific Region
 By *M. W. W.*
 Manager / Assistant Manager - Phoenix/ADJ

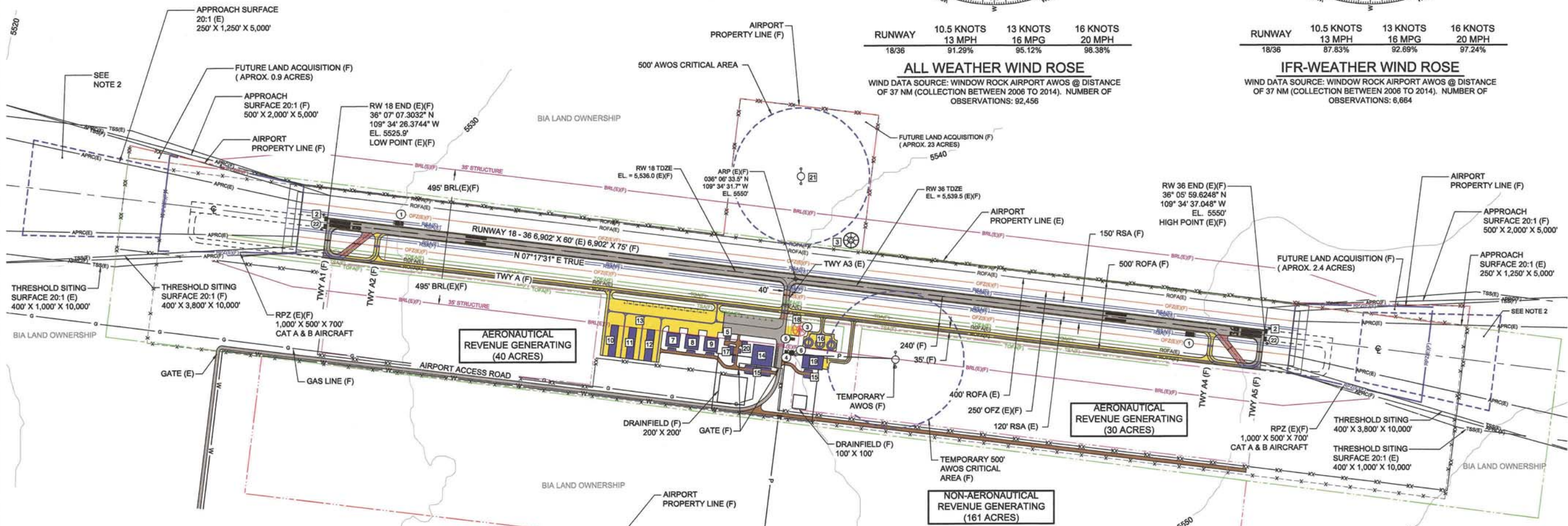
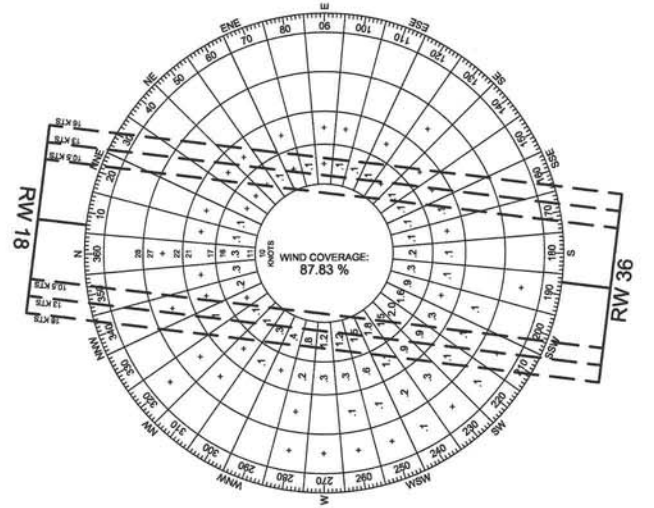
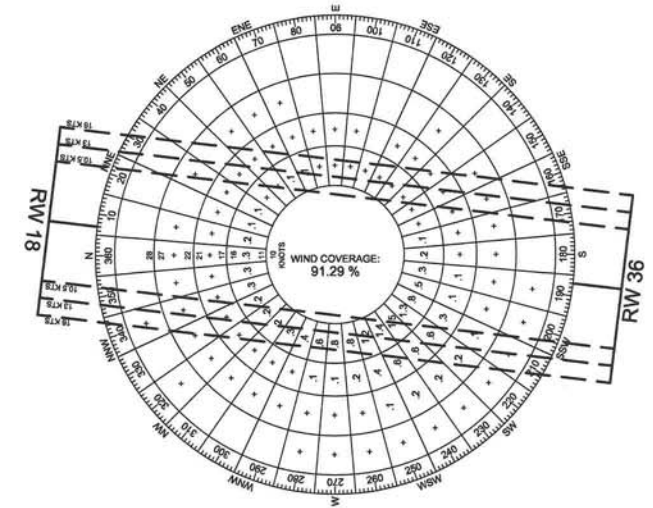

ALL WEATHER WIND ROSE
 WIND DATA SOURCE: WINDOW ROCK AIRPORT AWOS @ DISTANCE OF 37 NM (COLLECTION BETWEEN 2006 TO 2014). NUMBER OF OBSERVATIONS: 92,456

WIND DIRECTION	10.5 KNOTS	13 KNOTS	16 KNOTS
18/36	91.29%	95.12%	98.38%

IFR-WEATHER WIND ROSE
 WIND DATA SOURCE: WINDOW ROCK AIRPORT AWOS @ DISTANCE OF 37 NM (COLLECTION BETWEEN 2006 TO 2014). NUMBER OF OBSERVATIONS: 6,664

WIND DIRECTION	10.5 KNOTS	13 KNOTS	16 KNOTS
18/36	87.83%	92.69%	97.24%

AIRPORT FACILITIES LIST

NO.	EXIST.	FUT.	FACILITY DESCRIPTION	TOP ELEVATION (MSL)
1	○		PAPI	N/A
2		□	REIL	N/A
3	○	□	LIGHTED WINDCONE/CIRCLE	+/- 5560
4	○		ELECTRICAL VAULT	+/- 5548
5	○		FUEL FACILITY	+/- 5546
6	○		BEACON	+/- 5570
7		□	HANGAR	+/- 5577
8		□	HANGAR	+/- 5577
9		□	HANGAR	+/- 5577
10		□	T-HANGAR	+/- 5565
11		□	T-HANGAR	+/- 5565
12		□	T-HANGAR	+/- 5565
13		□	APRON	+/- 5535
14		□	TERMINAL	+/- 5568
15		□	AUTO PARKING	N/A
16		□	HELO PARKING	+/- 5541
17		□	MAINTENANCE BUILDING	+/- 5568
18		□	WASH RACK	+/- 5542
19		□	OPERATIONS BUILDING	+/- 5568
20		□	SRE BUILDING	+/- 5568
21		□	ASOS	+/- 5540
22	○		MIRL / THRESHOLD LIGHTS	N/A

LEGEND

EXISTING	FUTURE	DESCRIPTION	EXISTING	FUTURE	DESCRIPTION
—	—	AIRFIELD DEVELOPMENT (ASPH/CONC)	●●●●	N/A	MIRL/THRESHOLD LIGHTS
—	—	STRUCTURE/FACILITIES (BUILDING)	■	N/A	REIL
—	—	AIRPORT PROPERTY LINE (APL)	—	N/A	VASI/PAPI
—	—	RUNWAY SAFETY AREA (RSA)	—	N/A	AIRPORT BEACON
—	—	OBSTACLE FREE ZONE (OFZ)	—	N/A	WIND CONE & SEGMENTED CIRCLE
—	—	RUNWAY OBJECT FREE AREA (ROFA)	—	N/A	AWOS
—	—	BUILDING RESTRICTION LINE (BRL)	—	N/A	CONTOURS
—	—	TAXIWAY SAFETY AREA (TSA)	—	N/A	ROADS
—	—	TAXIWAY OBJECT FREE AREA (TOFA)	—	N/A	MARKINGS
—	—	APPROACH SURFACE (APRC)	X	XX	FENCING
—	—	THRESHOLD SITING SURFACE (TSS)	—	N/A	NATURAL GAS MAIN
—	—	AIRPORT REFERENCE POINT (ARP)	W	N/A	WATER MAIN
—	—	TO BE REMOVED (RED SYMBOL)	P	N/A	POWER LINE
—	—	DRAINAGE WASH	—	N/A	LAND USE LINE

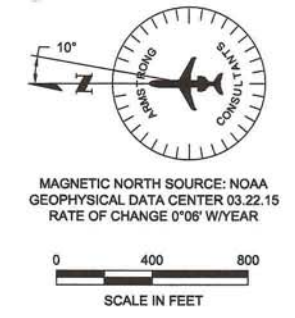

CHINLE MUNICIPAL AIRPORT
 CHINLE, ARIZONA

A.I.P. NO. 3-04-D303-01-11-2014
 AIRPORT LAYOUT PLAN

No.	Project No.	Date	Revision / Description	File	Drwn.	Chkd.	Apprvd.
0	148214	05/20/15	ORIGINAL ISSUE	-EPI	LDS	CM	JJP
1							
2							
3							

AIRPORT LAYOUT PLAN